

2007 FUNCTIONAL CLASSIFICATION

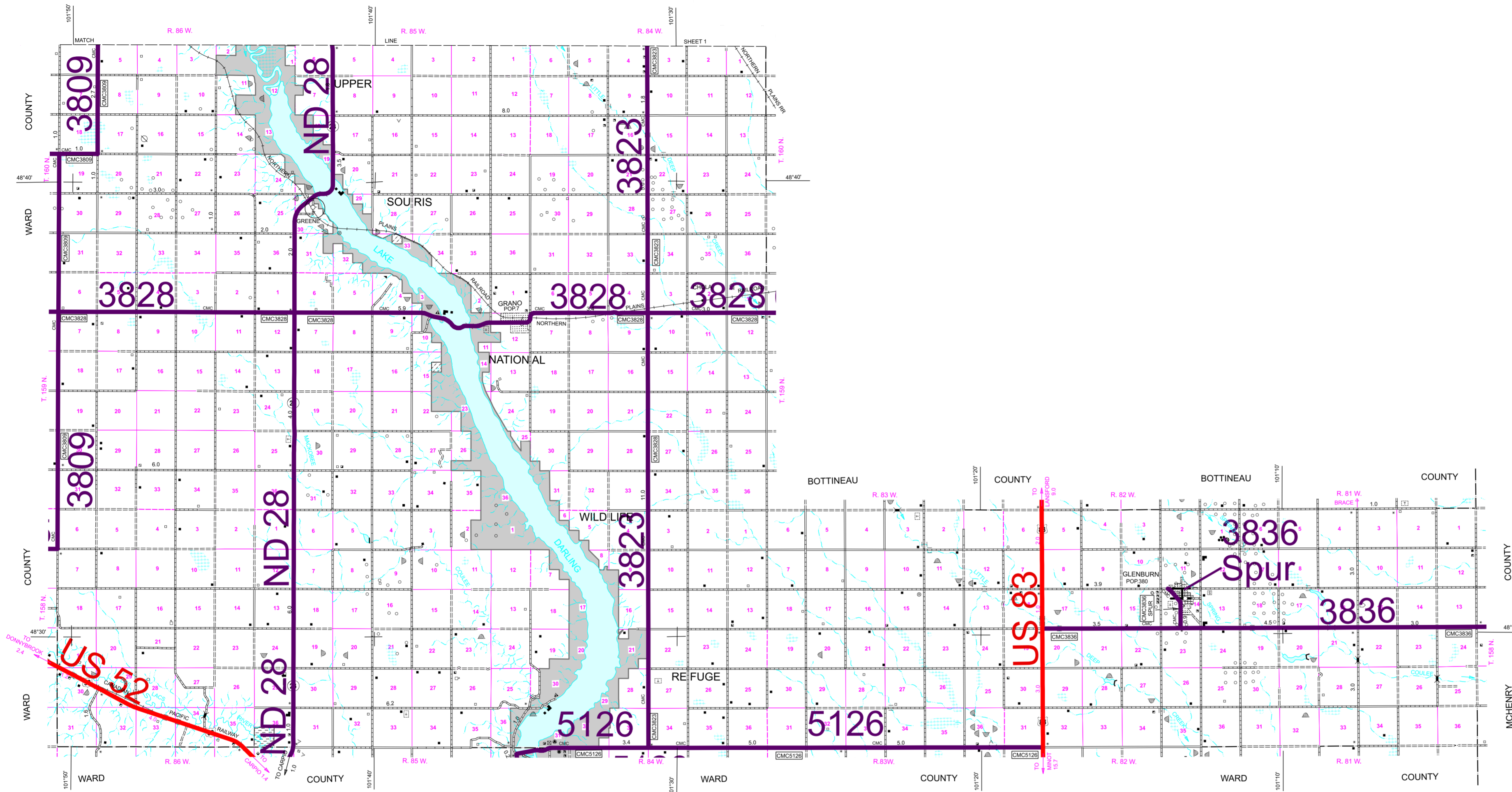

- NAME AND LOCATION OF ORGANIZED CIVIL TOWNSHIPS THOSE UNORGANIZED ARE SO NOTED
- T. 164 N.-R. 87 W. STAFFORD
 - T. 164 N.-R. 86 W. PROSPERITY
 - T. 164 N.-R. 85 W. COLOQUHOUN
 - T. 164 N.-R. 84 W. EDEN VALLEY
 - T. 163 N.-R. 87 W. STAFFORD
 - T. 163 N.-R. 86 W. PROSPERITY
 - T. 163 N.-R. 85 W. COLOQUHOUN
 - T. 163 N.-R. 84 W. EDEN VALLEY
 - T. 162 N.-R. 87 W. ROCKFORD
 - T. 162 N.-R. 86 W. GROVER
 - T. 162 N.-R. 85 W. HAMERLY
 - T. 162 N.-R. 84 W. HURLEY
 - T. 161 N.-R. 87 W. FAIRBANKS
 - T. 161 N.-R. 86 W. MC KINNEY
 - T. 161 N.-R. 85 W. HAMLET
 - T. 161 N.-R. 84 W. BRANDON
 - T. 160 N.-R. 86 W. ROOSEVELT
 - T. 160 N.-R. 85 W. GRASSLAND
 - T. 160 N.-R. 84 W. CLAY
 - T. 159 N.-R. 86 W. IVANHOE
 - T. 159 N.-R. 85 W. CALLAHAN
 - T. 159 N.-R. 84 W. LOCKWOOD
 - T. 158 N.-R. 86 W. WHITE ASH
 - T. 158 N.-R. 85 W. PLAIN
 - T. 158 N.-R. 84 W. MUSKEGO
 - T. 158 N.-R. 83 W. VAN BUREN
 - T. 158 N.-R. 82 W. ENSIGN
 - T. 158 N.-R. 81 W. PRESCOTT

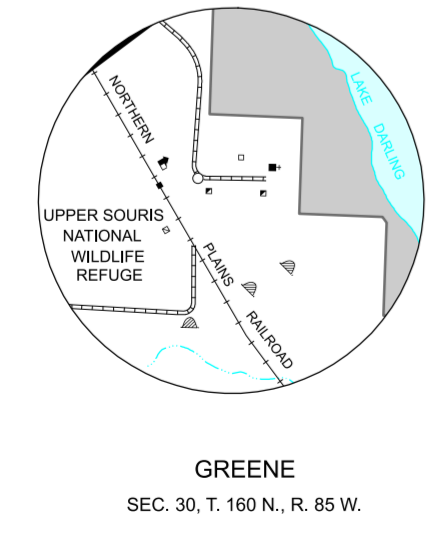
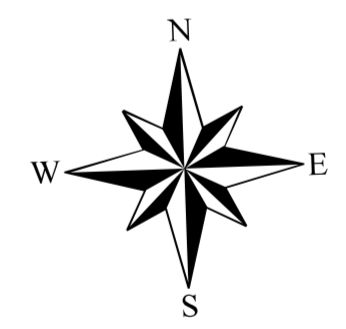

LEGEND

- INTERSTATE
- PRINCIPAL ARTERIAL
- MINOR ARTERIAL
- MAJOR COLLECTOR

REVISION DATE AND CHANGE

12-05-1995 Moved 13.0 miles from CMC3838 to CMC5126 per agreement

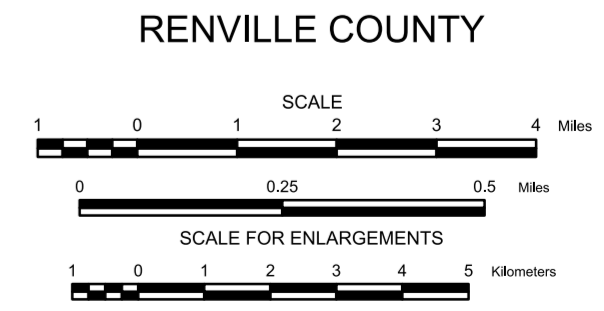
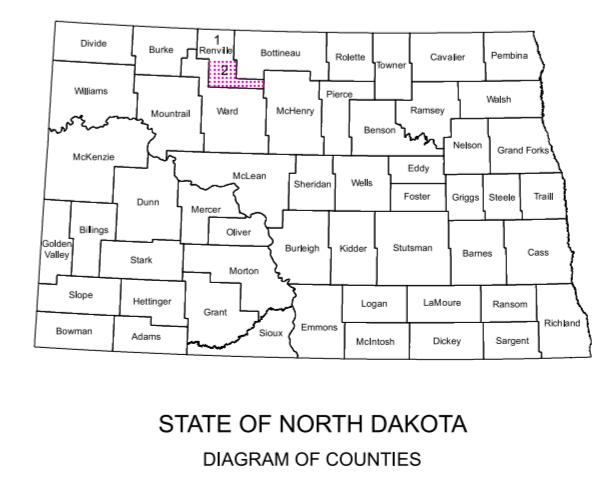

Notice of Disclaimer
 The North Dakota Department of Transportation (NDDOT) makes this map available on an "as is" basis as a public service. Under no circumstances does NDDOT warrant or certify the information to be free of errors or deficiencies of any kind. NDDOT specifically disclaims all warranties, express or implied, including but not limited to the warranties of merchantability and fitness for a particular purpose. COPIES OF THIS MAP ARE AVAILABLE FOR PUBLIC USE AT A NOMINAL COST FROM: MAP SALES, N.D. DEPT. OF TRANSPORTATION, 608 E. BLVD. AVE., BISMARCK, ND 58505-0700

BASED ON AERIAL PHOTOGRAPHY OF 1954
 GROUND INVENTORY OF 2009
 AERIAL INVENTORY OF 2009

UNIVERSAL TRANSVERSE MERCATOR ZONE 14
 NORTH AMERICAN DATUM 83