

2007 FUNCTIONAL CLASSIFICATION

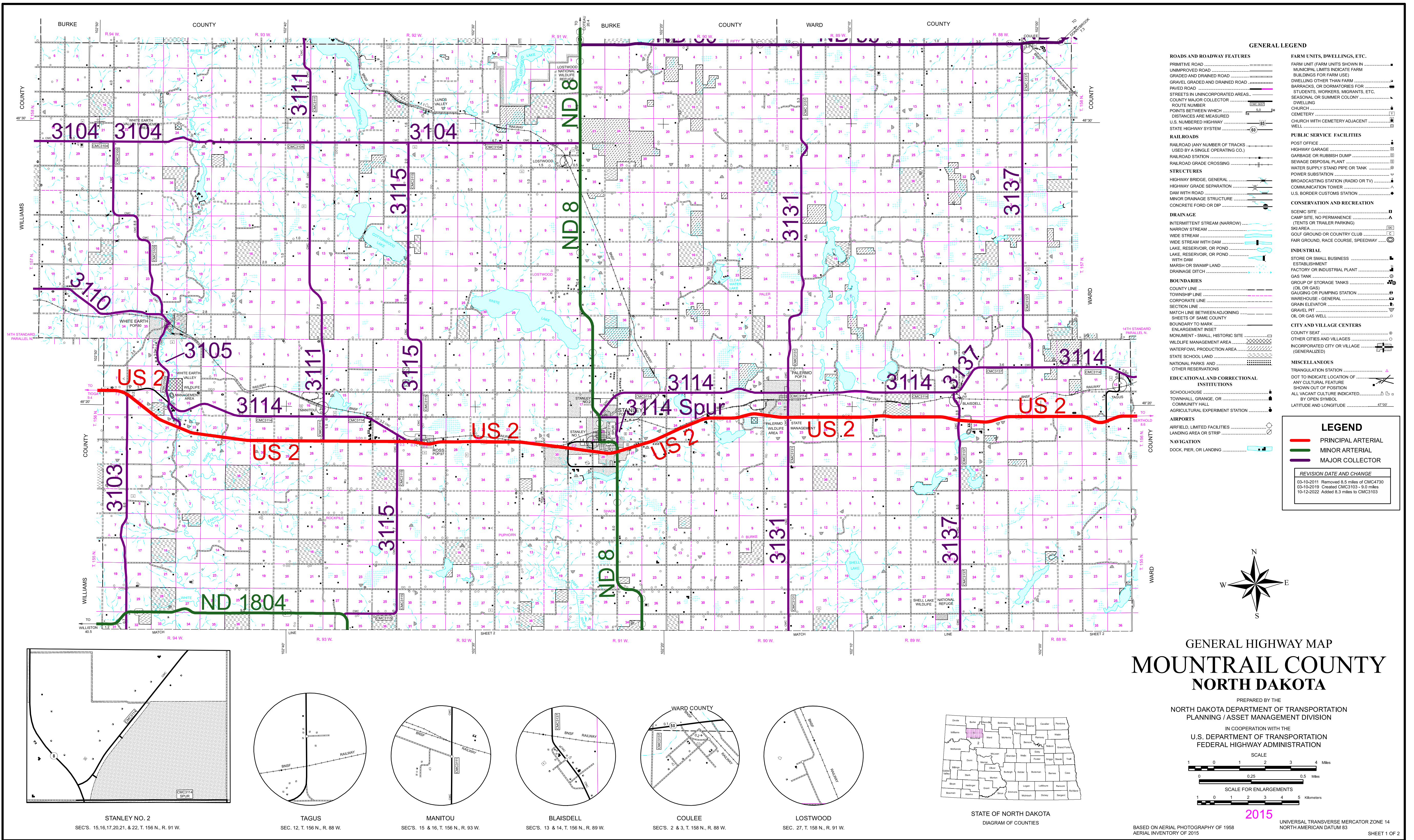

GENERAL LEGEND

ROADS AND ROADWAY FEATURES	FARM UNITS, DWELLINGS, ETC.
PRIMITIVE ROAD	FARM UNIT (FARM UNITS SHOWN IN
UNIMPROVED ROAD	MUNICIPAL LIMITS INDICATE FARM
GRAVEL GRADED AND DRAINED ROAD	BUILDINGS FOR FARM USE
GRAVEL GRADED ROAD	DWELLINGS OTHER THAN FARM
PAVED ROAD	BARRACKS, OR DORMATORIES FOR
STREETS IN UNINCORPORATED AREAS	STUDENTS, WORKERS, MIGRANTS, ETC.
COUNTY MAJOR COLLECTOR	SEASONAL OR SUMMER COLONY
ROUTE NUMBER	DWELLING
POINTS BETWEEN WHICH	CHURCH
DISTANCES ARE MEASURED	CEMETERY
U.S. NUMBERED HIGHWAY	CEMETERY WITH CEMETERY ADJACENT
STATE HIGHWAY SYSTEM	WELL
RAILROADS	PUBLIC SERVICE FACILITIES
RAILROAD (ANY NUMBER OF TRACKS	POST OFFICE
USED BY A SINGLE OPERATING CO.)	HIGHWAY GARAGE
RAILROAD STATION	GARAGE OR RUBBISH DUMP
RAILROAD GRADE CROSSING	SEWAGE DISPOSAL PLANT
STRUCTURES	WATER SUPPLY STAND PIPE OR TANK
HIGHWAY BRIDGE, GENERAL	POWER SUBSTATION
HIGHWAY GRADE SEPARATION	BROADCASTING STATION (RADIO OR TV)
DAM WITH ROAD	COMMUNICATION TOWER
MINOR DRAINAGE STRUCTURE	U.S. BORDER CUSTOMS STATION
CONCRETE FORD OR DIP	CONSERVATION AND RECREATION
DRAINAGE	SCENIC SITE
INTERMITTENT STREAM (NARROW)	CAMP SITE, NO PERMANENCE
NARROW STREAM	(TENTS OR TRAILER PARKING)
WIDE STREAM	SKI AREA
WIDE STREAM WITH DAM	GOLF GROUND OR COUNTRY CLUB
LAKE, RESERVOIR, OR POND	FAIR GROUND, RACE COURSE, SPEEDWAY
LAKE, RESERVOIR, OR POND	INDUSTRIAL
WITH DAM	STORE OR SMALL BUSINESS
MARSH OR SWAMP LAND	ESTABLISHMENT
DRAINAGE DITCH	FACTORY OR INDUSTRIAL PLANT
BOUNDARIES	GAS TANK
COUNTY LINE	GROUP OF STORAGE TANKS
TOWNSHIP LINE	(OIL OR GAS)
CORPORATE LINE	GAUGING OR PUMPING STATION
SECTION LINE	WAREHOUSE - GENERAL
MATCH LINE BETWEEN ADJOINING	GRAIN ELEVATOR
SHEETS OF SAME COUNTY	GRAVEL PIT
BOUNDARY TO MARK	OIL OR GAS WELL
ENLARGEMENT INSET	CITY AND VILLAGE CENTERS
MONUMENT - SMALL, HISTORIC SITE	COUNTY SEAT
WILDLIFE MANAGEMENT AREA	OTHER CITIES AND VILLAGES
WATERFOWL PRODUCTION AREA	INCORPORATED CITY OR VILLAGE
STATE SCHOOL LAND	(GENERALIZED)
NATIONAL PARKS AND	MISCELLANEOUS
OTHER RESERVATIONS	TRANSLATION STATION
EDUCATIONAL AND CORRECTIONAL	DOT TO INDICATE LOCATION OF
INSTITUTIONS	ANY CULTURAL FEATURE
SCHOOLHOUSE	SHOWN OUT OF POSITION
TOWNHALL, GRANGE, OR	ALL VACANT CULTURE INDICATED
COMMUNITY HALL	BY OPEN SYMBOL
AGRICULTURAL EXPERIMENT STATION	LATITUDE AND LONGITUDE
AIRPORTS	
AIRFIELD, LIMITED FACILITIES	
LANDING AREA OR STRIP	
NAVIGATION	
DOCK, PIER, OR LANDING	

LEGEND

—	PRINCIPAL ARTERIAL
—	MINOR ARTERIAL
—	MAJOR COLLECTOR

REVISION DATE AND CHANGE

03-10-2011	Removed 8.5 miles of CMC4730
03-10-2019	Created CMC3103 - 8.0 miles
10-12-2022	Added 5.3 miles to CMC3103

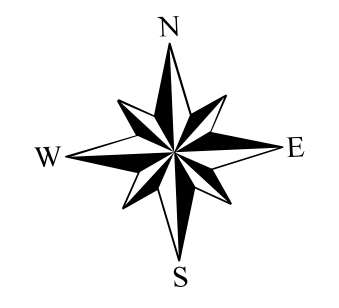

GENERAL HIGHWAY MAP MOUNTRAIL COUNTY NORTH DAKOTA

PREPARED BY THE
NORTH DAKOTA DEPARTMENT OF TRANSPORTATION
PLANNING / ASSET MANAGEMENT DIVISION

IN COOPERATION WITH THE
U.S. DEPARTMENT OF TRANSPORTATION
FEDERAL HIGHWAY ADMINISTRATION

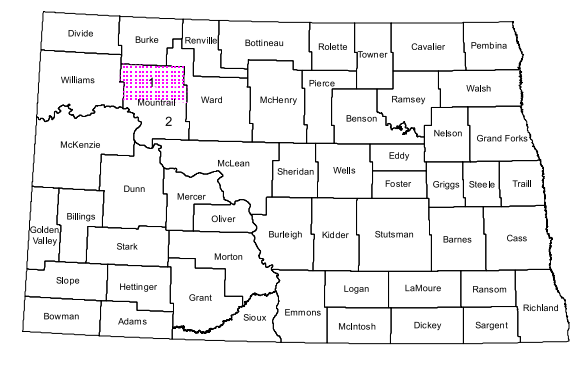
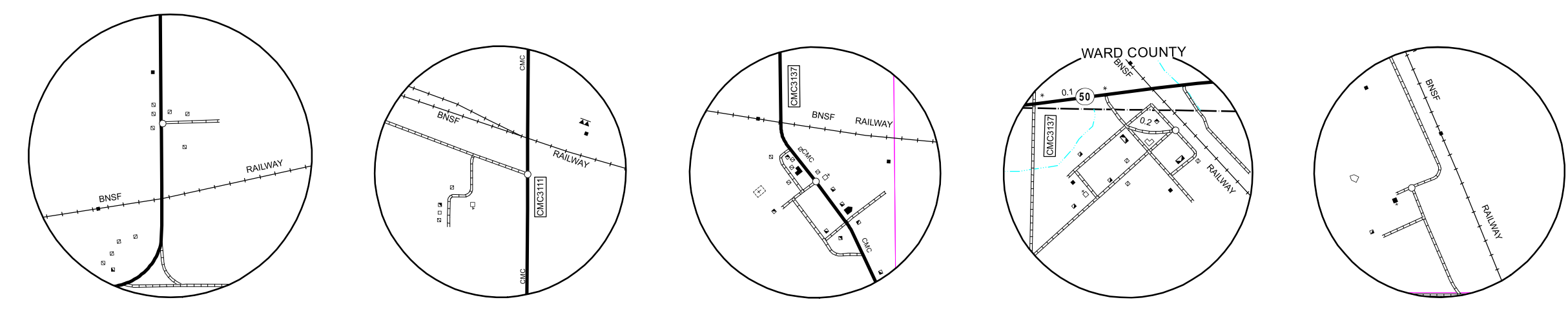
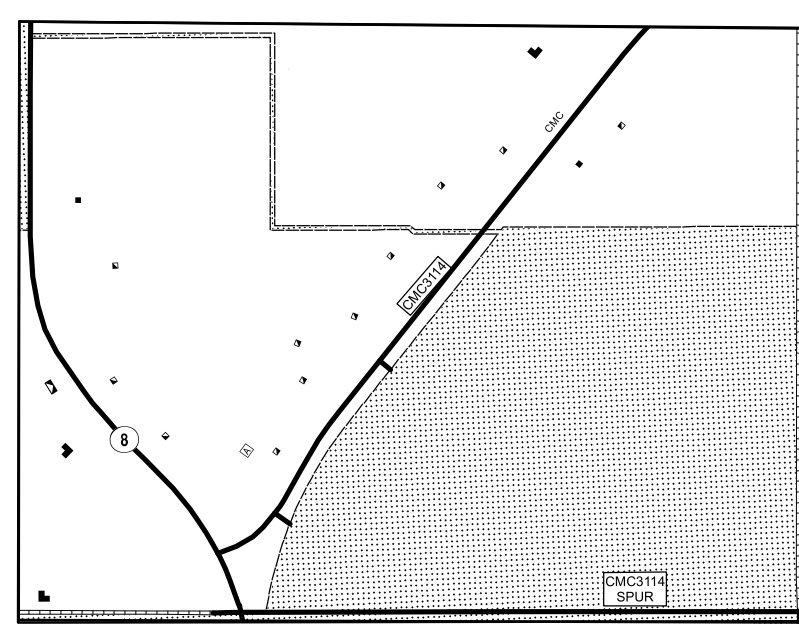
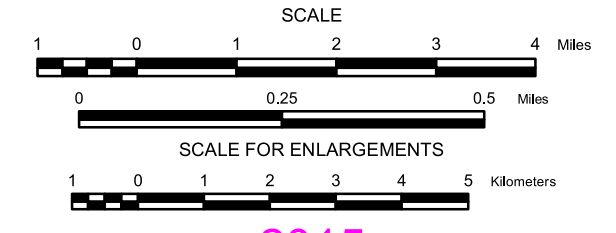

Notice of Disclaimer
The North Dakota Department of Transportation (NDDOT) makes this map available on an "as is" basis as a public service. Under no circumstances does NDDOT warrant or certify the information to be free of errors or deficiencies of any kind. NDDOT specifically disclaims all warranties, express or implied, including but not limited to the warranties of merchantability and fitness for a particular purpose. COPIES OF THIS MAP ARE AVAILABLE FOR PUBLIC USE AT A NOMINAL COST FROM: MAP SALES, N.D. DEPT. OF TRANSPORTATION, 608 E. BLVD. AVE., BISMARCK, ND 58505-0700