

2007 FUNCTIONAL CLASSIFICATION

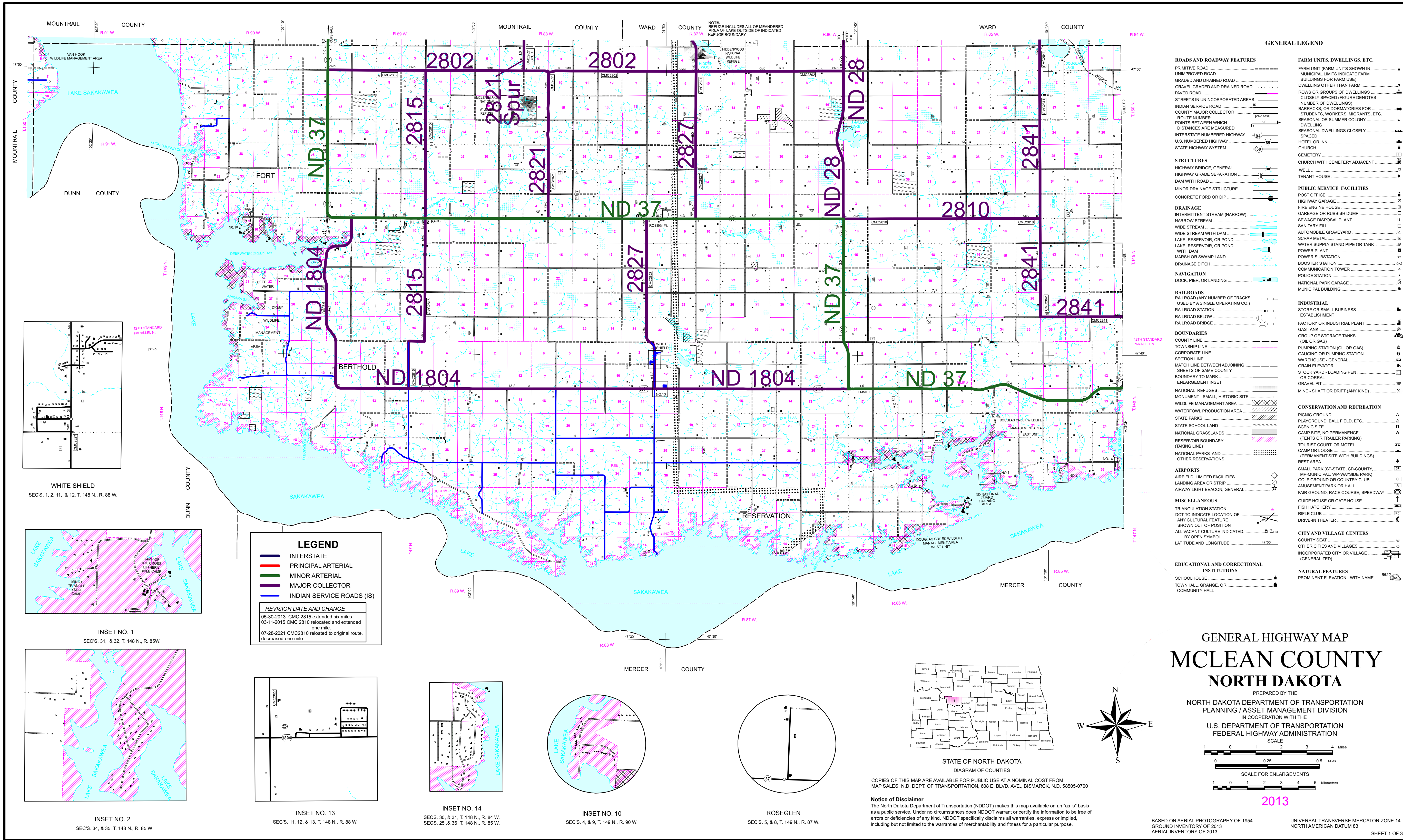

GENERAL LEGEND

ROADS AND ROADWAY FEATURES	FARM UNITS, DWELLINGS, ETC.
PRIMITIVE ROAD	FARM UNIT (FARM UNITS SHOWN IN MUNICIPAL LIMITS INDICATE FARM BUILDINGS FOR FARM USE)
UNIMPROVED ROAD	DWELLING OTHER THAN FARM
GRAVEL GRADED AND DRAINED ROAD	ROWS OR GROUPS OF DWELLINGS
PAVED ROAD	CLOSELY SPACED (FIGURE DENOTES NUMBER OF DWELLINGS)
STREETS IN UNINCORPORATED AREAS	BARRACKS, OR DORMATORIES FOR STUDENTS, WORKERS, MIGRANTS, ETC.
INDIAN SERVICE ROAD	SEASONAL OR SUMMER COLONY
COUNTY MAJOR COLLECTOR	DWELLING
ROUTE NUMBER	SPACED
POINTS BETWEEN WHICH DISTANCES ARE MEASURED	INTERSTATE DWELLINGS CLOSELY SPACED
INTERSTATE NUMBERED HIGHWAY	HOTEL OR INN
U.S. NUMBERED HIGHWAY	CHURCH
STATE HIGHWAY SYSTEM	CEMETERY
	CHURCH WITH CEMETERY ADJACENT
	WELL
	TENANT HOUSE
	PUBLIC SERVICE FACILITIES
	POST OFFICE
	HIGHWAY GARAGE
	FIRE ENGINE HOUSE
	GARBAGE OR RUBBISH DUMP
	SEWAGE DISPOSAL PLANT
	SANITARY FILL
	AUTOMOBILE GRAVEYARD
	SCRAP METAL
	WATER SUPPLY STAND PIPE OR TANK
	POWER PLANT
	POWER SUBSTATION
	BOOSTER STATION
	COMMUNICATION TOWER
	POLICE STATION
	NATIONAL PARK GARAGE
	MUNICIPAL BUILDING
	INDUSTRIAL
	STORE OR SMALL BUSINESS ESTABLISHMENT
	FACTORY OR INDUSTRIAL PLANT
	GAS TANK
	GROUP OF STORAGE TANKS (OIL OR GAS)
	PUMPING STATION (OIL OR GAS)
	GAUGING OR PUMPING STATION
	WAREHOUSE - GENERAL
	CRAN ELEVATOR
	STOCK YARD - LOADING PEN OR CORRAL
	GRAVEL PIT
	MINE - SHAFT OR DRIFT (ANY KIND)
	CONSERVATION AND RECREATION
	PICNIC GROUND
	PLAYGROUND, BALL FIELD, ETC.
	SCENIC SITE
	CAMP SITE, NO PERMANENCE (TENTS OR TRAILER PARKING)
	TOURIST COURT, OR MOTEL
	CAMP OR LODGE (PERMANENT SITE WITH BUILDINGS)
	REST AREA
	SMALL PARK (SP-STATE, CR-COUNTY, MP-MUNICIPAL, WP-WAYSIDE PARK)
	GOLF GROUND OR COUNTRY CLUB
	MANAGEMENT PARK OR HALL
	FAIR GROUND, RACE COURSE, SPEEDWAY
	GUIDE HOUSE OR GATE HOUSE
	FISH HATCHERY
	RIFLE CLUB
	DRIVE-IN THEATER
	CITY AND VILLAGE CENTERS
	COUNTY SEAT
	OTHER CITIES AND VILLAGES
	INCORPORATED CITY OR VILLAGE (GENERALIZED)
	NATURAL FEATURES
	PROMINENT ELEVATION - WITH NAME

LEGEND

- INTERSTATE
- PRINCIPAL ARTERIAL
- MINOR ARTERIAL
- MAJOR COLLECTOR
- INDIAN SERVICE ROADS (IS)

REVISION DATE AND CHANGE

05-30-2013	CMC 2815 extended six miles
03-11-2015	CMC 2810 relocated and extended one mile
07-28-2021	CMC 2810 relocated to original route, decreased one mile

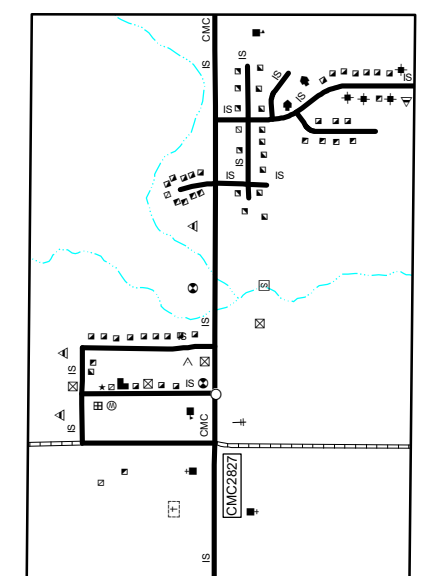

WHITE SHIELD
SECS. 1, 2, 11, & 12, T. 148 N., R. 88 W.

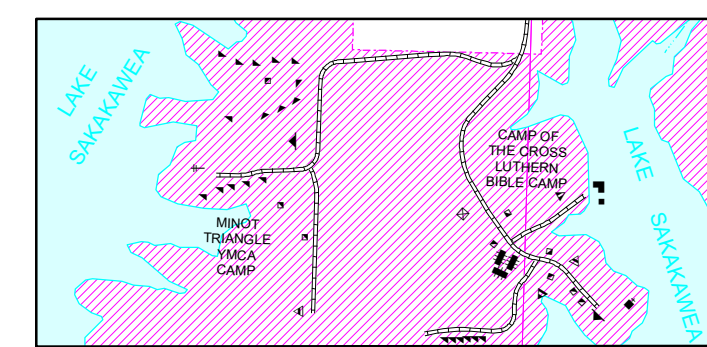

INSET NO. 1
SECS. 31, & 32, T. 148 N., R. 85W.

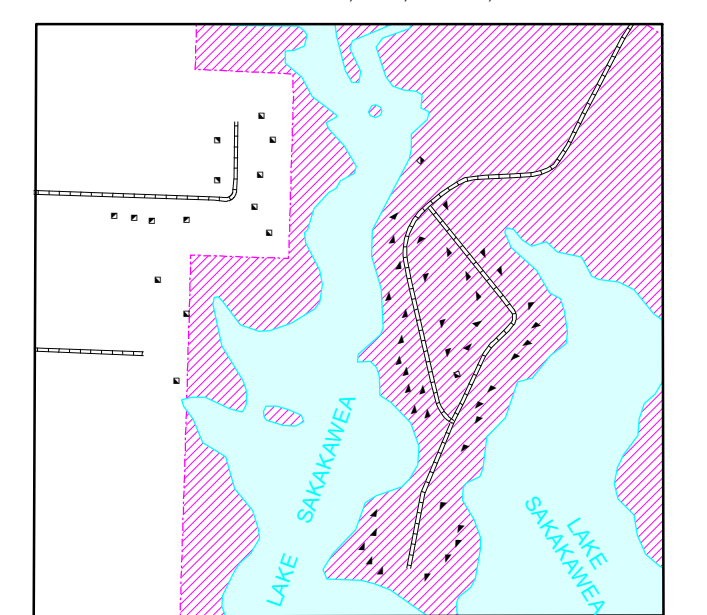

INSET NO. 2
SECS. 34, & 35, T. 148 N., R. 85 W.

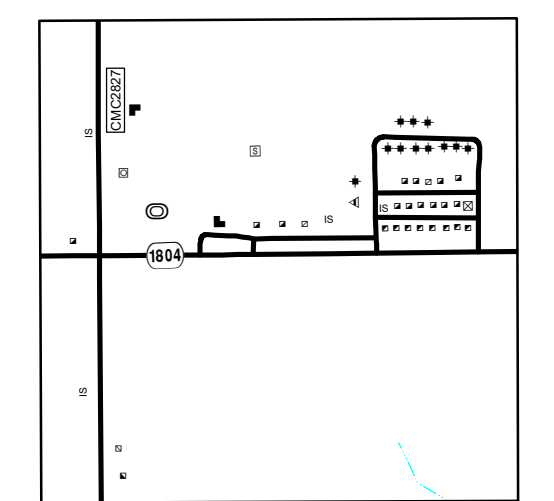

INSET NO. 13
SECS. 11, 12, & 13, T. 148 N., R. 88 W.

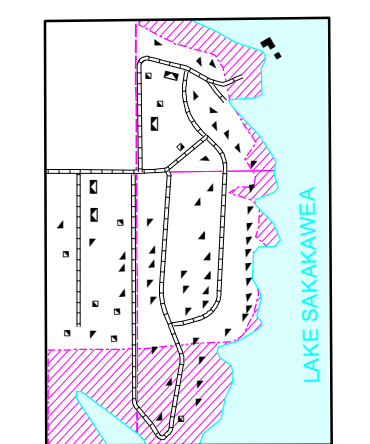

INSET NO. 14
SECS. 30, & 31, T. 148 N., R. 84 W.
SECS. 25, & 36 T. 148 N., R. 85 W.

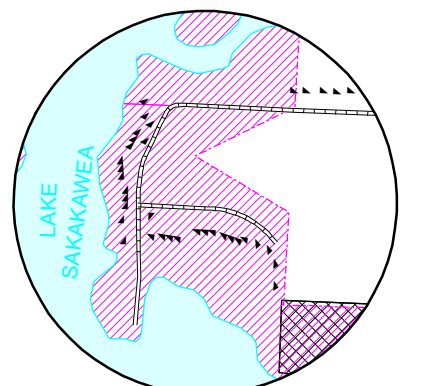

INSET NO. 10
SECS. 4, & 9, T. 149 N., R. 90 W.

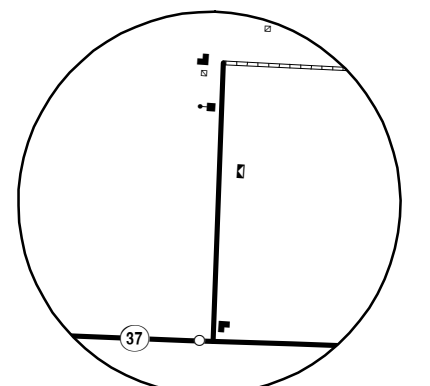

ROSEGLENN
SECS. 5, & 8, T. 149 N., R. 87 W.

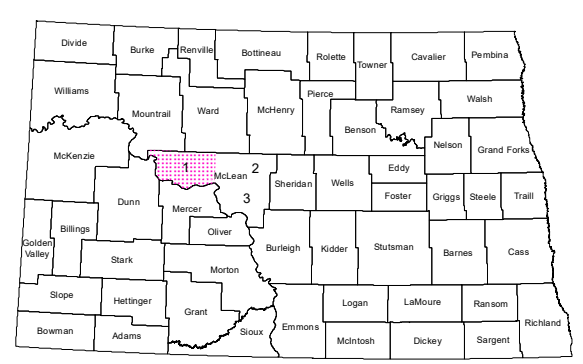

STATE OF NORTH DAKOTA
DIAGRAM OF COUNTIES

COPIES OF THIS MAP ARE AVAILABLE FOR PUBLIC USE AT A NOMINAL COST FROM:
MAP SALES, N.D. DEPT. OF TRANSPORTATION, 608 E. BLVD. AVE., BISMARCK, N.D. 58505-0700

Notice of Disclaimer
The North Dakota Department of Transportation (NDDOT) makes this map available on an "as is" basis as a public service. Under no circumstances does NDDOT warrant or certify the information to be free of errors or deficiencies of any kind. NDDOT specifically disclaims all warranties, express or implied, including but not limited to the warranties of merchantability and fitness for a particular purpose.

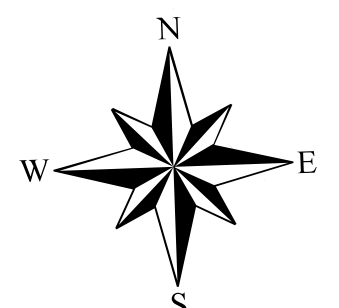

GENERAL HIGHWAY MAP MCLEAN COUNTY NORTH DAKOTA

PREPARED BY THE
NORTH DAKOTA DEPARTMENT OF TRANSPORTATION
PLANNING / ASSET MANAGEMENT DIVISION
IN COOPERATION WITH THE
U.S. DEPARTMENT OF TRANSPORTATION
FEDERAL HIGHWAY ADMINISTRATION

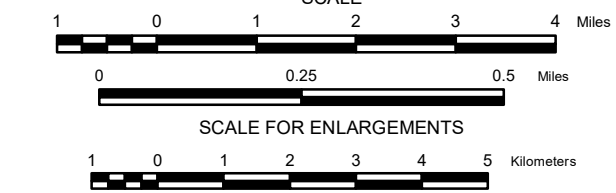

2013

BASED ON AERIAL PHOTOGRAPHY OF 1954
GROUND INVENTORY OF 2013
AERIAL INVENTORY OF 2013

UNIVERSAL TRANSVERSE MERCATOR ZONE 14
NORTH AMERICAN DATUM 83

SHEET 1 OF 3