

No Gravel

State Owned

2007 FUNCTIONAL CLASSIFICATION

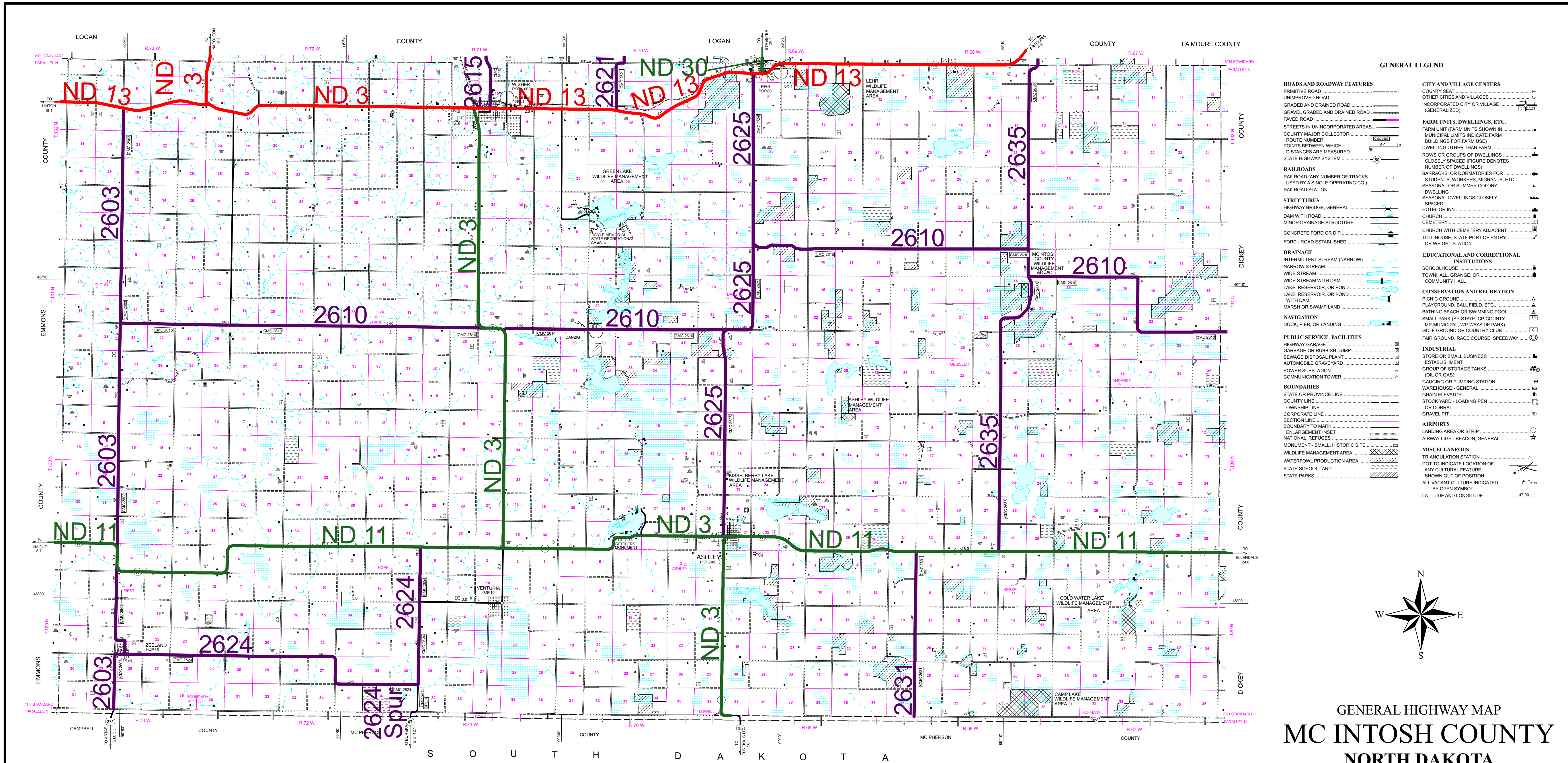

GENERAL LEGEND

- ROADS AND ROADWAY FEATURES**
 - PRIMITIVE ROAD
 - UNIMPROVED ROAD
 - GRADED AND DRAINED ROAD
 - GRAVEL GRADED AND DRAINED ROAD
 - PAVED ROAD
 - STREETS IN UNINCORPORATED AREAS
 - COUNTY MAJOR COLLECTOR
 - ROUTE NUMBER
 - POINTS BETWEEN WHICH DISTANCES ARE MEASURED
 - STATE HIGHWAY SYSTEM
- RAILROADS**
 - RAILROAD (ANY NUMBER OF TRACKS)
 - MINOR DRAINAGE STRUCTURE
 - CONCRETE FORD OR DIP
 - FORD - ROAD ESTABLISHED
- STRUCTURES**
 - HIGHWAY BRIDGE, GENERAL
 - SPICED
 - DAM WITH ROAD
 - CHURCH
 - CEMETERY
 - CHURCH WITH CEMETERY ADJACENT
 - TOLL HOUSE, STATE PORT OF ENTRY, OR WEIGHT STATION
- DRAINAGE**
 - INTERMITTENT STREAM (NARROW)
 - NARROW STREAM
 - WIDE STREAM
 - WIDE STREAM WITH DAM
 - LAKE, RESERVOIR, OR POND
 - LAKE, RESERVOIR, OR POND WITH DAM
 - MARSH OR SWAMP LAND
- NAVIGATION**
 - DOCK, PIER, OR LANDING
- PUBLIC SERVICE FACILITIES**
 - HIGHWAY GARAGE
 - GARBAGE OR RUBBISH DUMP
 - SEWAGE DISPOSAL PLANT
 - AUTOMOBILE GRAVEYARD
 - POWER SUBSTATION
 - COMMUNICATION TOWER
- BOUNDARIES**
 - STATE OR PROVINCE LINE
 - COUNTY LINE
 - TOWNSHIP LINE
 - CORPORATE LINE
 - SECTION LINE
 - BOUNDARY TO MARK ENLARGEMENT INSET
 - NATIONAL REFUGES
 - MONUMENT - SMALL, HISTORIC SITE
 - WILDLIFE MANAGEMENT AREA
 - WATERFOWL PRODUCTION AREA
 - STATE SCHOOL LAND
 - STATE PARKS
- CITY AND VILLAGE CENTERS**
 - COUNTY SEAT
 - OTHER CITIES AND VILLAGES
 - INCORPORATED CITY OR VILLAGE (GENERALIZED)
- FARM UNITS, DWELLINGS, ETC.**
 - FARM UNIT (FARM UNITS SHOWN IN MUNICIPAL LIMITS INDICATE FARM BUILDINGS FOR FARM USE)
 - DWELLING OTHER THAN FARM
 - ROWS OR GROUPS OF DWELLINGS
 - CLOSELY SPACED FIGURE DENOTES NUMBER OF DWELLINGS
 - BARRACKS, OR DORMATORIES FOR STUDENTS, WORKERS, MIGRANTS, ETC.
 - SEASONAL OR SUMMER COLONY
 - DWELLING
 - SEASONAL DWELLINGS CLOSELY
- EDUCATIONAL AND CORRECTIONAL INSTITUTIONS**
 - SCHOOLHOUSE
 - TOWNHALL, GRANGE, OR COMMUNITY HALL
- CONSERVATION AND RECREATION**
 - PICNIC GROUND
 - PLAYGROUND, BALL FIELD, ETC.
 - BATHING BEACH OR SWIMMING POOL
 - SMALL PARK (SP, STATE, CP, COUNTY, MP, MUNICIPAL, WP, WAYSIDE PARK)
 - GOLF GROUND OR COUNTRY CLUB
 - FAIR GROUND, RACE COURSE, SPEEDWAY
- INDUSTRIAL**
 - STORE OR SMALL BUSINESS ESTABLISHMENT
 - GROUP OF STORAGE TANKS (OIL OR GAS)
 - GALVANIZING OR PUMPING STATION
 - WAREHOUSE - GENERAL
 - GRAIN ELEVATOR
 - STOCK YARD - LOADING PEN OR CORRAL
 - GRAVEL PIT
- AIRPORTS**
 - LANDING AREA OR STRIP
 - AIRWAY LIGHT BEACON, GENERAL
- MISCELLANEOUS**
 - TRIANGULATION STATION
 - DOT TO INDICATE LOCATION OF ANY CULTURAL FEATURE SHOWN OUT OF POSITION
 - ALL VACANT CULTURE INDICATED BY OPEN SYMBOLS
 - LATITUDE AND LONGITUDE

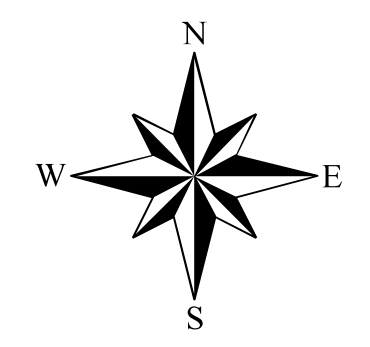

GENERAL HIGHWAY MAP MC INTOSH COUNTY NORTH DAKOTA

PREPARED BY THE
NORTH DAKOTA DEPARTMENT OF TRANSPORTATION
PLANNING / ASSET MANAGEMENT DIVISION
IN COOPERATION WITH THE
U.S. DEPARTMENT OF TRANSPORTATION
FEDERAL HIGHWAY ADMINISTRATION

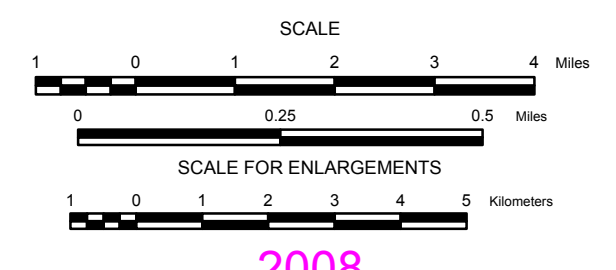

2008

BASED ON AERIAL PHOTOGRAPHY OF 1952
GROUND INVENTORY OF 2008
AERIAL INVENTORY OF 2008

UNIVERSAL TRANSVERSE MERCATOR ZONE 14
NORTH AMERICAN DATUM 83

NAME AND LOCATION OF ORGANIZED CIVIL TOWNSHIPS
THOSE UNORGANIZED ARE SO NOTED

T. 132 N. - R. 73 W. UNORGANIZED	T. 130 N. - R. 73 W. UNORGANIZED
T. 132 N. - R. 72 W. UNORGANIZED	T. 130 N. - R. 72 W. UNORGANIZED
T. 132 N. - R. 71 W. UNORGANIZED	T. 130 N. - R. 71 W. UNORGANIZED
T. 132 N. - R. 70 W. UNORGANIZED	T. 130 N. - R. 70 W. UNORGANIZED
T. 132 N. - R. 69 W. UNORGANIZED	T. 130 N. - R. 69 W. UNORGANIZED
T. 132 N. - R. 68 W. UNORGANIZED	T. 130 N. - R. 68 W. UNORGANIZED
T. 132 N. - R. 67 W. UNORGANIZED	T. 130 N. - R. 67 W. UNORGANIZED
T. 131 N. - R. 73 W. UNORGANIZED	T. 129 N. - R. 73 W. UNORGANIZED
T. 131 N. - R. 72 W. UNORGANIZED	T. 129 N. - R. 72 W. UNORGANIZED
T. 131 N. - R. 71 W. UNORGANIZED	T. 129 N. - R. 71 W. UNORGANIZED
T. 131 N. - R. 70 W. UNORGANIZED	T. 129 N. - R. 70 W. UNORGANIZED
T. 131 N. - R. 69 W. UNORGANIZED	T. 129 N. - R. 69 W. UNORGANIZED
T. 131 N. - R. 68 W. UNORGANIZED	T. 129 N. - R. 68 W. UNORGANIZED
T. 131 N. - R. 67 W. UNORGANIZED	T. 129 N. - R. 67 W. UNORGANIZED

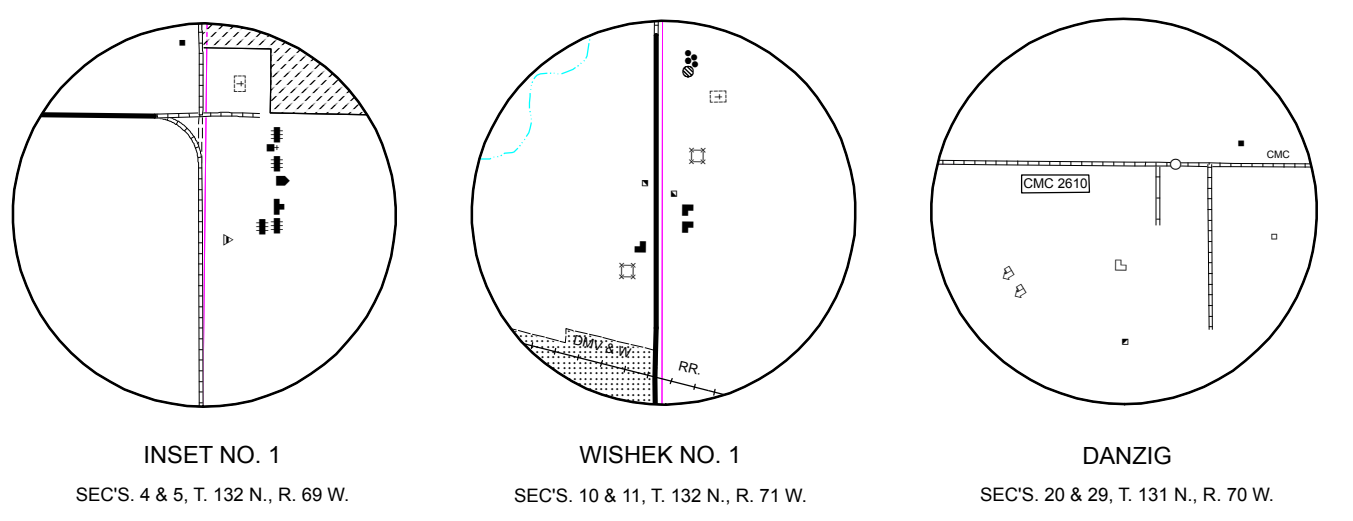

LEGEND

- INTERSTATE
- PRINCIPAL ARTERIAL
- MINOR ARTERIAL
- MAJOR COLLECTOR

REVISION DATE AND CHANGE

04-23-2015 Removed 5.0 miles of CMC2624
04-23-2015 Added 2.0 miles to CMC2624

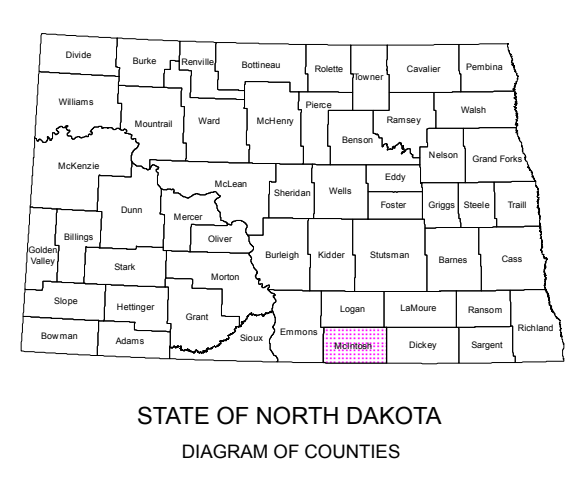

COPIES OF THIS MAP ARE AVAILABLE FOR PUBLIC USE AT A NOMINAL COST FROM:
MAP SALES, N.D. DEPT. OF TRANSPORTATION, 608 E. BLVD. AVE., BISMARCK, N.D. 58505-0700