

2007 FUNCTIONAL CLASSIFICATION

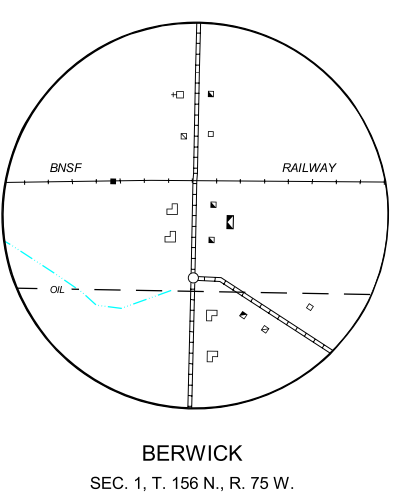

GENERAL LEGEND	
ROADS AND ROADWAY FEATURES	FARM UNITS, DWELLINGS, ETC.
PRIMITIVE ROAD	FARM UNIT (FARM UNITS SHOWN IN MUNICIPAL LIMITS INDICATE FARM BUILDINGS FOR FARM USE)
UNIMPROVED ROAD	DWELLING OTHER THAN FARM
GRAVEL AND DRAINED ROAD	ROWS OR GROUPS OF DWELLINGS CLOSELY SPACED (FIGURE DENOTES NUMBER OF DWELLINGS)
PAVED ROAD	BARRACKS, OR DORMATORIES FOR STUDENTS, WORKERS, MIGRANTS, ETC.
STREETS IN UNINCORPORATED TOWNS	SEASONAL OR SUMMER COLONY DWELLING
INDIAN SERVICE ROAD	SEASONAL DWELLINGS CLOSELY SPACED
COUNTY MAJOR COLLECTOR ROUTE NUMBER	CHURCH
POINTS BETWEEN WHICH DISTANCES ARE MEASURED	CEMETERY
INTERSTATE NUMBERED HIGHWAY	WELL
U.S. NUMBERED HIGHWAY	TOLL HOUSE, STATE PORT OF ENTRY, OR WEIGHT STATION
STATE HIGHWAY SYSTEM	TENANT HOUSE
STRUCTURES	PUBLIC SERVICE FACILITIES
HIGHWAY BRIDGE, GENERAL	POST OFFICE
HIGHWAY GRADE SEPARATION	HIGHWAY GARAGE
DAM WITH ROAD	FIRE ENGINE HOUSE
MINOR DRAINAGE STRUCTURE	GARBAGE OR RUBBISH DUMP
CONCRETE FORD OR DIP	SEWAGE DISPOSAL PLANT
FORD - ROAD ESTABLISHED	SANITARY FILL
TRUSS OR GIRDER	AUTOMOBILE GRAVEYARD
RAILROADS	WATER SUPPLY STAND PIPE OR TANK
RAILROAD (ANY NUMBER OF TRACKS USED BY A SINGLE OPERATING CO.)	PIPE LINE, GAS
RAILROAD STATION	PIPE LINE, OIL
BOUNDARIES	TRANSMISSION LINE
STATE OR PROVINCE LINE	POWER SUBSTATION
COUNTY LINE	BOOSTER STATION
TOWNSHIP LINE	COMMUNICATION TOWER
CORPORATE LINE	POLICE STATION
SECTION LINE	MUNICIPAL BUILDING
MATCH LINE BETWEEN ADJOINING SHEETS OF SAME COUNTY	COURTHOUSE
BOUNDARY TO MARK ENLARGEMENT INSET	CONSERVATION AND RECREATION
NATIONAL REFUGES	PICNIC GROUND
MONUMENT - SMALL, HISTORIC SITE	PLAYGROUND, BALL FIELD, ETC.
WILDLIFE MANAGEMENT AREA	SCENIC SITE
WATERFOWL PRODUCTION AREA	CAMP SITE, NO PERMANENCE (TENTS OR TRAILER PARKING)
STATE PARKS	TOURIST COURT, OR MOTEL
STATE SCHOOL LAND	REST AREA
NATIONAL GRASSLANDS	SMALL PARK (SP-STATE, CP-COUNTY, MP-MUNICIPAL, WP-WAYSIDE PARK)
RESERVOIR BOUNDARY (TAKING LINE)	GOLF GROUND OR COUNTRY CLUB
NATIONAL PARKS AND OTHER RESERVATIONS	FAIR GROUND, RACE COURSE, SPEEDWAY
DRAINAGE	GUIDE HOUSE OR GATE HOUSE
INTERMITTENT STREAM (NARROW)	INDUSTRIAL
NARROW STREAM	STORE OR SMALL BUSINESS ESTABLISHMENT
WIDE STREAM	FACTORY OR INDUSTRIAL PLANT
WIDE STREAM WITH DAM	GAS TANK
LAKE, RESERVOIR, OR POND WITH DAM	GROUP OF STORAGE TANKS (OIL OR GAS)
MARSH OR SWAMP LAND	FILLING STATION
DRAINAGE DITCH	PUMPING STATION (OIL OR GAS)
NAVIGATION	WAREHOUSE - GENERAL
DOCK, PIER, OR LANDING	GRAIN ELEVATOR
MISCELLANEOUS	BEEF DUMP
TRIANGULATION STATION	GRAVEL PIT
DOT TO INDICATE LOCATION OF ANY CULTURAL FEATURE SHOWN OUT OF POSITION	OIL OR GAS WELL
ALL VACANT CULTURE INDICATED BY OPEN SYMBOL	MINE - SHAFT OR DRIFT (ANY KIND)
LATITUDE AND LONGITUDE	EDUCATIONAL AND CORRECTIONAL INSTITUTIONS
NATURAL FEATURES	TOWNHALL, GRANGE, OR COMMUNITY HALL
PROMINENT ELEVATION - WITH NAME	MUSEUM - GENERAL
	CITY AND VILLAGE CENTERS
	COUNTY SEAT
	OTHER CITIES AND VILLAGES
	INCORPORATED CITY OR VILLAGE (GENERALIZED)
	AIRPORTS
	AIRFIELD, LIMITED FACILITIES
	LANDING AREA OR STRIP

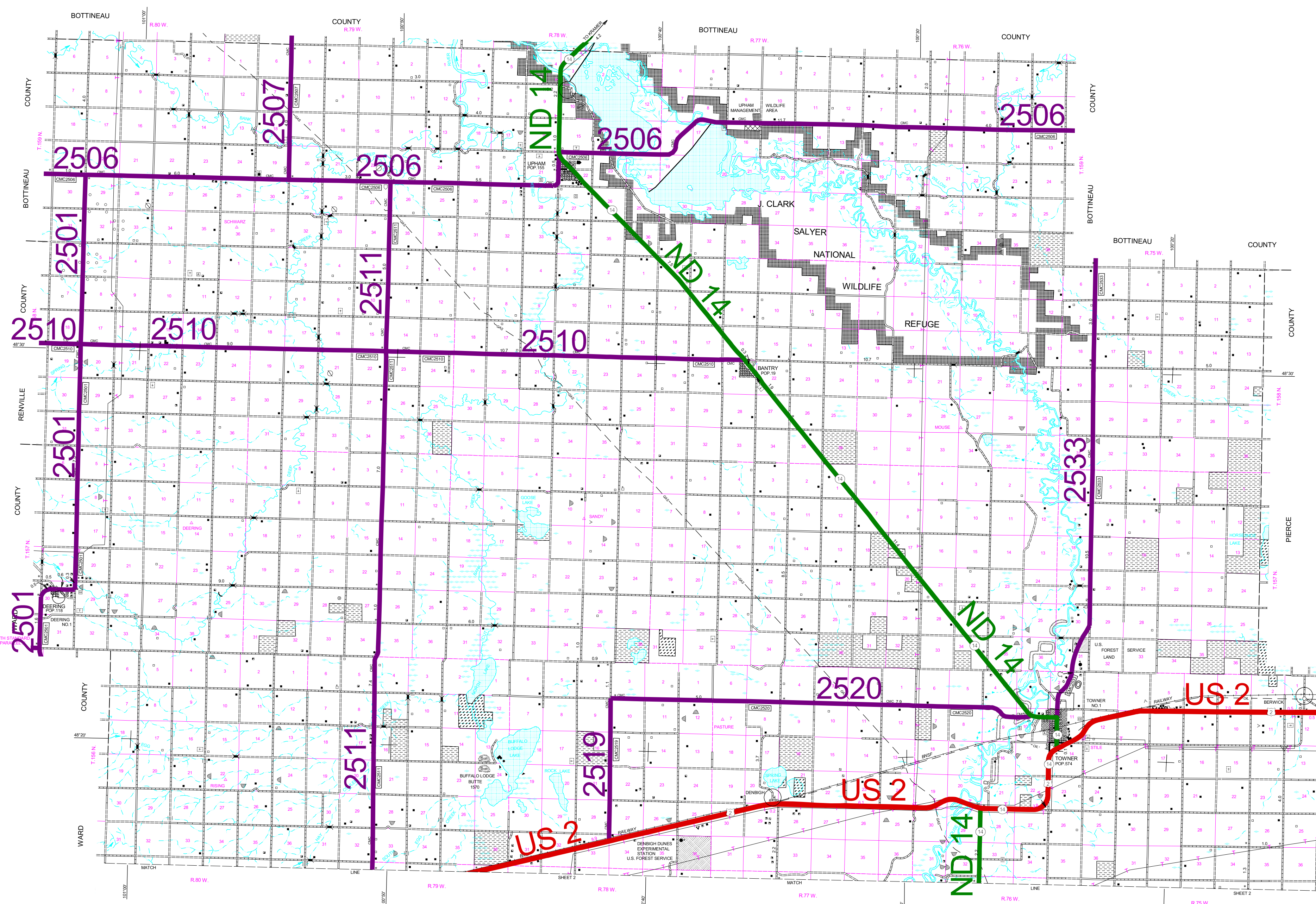
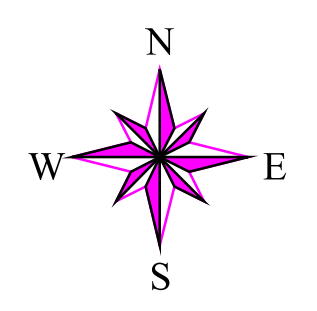

LEGEND	
	PRINCIPAL ARTERIALS
	MINOR ARTERIALS
	MAJOR COLLECTORS

GENERAL HIGHWAY MAP McHENRY COUNTY NORTH DAKOTA

PREPARED BY THE
NORTH DAKOTA DEPARTMENT OF TRANSPORTATION
PLANNING AND PROGRAMMING DIVISION

IN COOPERATION WITH THE
U.S. DEPARTMENT OF TRANSPORTATION
FEDERAL HIGHWAY ADMINISTRATION

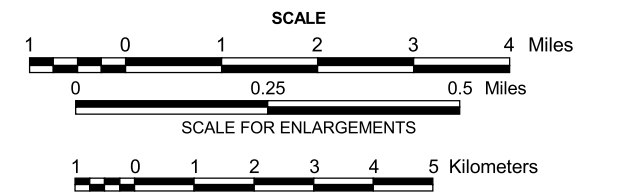

2003

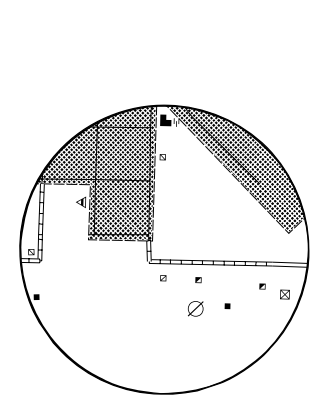

DEERING NO. 1
SEC. 30, T. 157 N., R. 80 W.

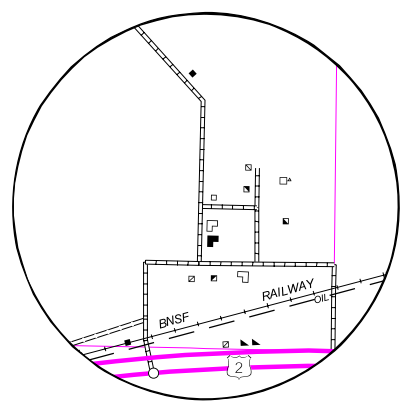

DENBIGH
SEC. 20, 21, & 28, T. 156 N., R. 77 W.

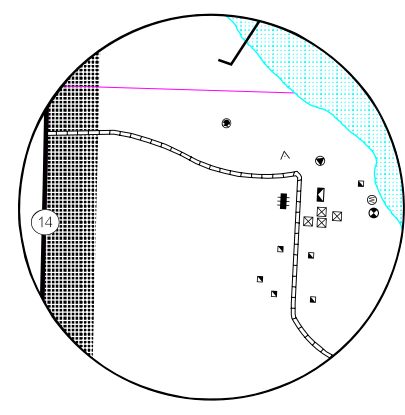

INSET NO. 2
SEC. 10, T. 159 N., R. 78 W.

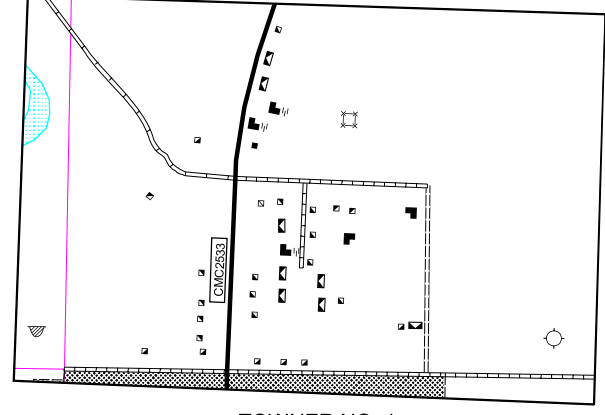

TOWNER NO. 1
SEC. 2, T. 156 N., R. 76 W.

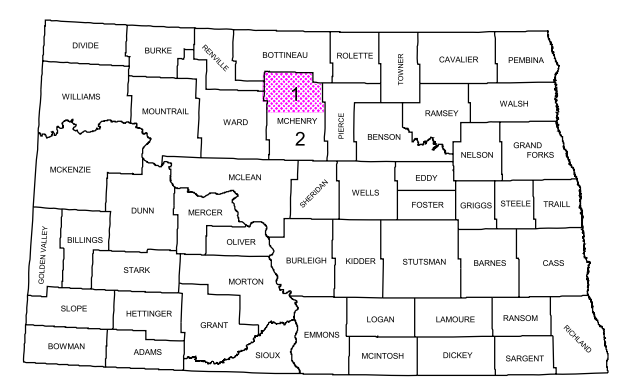

STATE OF NORTH DAKOTA
DIAGRAM OF COUNTIES

COPIES OF THIS MAP ARE AVAILABLE FOR PUBLIC USE AT A NOMINAL COST FROM:
MAP SALES, N.D. DEPT. OF TRANSPORTATION, 608 E. BLVD. AVE., BISMARCK, N.D. 58505-0700
f:\planning\arcview\stevenc\cmcbok

BASED ON AERIAL PHOTOGRAPHY OF 1953
GROUND INVENTORY OF 2003
AERIAL INVENTORY OF 2003
UNIVERSAL TRANSVERSE MERCATOR ZONE 14
NORTH AMERICAN DATUM 83