

# 2007 FUNCTIONAL CLASSIFICATION

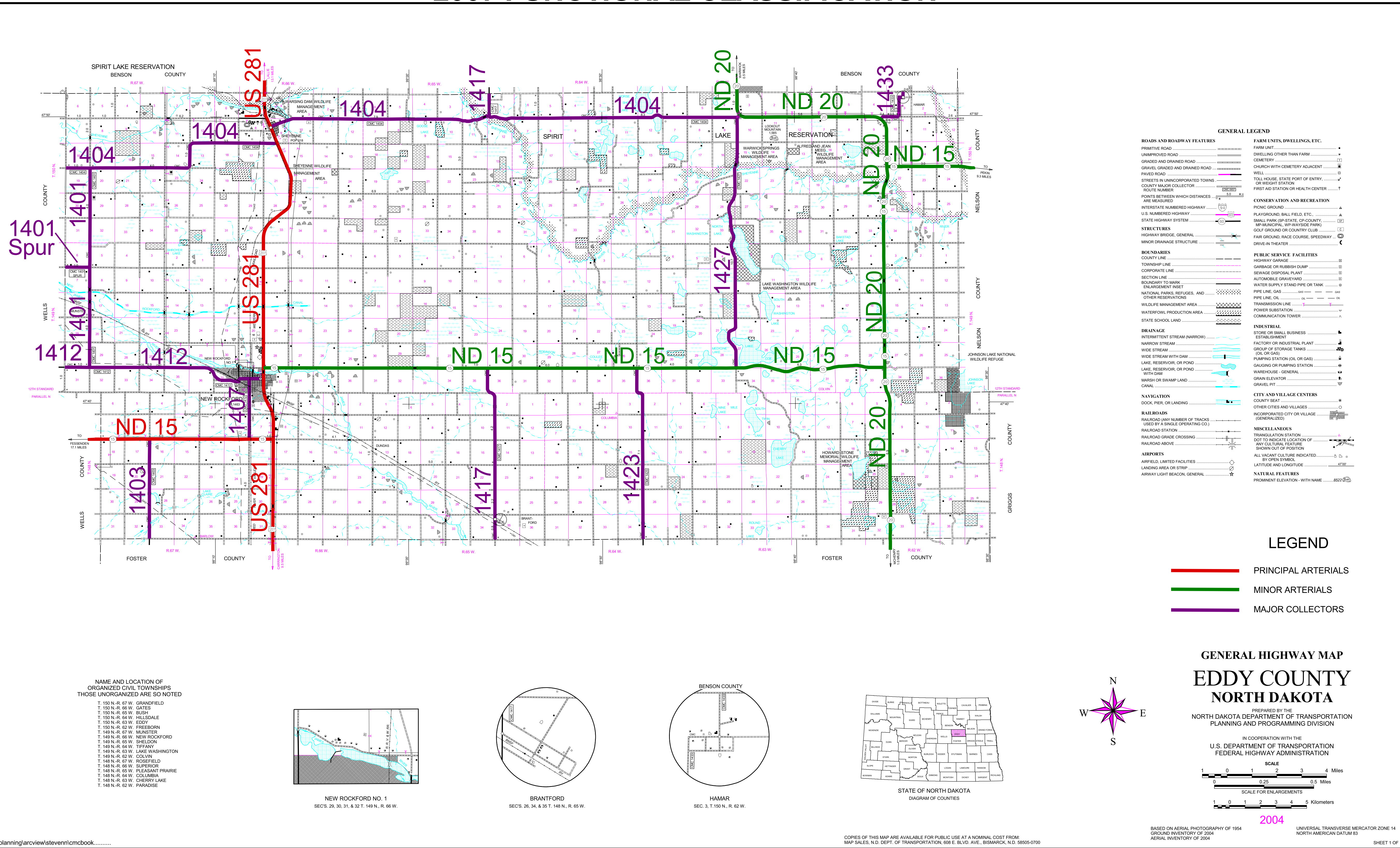

### GENERAL LEGEND

<b>ROADS AND ROADWAY FEATURES</b>	<b>FARM UNITS, DWELLINGS, ETC.</b>
PRIMITIVE ROAD	FARM UNIT
UNIMPROVED ROAD	DWELLING OTHER THAN FARM
GRAVEL GRADED AND DRAINED ROAD	CEMETERY
GRAVEL GRADED AND DRAINED ROAD	CHURCH WITH CEMETERY ADJACENT
PAVED ROAD	WELL
STREETS IN UNINCORPORATED TOWNS	TOLL HOUSE, STATE PORT OF ENTRY, OR WEIGHT STATION
COUNTY MAJOR COLLECTOR ROUTE NUMBER	FIRST AID STATION OR HEALTH CENTER
POINTS BETWEEN WHICH DISTANCES ARE MEASURED	
INTERSTATE NUMBERED HIGHWAY	<b>CONSERVATION AND RECREATION</b>
U.S. NUMBERED HIGHWAY	PICNIC GROUND
STATE HIGHWAY SYSTEM	PLAYGROUND, BALL FIELD, ETC.
	SMALL PARK (SP-STATE, CP-COUNTY, MP-MUNICIPAL, WP-WAYSIDE PARK)
<b>STRUCTURES</b>	GOLF GROUND OR COUNTRY CLUB
HIGHWAY BRIDGE, GENERAL	FAIR GROUND, RACE COURSE, SPEEDWAY
MINOR DRAINAGE STRUCTURE	DRIVE-IN THEATER
	<b>PUBLIC SERVICE FACILITIES</b>
<b>BOUNDARIES</b>	HIGHWAY GARAGE
COUNTY LINE	GARBAGE OR RUBBISH DUMP
TOWNSHIP LINE	SEWAGE DISPOSAL PLANT
CORPORATE LINE	AUTOMOBILE GRAVEYARD
SECTION LINE	WATER SUPPLY STAND PIPE OR TANK
BOUNDARY TO MARK ENLARGEMENT INSET	PIPE LINE, GAS
NATIONAL PARKS, REFUGES, AND OTHER RESERVATIONS	PIPE LINE, OIL
WILDLIFE MANAGEMENT AREA	TRANSMISSION LINE
WATERFOWL PRODUCTION AREA	POWER SUBSTATION
STATE SCHOOL LAND	COMMUNICATION TOWER
	<b>INDUSTRIAL</b>
<b>DRAINAGE</b>	STORE OR SMALL BUSINESS ESTABLISHMENT
INTERMITTENT STREAM (NARROW)	FACTORY OR INDUSTRIAL PLANT
NARROW STREAM	GROUP OF STORAGE TANKS (OIL OR GAS)
WIDE STREAM	PUMPING STATION (OIL OR GAS)
WIDE STREAM WITH DAM	GASING OR PUMPING STATION
LAKE, RESERVOIR, OR POND WITH DAM	WAREHOUSE - GENERAL
LAKE, RESERVOIR, OR POND	GRAIN ELEVATOR
MARSH OR SWAMP LAND	GRAVEL PIT
CANAL	
	<b>CITY AND VILLAGE CENTERS</b>
<b>NAVIGATION</b>	COUNTY SEAT
DOCK, PIER, OR LANDING	OTHER CITIES AND VILLAGES
	INCORPORATED CITY OR VILLAGE (GENERALIZED)
<b>RAILROADS</b>	
RAILROAD (ANY NUMBER OF TRACKS USED BY A SINGLE OPERATING CO.)	<b>MISCELLANEOUS</b>
RAILROAD STATION	TRIANGULATION STATION
RAILROAD GRADE CROSSING	DOT TO INDICATE LOCATION OF ANY CULTURAL FEATURE SHOWN OUT OF POSITION
RAILROAD ABOVE	ALL VACANT CULTURE INDICATED BY OPEN SYMBOL
	LATITUDE AND LONGITUDE
<b>AIRPORTS</b>	<b>NATURAL FEATURES</b>
AIRFIELD, LIMITED FACILITIES	PROMINENT ELEVATION - WITH NAME
LANDING AREA OR STRIP	
AIRWAY LIGHT BEACON, GENERAL	

### LEGEND

	PRINCIPAL ARTERIALS
	MINOR ARTERIALS
	MAJOR COLLECTORS

NAME AND LOCATION OF ORGANIZED CIVIL TOWNSHIPS THOSE UNORGANIZED ARE SO NOTED

T. 150 N.-R. 67 W. GRANDFIELD
T. 150 N.-R. 68 W. GATES
T. 150 N.-R. 65 W. BUSH
T. 150 N.-R. 64 W. HILLSDALE
T. 150 N.-R. 63 W. EDDY
T. 150 N.-R. 62 W. FREEBORN
T. 149 N.-R. 67 W. MUNSTER
T. 149 N.-R. 66 W. NEW ROCKFORD
T. 149 N.-R. 65 W. SHELDON
T. 149 N.-R. 64 W. TIFFANY
T. 149 N.-R. 63 W. LAKE WASHINGTON
T. 149 N.-R. 62 W. COLVIN
T. 148 N.-R. 67 W. ROSEFIELD
T. 148 N.-R. 66 W. SUPERIOR
T. 148 N.-R. 65 W. PLEASANT PRAIRIE
T. 148 N.-R. 64 W. COLUMBIA
T. 148 N.-R. 63 W. CHERRY LAKE
T. 148 N.-R. 62 W. PARADISE

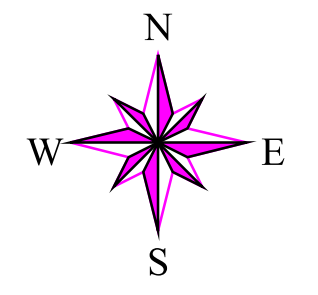
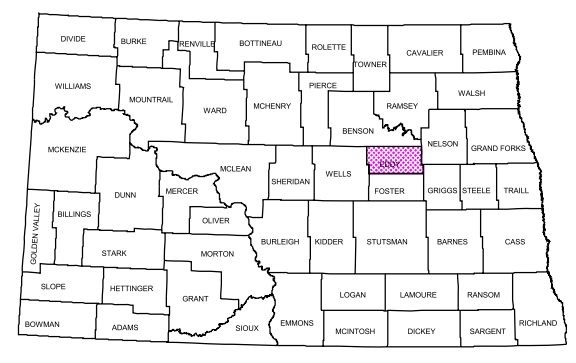
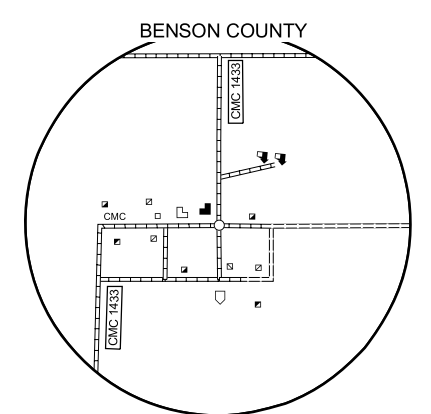
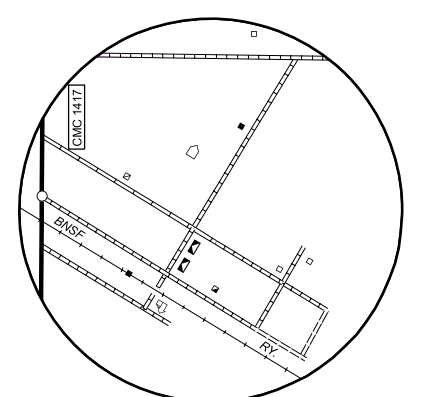
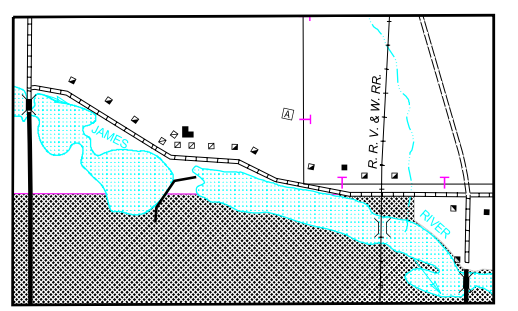

## GENERAL HIGHWAY MAP EDDY COUNTY NORTH DAKOTA

PREPARED BY THE  
NORTH DAKOTA DEPARTMENT OF TRANSPORTATION  
PLANNING AND PROGRAMMING DIVISION

IN COOPERATION WITH THE  
U.S. DEPARTMENT OF TRANSPORTATION  
FEDERAL HIGHWAY ADMINISTRATION

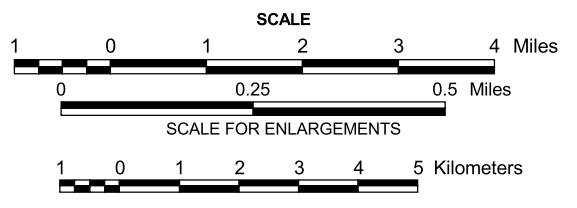

2004

BASED ON AERIAL PHOTOGRAPHY OF 1954  
GROUND INVENTORY OF 2004  
AERIAL INVENTORY OF 2004  
UNIVERSAL TRANSVERSE MERCATOR ZONE 14  
NORTH AMERICAN DATUM 83