

CONCRETE
SECS. 19 & 30, T. 161 N., R. 56 W.

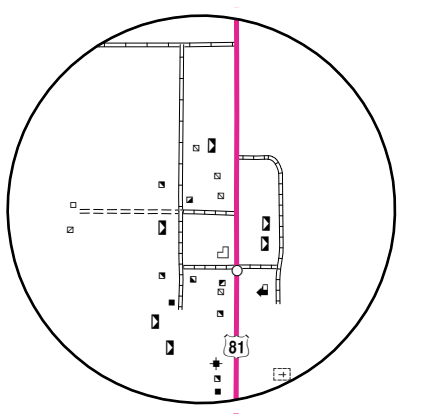

GLASSTON
SECS. 2 & 3, T. 160 N., R. 53 W.

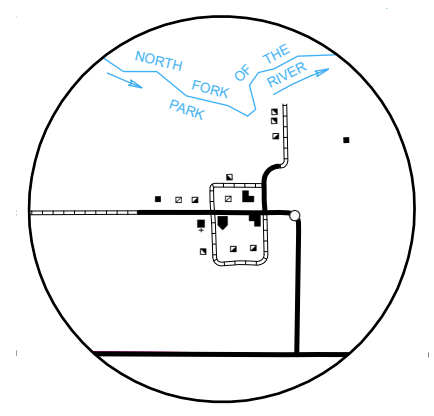

GARDAR
SECS. 16 & 21, T. 159 N., R. 56 W.

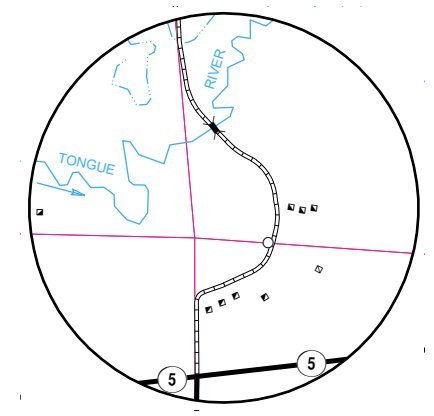

AKRA
SECS. 10, 11, 14, & 15, T. 161 N., R. 55 W.

NAME AND LOCATION OF ORGANIZED CIVIL TOWNSHIPS THOSE UNORGANIZED ARE SO NOTED

- T. 164 N.-R. 56 W. WALHALLA
- T. 163 N.-R. 56 W. WALHALLA
- T. 164 N.-R. 55 W. SAINT JOSEPH
- T. 163 N.-R. 55 W. SAINT JOSEPH
- T. 164 N.-R. 54 W. FELSON
- T. 163 N.-R. 54 W. FELSON
- T. 164 N.-R. 53 W. NECHE
- T. 163 N.-R. 53 W. NECHE
- T. 163 N.-R. 52 W. NECHE
- T. 164 N.-R. 52 W. PEMBINA
- T. 164 N.-R. 51 W. PEMBINA
- T. 163 N.-R. 52 W. PEMBINA
- T. 163 N.-R. 51 W. PEMBINA
- T. 162 N.-R. 56 W. LAMOUR
- T. 162 N.-R. 55 W. ADVANCE
- T. 162 N.-R. 54 W. CAVALIER
- T. 161 N.-R. 54 W. CAVALIER
- T. 162 N.-R. 53 W. BATHGATE
- T. 162 N.-R. 52 W. CARLISLE
- T. 161 N.-R. 52 W. CARLISLE
- T. 162 N.-R. 51 W. JOLIETTE
- T. 162 N.-R. 50 W. JOLIETTE
- T. 161 N.-R. 51 W. JOLIETTE
- T. 161 N.-R. 50 W. JOLIETTE
- T. 161 N.-R. 56 W. BEAULIEU
- T. 161 N.-R. 55 W. AKRA
- T. 162 N.-R. 53 W. HAMILTON
- T. 161 N.-R. 53 W. HAMILTON
- T. 160 N.-R. 56 W. THINKVALLA
- T. 160 N.-R. 55 W. PARK
- T. 160 N.-R. 54 W. LODEMA
- T. 160 N.-R. 53 W. ST. THOMAS
- T. 159 N.-R. 53 W. ST. THOMAS
- T. 160 N.-R. 52 W. MIDLAND
- T. 159 N.-R. 52 W. MIDLAND
- T. 160 N.-R. 51 W. LINCOLN
- T. 160 N.-R. 50 W. LINCOLN
- T. 159 N.-R. 56 W. GARDAR
- T. 159 N.-R. 55 W. CRYSTAL
- T. 159 N.-R. 54 W. ELORA
- T. 159 N.-R. 51 W. DRAYTON
- T. 159 N.-R. 50 W. DRAYTON

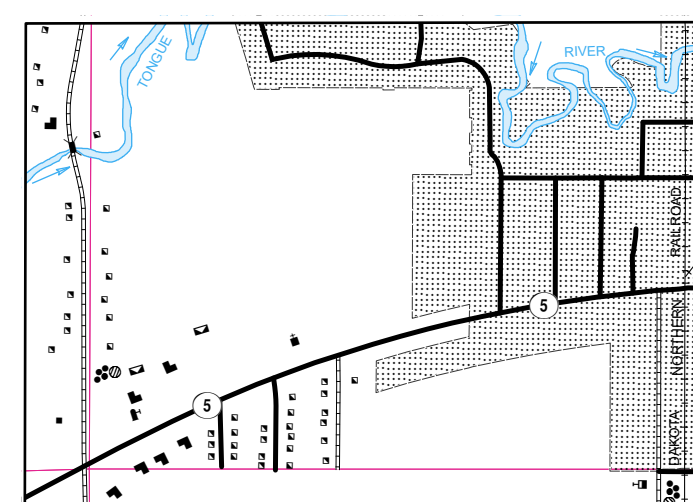

CAVALIER NO. 1
SECS. 4, 5, 8, & 9, T. 161 N., R. 54 W.

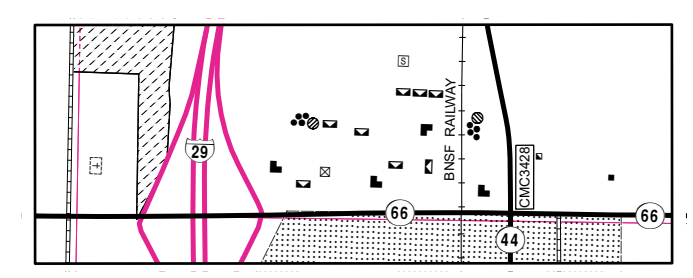

DRAYTON NO. 1
SECS. 22, 23, 26 & 27, T. 159 N., R. 51 W.

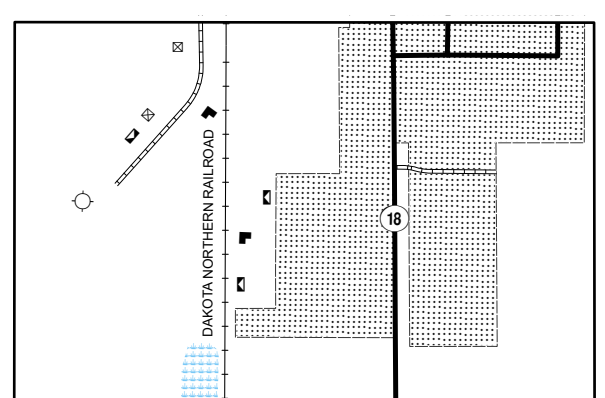

CAVALIER NO. 2
SECS. 9 & 10, T. 161 N., R. 54 W.

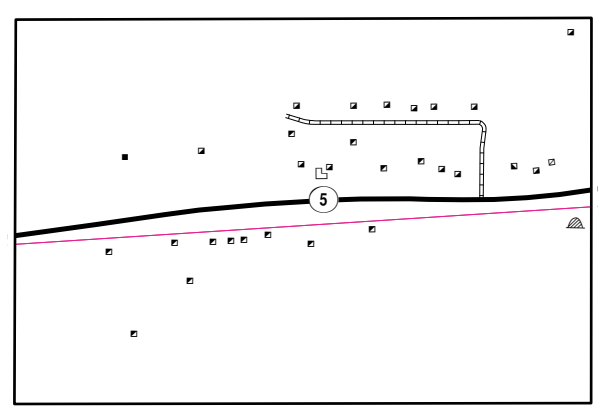

INSET NO. 3
SECS. 12 & 13, T. 161 N., R. 55 W.

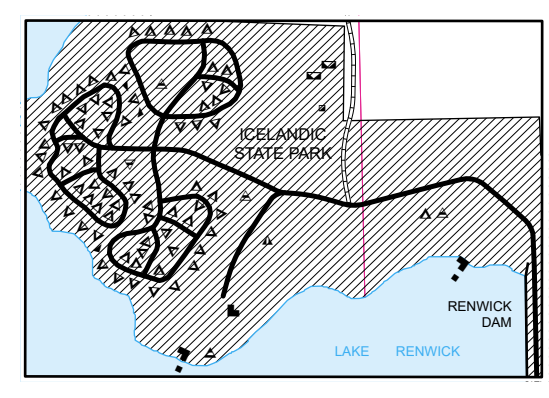

INSET NO. 5
SECS. 9 & 10, T. 161 N., R. 55 W.

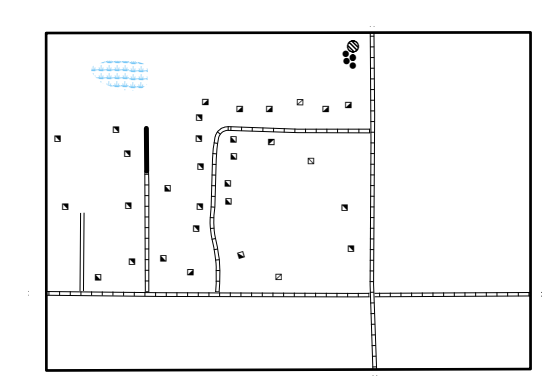

INSET NO. 2
SECS. 8, 9, 16, & 17, T. 161 N., R. 54 W.

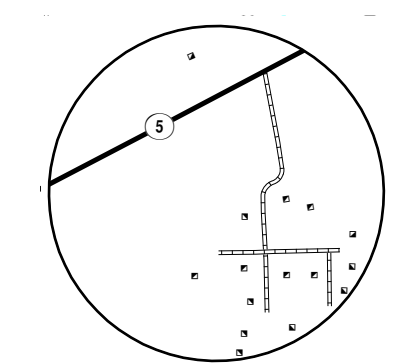

INSET NO. 4
SEC. 8, T. 161 N., R. 54 W.

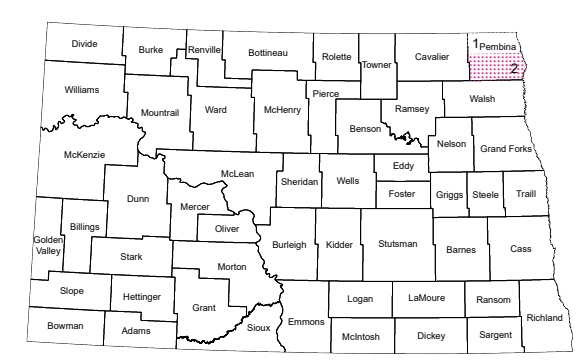

STATE OF NORTH DAKOTA
DIAGRAM OF COUNTIES

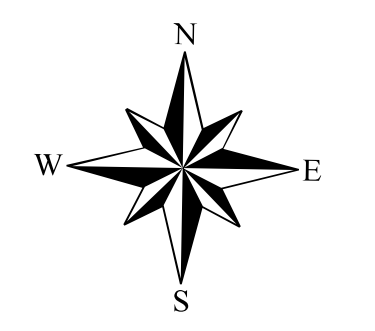

GENERAL HIGHWAY MAP PEMBINA COUNTY NORTH DAKOTA

PREPARED BY THE
NORTH DAKOTA DEPARTMENT OF TRANSPORTATION
PLANNING AND ASSET MANAGEMENT DIVISION

IN COOPERATION WITH THE
U.S. DEPARTMENT OF TRANSPORTATION
FEDERAL HIGHWAY ADMINISTRATION

SCALE
0 1 2 3 4 Miles

SCALE FOR ENLARGEMENTS
0 0.25 0.5 Miles

1 0.5 0 1 2 3 4 Kilometers

2021

BASED ON AERIAL PHOTOGRAPHY OF 1954
AERIAL INVENTORY OF 2021

UNIVERSAL TRANSVERSE MERCATOR ZONE 14
NORTH AMERICAN DATUM 83

SHEET 2 OF 2

Notice of Disclaimer
The North Dakota Department of Transportation (NDOT) makes this map available on an "as is" basis as a public service. Under no circumstances does NDOT warrant or certify the information to be free of errors or deficiencies of any kind. NDOT specifically disclaims all warranties, express or implied, including but not limited to the warranties of merchantability and fitness for a particular purpose.