

INSET NO. 17  
 SEC'S. 28, 29, 32, & 33, T. 144 N., R. 81 W.  
 SEC'S. 4, & 5, T. 143 N., R. 81 W.

NAME AND LOCATION OF ORGANIZED CIVIL TOWNSHIPS THOSE UNORGANIZED ARE SO NOTED

- |                                     |                                  |
|-------------------------------------|----------------------------------|
| T. 150 N.-R. 91 W. UNORGANIZED      | T. 148 N.-R. 83 W. SNOW          |
| T. 150 N.-R. 90 W. UNORGANIZED      | T. 148 N.-R. 82 W. MALCOLM       |
| T. 150 N.-R. 89 W. CREMERVILLE      | T. 148 N.-R. 81 W. UNORGANIZED   |
| T. 150 N.-R. 88 W. AMUNDSDALE       | T. 148 N.-R. 80 W. UNORGANIZED   |
| T. 150 N.-R. 87 W. GATE             | T. 148 N.-R. 79 W. MEDICINE HILL |
| T. 150 N.-R. 86 W. BLUE HILL        | T. 147 N.-R. 91 W. UNORGANIZED   |
| T. 150 N.-R. 85 W. DOUGLAS          | T. 147 N.-R. 90 W. UNORGANIZED   |
| T. 150 N.-R. 84 W. ROSEMONT         | T. 147 N.-R. 89 W. UNORGANIZED   |
| T. 150 N.-R. 83 W. UNORGANIZED      | T. 147 N.-R. 88 W. UNORGANIZED   |
| T. 150 N.-R. 82 W. UNORGANIZED      | T. 147 N.-R. 87 W. UNORGANIZED   |
| T. 150 N.-R. 81 W. ANDREWS          | T. 147 N.-R. 86 W. UNORGANIZED   |
| T. 150 N.-R. 80 W. OTIS             | T. 147 N.-R. 85 W. UNORGANIZED   |
| T. 150 N.-R. 79 W. BUTTE            | T. 147 N.-R. 84 W. UNORGANIZED   |
| T. 150 N.-R. 78 W. DOGDEN           | T. 147 N.-R. 83 W. VICTORIA      |
| T. 149 N.-R. 91 W. UNORGANIZED      | T. 147 N.-R. 82 W. UNORGANIZED   |
| T. 149 N.-R. 90 W. UNORGANIZED      | T. 147 N.-R. 81 W. TURTLE LAKE   |
| T. 149 N.-R. 89 W. LOQUEMONT        | T. 147 N.-R. 80 W. LAKE WILLIAMS |
| T. 149 N.-R. 88 W. DEEPWATER        | T. 147 N.-R. 79 W. WISE          |
| T. 149 N.-R. 87 W. ROSEGLEN         | T. 146 N.-R. 84 W. UNORGANIZED   |
| T. 149 N.-R. 86 W. UNORGANIZED      | T. 146 N.-R. 83 W. LONGFELLOW    |
| T. 149 N.-R. 85 W. UNORGANIZED      | T. 146 N.-R. 82 W. UNORGANIZED   |
| T. 149 N.-R. 84 W. MC GINNIS        | T. 146 N.-R. 81 W. UNORGANIZED   |
| T. 149 N.-R. 83 W. UNORGANIZED      | T. 146 N.-R. 80 W. UNORGANIZED   |
| T. 149 N.-R. 82 W. UNORGANIZED      | T. 146 N.-R. 79 W. MERCER        |
| T. 149 N.-R. 81 W. GREATSTONE       | T. 145 N.-R. 84 W. UNORGANIZED   |
| T. 149 N.-R. 80 W. HORSESHOE VALLEY | T. 145 N.-R. 83 W. UNORGANIZED   |
| T. 149 N.-R. 79 W. AURENA           | T. 145 N.-R. 82 W. UNORGANIZED   |
| T. 149 N.-R. 78 W. BYERSVILLE       | T. 145 N.-R. 81 W. UNORGANIZED   |
| T. 148 N.-R. 91 W. UNORGANIZED      | T. 145 N.-R. 80 W. UNORGANIZED   |
| T. 148 N.-R. 90 W. UNORGANIZED      | T. 145 N.-R. 79 W. UNORGANIZED   |
| T. 148 N.-R. 89 W. UNORGANIZED      | T. 144 N.-R. 84 W. UNORGANIZED   |
| T. 148 N.-R. 88 W. UNORGANIZED      | T. 144 N.-R. 83 W. UNORGANIZED   |
| T. 148 N.-R. 87 W. BLACKWATER       | T. 144 N.-R. 82 W. UNORGANIZED   |
| T. 148 N.-R. 86 W. UNORGANIZED      | T. 144 N.-R. 81 W. UNORGANIZED   |
| T. 148 N.-R. 85 W. SAINT MARY       | T. 144 N.-R. 80 W. UNORGANIZED   |
| T. 148 N.-R. 84 W. UNORGANIZED      | T. 143 N.-R. 81 W. UNORGANIZED   |
|                                     | T. 143 N.-R. 80 W. UNORGANIZED   |

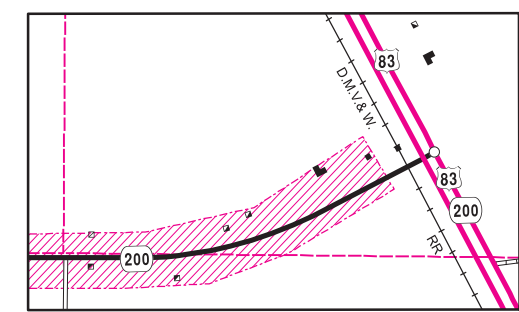

GATEWAY  
 SEC. 31, T. 147 N., R. 82 W.  
 SEC. 36, T. 147 N., R. 83 W.  
 SEC. 6, T. 146 N., R. 82 W.  
 SEC. 1, T. 146 N., R. 83 W.

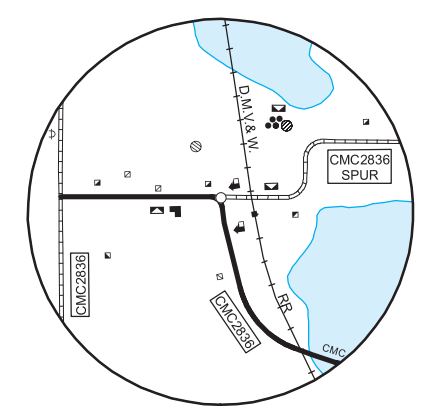

FALKIRK  
 SEC'S. 22, & 23, T. 145 N., R. 82 W.

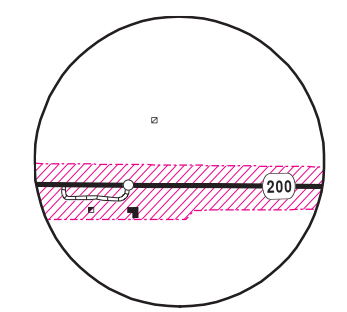

BIG BEND  
 SEC. 31, T. 147 N., R. 83 W.  
 SEC. 6, T. 146 N., R. 83 W.

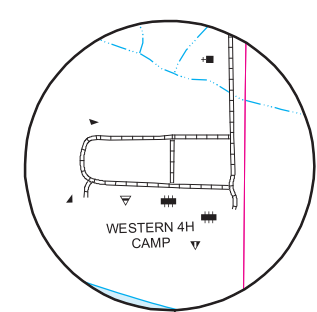

INSET NO. 12  
 SEC'S. 15, & 16, T. 144 N., R. 82 W.

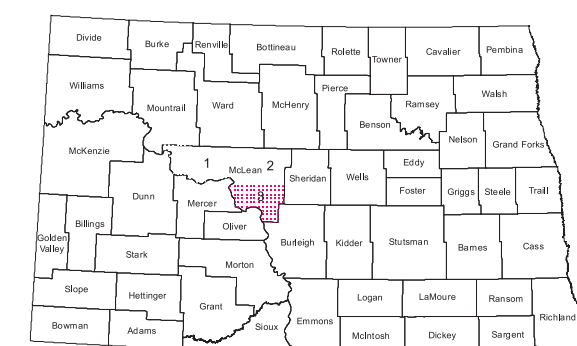

STATE OF NORTH DAKOTA  
 DIAGRAM OF COUNTIES

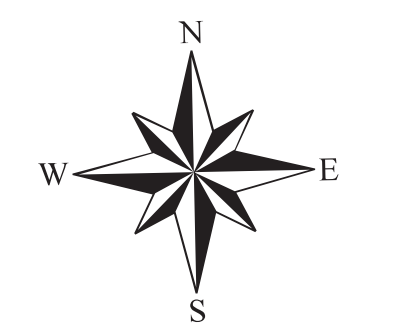

MC LEAN COUNTY

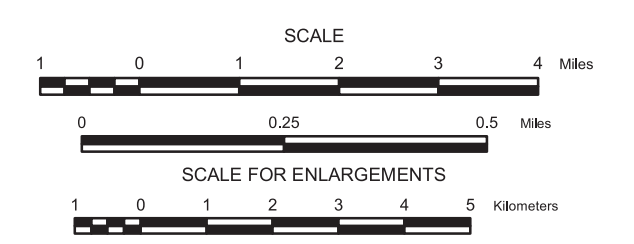

2013

**Notice of Disclaimer**  
 The North Dakota Department of Transportation (NDDOT) makes this map available on an "as is" basis as a public service. Under no circumstances does NDDOT warrant or certify the information to be free of errors or deficiencies of any kind. NDDOT specifically disclaims all warranties, express or implied, including but not limited to the warranties of merchantability and fitness for a particular purpose.

COPIES OF THIS MAP ARE AVAILABLE FOR PUBLIC USE AT A NOMINAL COST FROM:  
 MAP SALES, N.D. DEPT. OF TRANSPORTATION, 606 E. BLVD. AVE., BISMARCK, N.D. 58505-0700

BASED ON AERIAL PHOTOGRAPHY OF 1954  
 GROUND INVENTORY OF 2013  
 AERIAL INVENTORY OF 2013  
 UNIVERSAL TRANSVERSE MERCATOR ZONE 14  
 NORTH AMERICAN DATUM 83