

- ROADS AND ROADWAY FEATURES**
- PRIMITIVE ROAD
 - UNIMPROVED ROAD
 - GRADED AND DRAINED ROAD
 - GRAVEL GRADED AND DRAINED ROAD
 - PAVED ROAD
 - STREETS IN UNINCORPORATED AREAS
 - COUNTY MAJOR COLLECTOR
 - ROUTE NUMBER
 - POINTS BETWEEN WHICH DISTANCES ARE MEASURED
 - INTERSTATE NUMBERED HIGHWAY
 - U.S. NUMBERED HIGHWAY
 - STATE HIGHWAY SYSTEM
- AIRPORTS**
- LANDING AREA OR STRIP
- RAILROADS**
- RAILROAD (ANY NUMBER OF TRACKS)
 - BOUNDARY TO MARK (USED BY A SINGLE OPERATING CO.)
 - RAILROAD STATION
- DRAINAGE**
- INTERMITTENT STREAM (NARROW)
 - NARROW STREAM
 - WIDE STREAM
 - WIDE STREAM WITH DAM
 - LAKE, RESERVOIR, OR POND
 - LAKE, RESERVOIR, OR POND WITH DAM
 - MARSH OR SWAMP LAND
- NAVIGATION**
- DOCK, PIER, OR LANDING
- MISCELLANEOUS**
- TRIANGULATION STATION
 - DOT TO INDICATE LOCATION OF ANY CULTURAL FEATURE SHOWN OUT OF POSITION
 - ALL VACANT CULTURE INDICATED BY OPEN SYMBOL
 - LATITUDE AND LONGITUDE
- STRUCTURES**
- HIGHWAY BRIDGE, GENERAL
 - DAM WITH ROAD
 - MINOR DRAINAGE STRUCTURE
 - CONCRETE FORD OR DIP
 - FORD - ROAD ESTABLISHED
- NATURAL FEATURES**
- PROMINENT ELEVATION - WITH NAME
- BOUNDARIES**
- STATE OR PROVINCE LINE
 - COUNTY LINE
 - TOWNSHIP LINE
 - CORPORATE LINE
 - SECTION LINE
 - MATCH LINE BETWEEN ADJOINING SHEETS OF SAME COUNTY
 - BOUNDARY TO MARK (ENLARGEMENT INSET)
 - NATIONAL REFUGES
 - WILDLIFE MANAGEMENT AREA
 - WATERFOWL PRODUCTION AREA
 - STATE SCHOOL LAND
 - RESERVOIR BOUNDARY (TAKING LINE)
- CITY AND VILLAGE CENTERS**
- COUNTY SEAT
 - OTHER CITIES AND VILLAGES
 - INCORPORATED CITY OR VILLAGE (GENERALIZED)
- INDUSTRIAL**
- STORE OR SMALL BUSINESS ESTABLISHMENT
 - FACTORY OR INDUSTRIAL PLANT
 - GROUP OF STORAGE TANKS (OIL OR GAS)
 - WAREHOUSE - GENERAL
 - GRAIN ELEVATOR
 - STOCK YARD - LOADING PEN OR CORRAL
 - GRAVEL PIT
- EDUCATIONAL AND CORRECTIONAL INSTITUTIONS**
- SCHOOLHOUSE
 - TOWNHALL, GRANGE, OR COMMUNITY HALL
 - FARM UNITS, DWELLINGS, ETC.
 - FARM UNIT (FARM UNITS SHOWN IN MUNICIPAL LIMITS INDICATE FARM BUILDINGS FOR FARM USE)
 - DWELLING OTHER THAN FARM
 - ROWS OR GROUPS OF DWELLINGS
 - CLOSELY SPACED (FIGURE DENOTES NUMBER OF DWELLINGS)
 - SEASONAL OR SUMMER COLONY
 - DWELLING
 - SEASONAL DWELLINGS CLOSELY SPACED
 - CHURCH
 - CEMETERY
 - CHURCH WITH CEMETERY ADJACENT
 - WELL
 - TOLL HOUSE, STATE PORT OF ENTRY, OR WEIGHT STATION
- CONSERVATION AND RECREATION**
- PICNIC GROUND
 - TOURIST COURT, OR MOTEL
 - SMALL PARK (SP-STATE, CP-COUNTY, MP-MUNICIPAL, WP-WAYSIDE PARK)
 - GOLF GROUND OR COUNTRY CLUB
 - AMUSEMENT PARK OR HALL
 - FAIR GROUND, RACE COURSE, SPEEDWAY
 - DRIVE-IN THEATER
- PUBLIC SERVICE FACILITIES**
- POST OFFICE
 - HIGHWAY GARAGE
 - GARBAGE OR RUBBISH DUMP
 - SEWAGE DISPOSAL PLANT
 - AUTOMOBILE GRAVEYARD
 - POWER SUBSTATION
 - COMMUNICATION TOWER

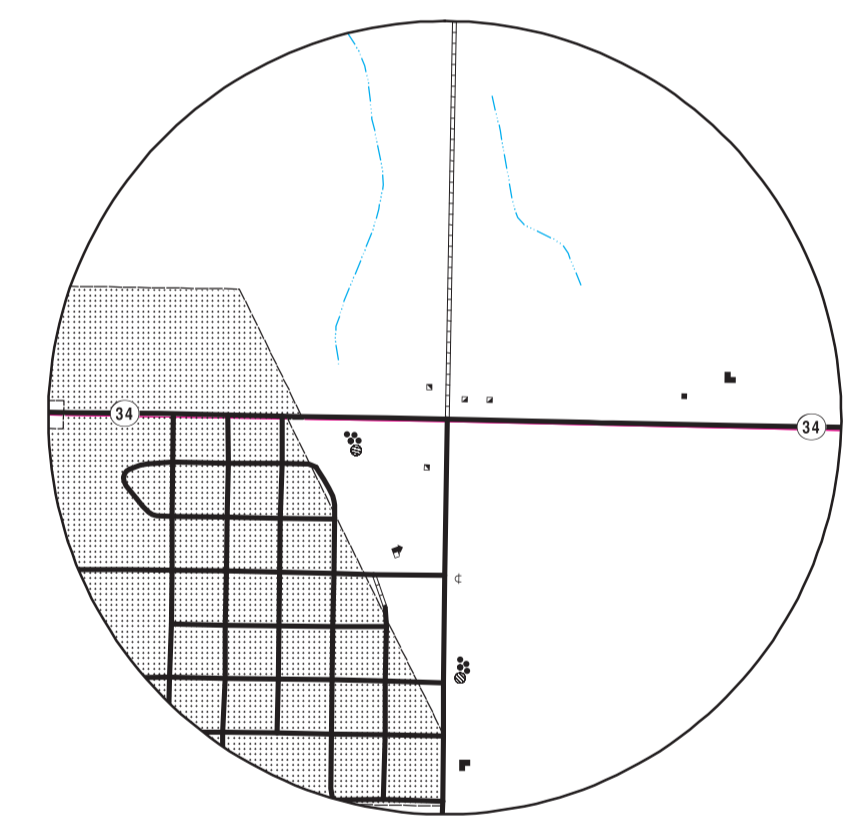

HAZELTON NO. 1
SEC. 19, 20, 29 & 30, T. 135 N., R. 76 W.

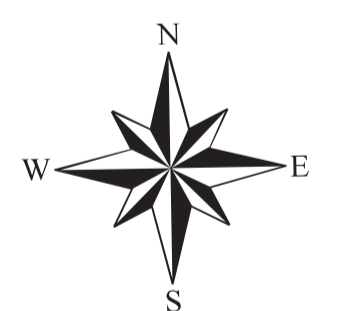

GENERAL HIGHWAY MAP EMMONS COUNTY NORTH DAKOTA

PREPARED BY THE
NORTH DAKOTA DEPARTMENT OF TRANSPORTATION
PLANNING / ASSET MANAGEMENT DIVISION
IN COOPERATION WITH THE
U.S. DEPARTMENT OF TRANSPORTATION
FEDERAL HIGHWAY ADMINISTRATION

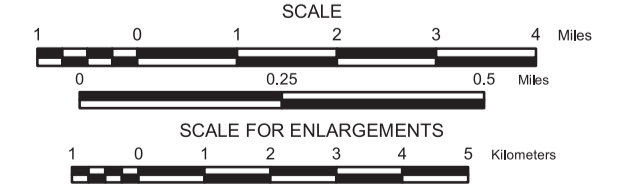

2014

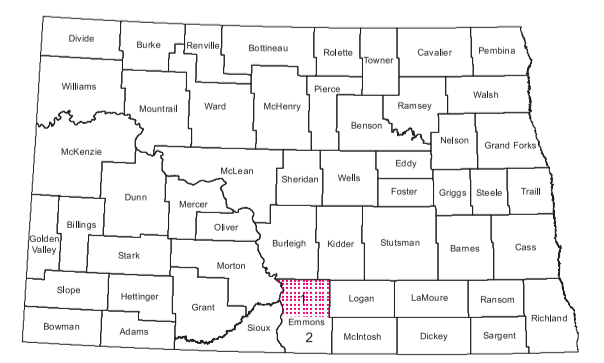

STATE OF NORTH DAKOTA
DIAGRAM OF COUNTIES

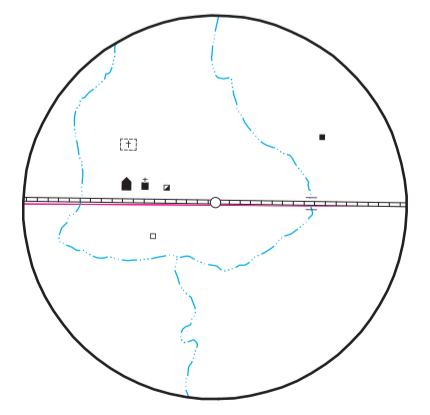

KUNTZ
SEC'S. 22 & 27, T. 133 N., R. 74 W.

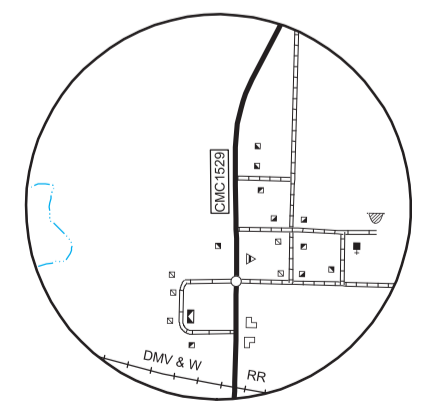

KINTYRE
SEC. 35, T. 136 N., R. 74 W.

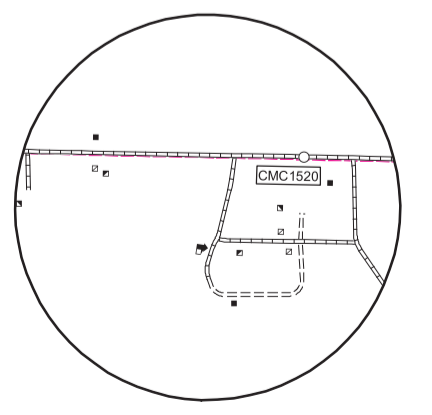

TEMVIK
SEC. 32, T. 134 N., R. 76 W.
SEC. 5, T. 133 N., R. 76 W.

Notice of Disclaimer
The North Dakota Department of Transportation (NDDOT) makes this map available on an "as is" basis as a public service. Under no circumstances does NDDOT warrant or certify the information to be free of errors or deficiencies of any kind. NDDOT specifically disclaims all warranties, express or implied, including but not limited to the warranties of merchantability and fitness for a particular purpose.

BASED ON AERIAL PHOTOGRAPHY OF 1954
GROUND INVENTORY OF 2014
AERIAL INVENTORY OF 2014
UNIVERSAL TRANSVERSE MERCATOR ZONE 14
NORTH AMERICAN DATUM 83
SHEET 1 OF 2