

MOFFIT
SEC'S. 16, 17, 20 & 21, T. 137 N., R. 76 W.

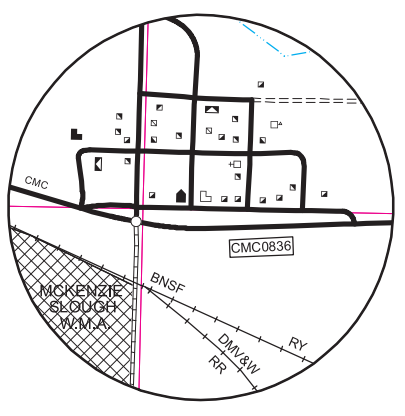

MC KENZIE
SEC'S. 28, 29, 32 & 33, T. 139 N., R. 77 W.

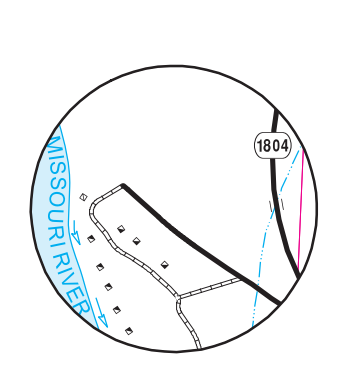

INSET NO. 1
SEC. 21, T. 140 N., R. 81 W.

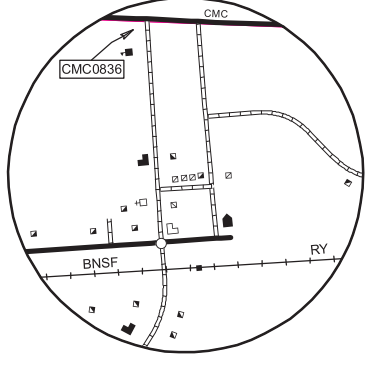

MENOKEN
SEC'S. 28 & 33, T. 139 N., R. 78 W.

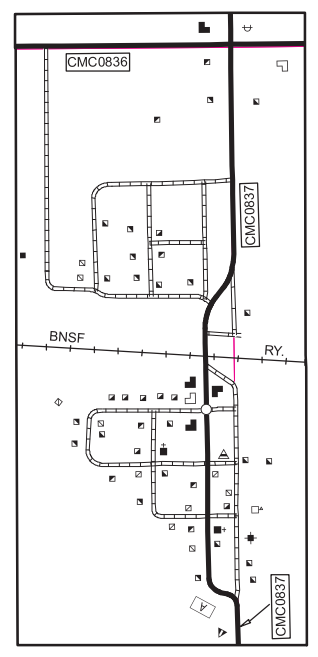

DRISCOLL
SEC'S 21 & 22, T. 139 N., R. 75 W.

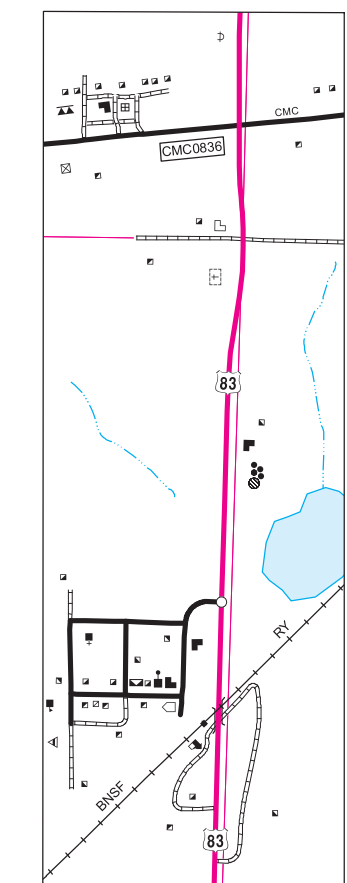

STERLING
SEC'S 28, 29, 32, & 33, T. 139 N., R. 76 W.

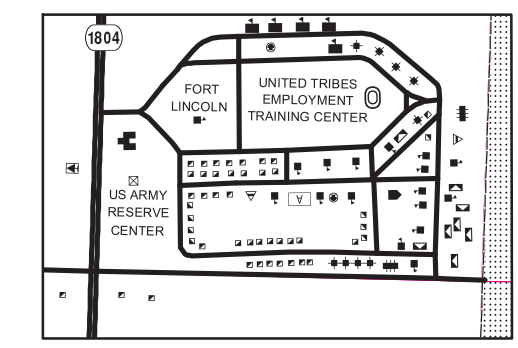

FORT LINCOLN
SEC'S 14, 15, 22, & 23, T. 138 N., R. 80 W.

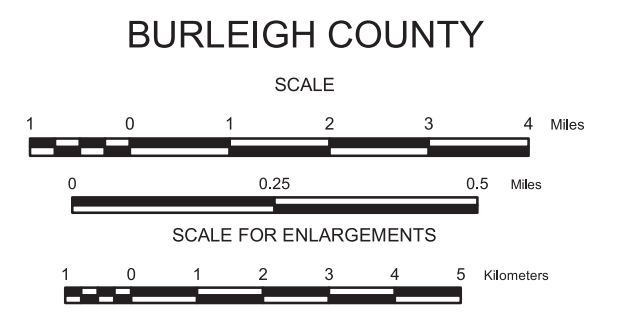
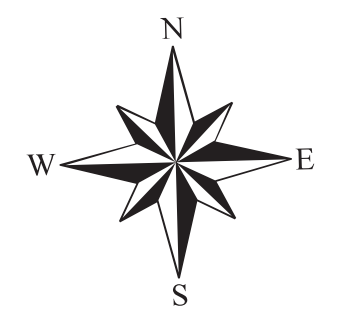

2013

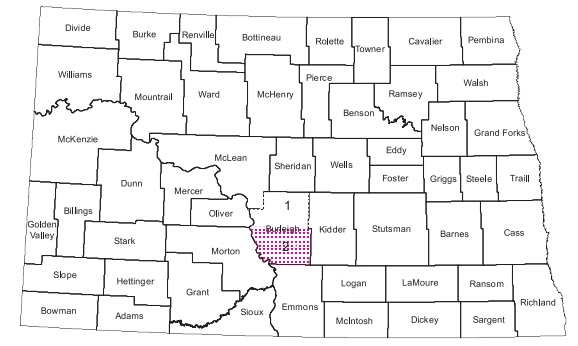

STATE OF NORTH DAKOTA
DIAGRAM OF COUNTIES

BASED ON AERIAL PHOTOGRAPHY OF 1957
GROUND INVENTORY OF 2013
AERIAL INVENTORY OF 2013
UNIVERSAL TRANSVERSE MERCATOR ZONE 14
NORTH AMERICAN DATUM 83

Notice of Disclaimer
The North Dakota Department of Transportation (NDDOT) makes this map available on an "as is" basis as a public service. Under no circumstances does NDDOT warrant or certify the information to be free of errors or deficiencies of any kind. NDDOT specifically disclaims all warranties, express or implied, including but not limited to the warranties of merchantability and fitness for a particular purpose.

COPIES OF THIS MAP ARE AVAILABLE FOR PUBLIC USE AT A NOMINAL COST FROM:
MAP SALES, N. D. DEPT. OF TRANSPORTATION, 608 E. BLVD. AVE., BISMARCK, ND 58505-0700