

- ROADS AND ROADWAY FEATURES**
- PRIMITIVE ROAD
  - UNIMPROVED ROAD
  - GRAVEL AND DRAINED ROAD
  - GRAVEL, GRADED AND DRAINED ROAD
  - PAVED ROAD
  - STREETS IN UNINCORPORATED AREAS
  - INTERCHANGE
  - COUNTY MAJOR COLLECTOR
  - ROUTE NUMBER
  - POINTS BETWEEN WHICH DISTANCES ARE MEASURED
  - INTERSTATE NUMBERED HIGHWAY
  - U.S. NUMBERED HIGHWAY
  - STATE HIGHWAY SYSTEM
- AIRPORTS**
- AIRFIELD, LIMITED FACILITIES
  - LANDING AREA OR STRIP
  - AIRWAY LIGHT BEACON, GENERAL
  - AIRPORT, GENERAL
- RAILROADS**
- RAILROAD (ANY NUMBER OF TRACKS USED BY A SINGLE OPERATING CO.)
  - RAILROAD STATION
  - RAILROAD GRADE CROSSING
  - RAILROAD ABOVE
  - RAILROAD BELOW
- DRAINAGE**
- INTERMITTENT STREAM (NARROW)
  - NARROW STREAM
  - WIDE STREAM
  - WIDE STREAM WITH DAM
  - LAKE, RESERVOIR, OR POND
  - LAKE, RESERVOIR, OR POND WITH DAM
  - MARSH OR SWAMP LAND
  - DRAINAGE DITCH
- NAVIGATION**
- DOCK, PIER, OR LANDING
- STRUCTURES**
- HIGHWAY BRIDGE, GENERAL
  - HIGHWAY GRADE SEPARATION
  - DAM WITH ROAD
  - MINOR DRAINAGE STRUCTURE
  - CONCRETE FORD OR DIP
  - FORD - ROAD ESTABLISHED

- GENERAL LEGEND**
- BOUNDARIES**
- COUNTY LINE
  - TOWNSHIP LINE
  - CORPORATE LINE
  - SECTION LINE
  - MATCH LINE BETWEEN ADJOINING SHEETS OF SAME COUNTY
  - BOUNDARY TO MARK ENLARGEMENT INSET
  - NATIONAL REFUGES
  - MONUMENT - SMALL, HISTORIC SITE
  - WILDLIFE MANAGEMENT AREA
  - WATERFOWL PRODUCTION AREA
  - STATE PARKS
  - STATE SCHOOL LAND
- CITY AND VILLAGE CENTERS**
- COUNTY SEAT
  - OTHER CITIES AND VILLAGES
  - INCORPORATED CITY OR VILLAGE (GENERALIZED)
- INDUSTRIAL**
- STORE OR SMALL BUSINESS ESTABLISHMENT
  - FACTORY OR INDUSTRIAL PLANT
  - OIL TANK
  - GROUP OF STORAGE TANKS (OIL OR GAS)
  - PUMPING STATION (OIL OR GAS)
  - WAREHOUSE - GENERAL
  - GRAIN ELEVATOR
  - STOCK YARD - LOADING PEN OR CORRAL
  - GRAVEL PIT
- FARM UNITS, DWELLINGS, ETC.**
- FARM UNIT (FARM UNITS SHOWN IN MUNICIPAL LIMITS INDICATE FARM BUILDINGS FOR FARM USE)
  - DWELLING OTHER THAN FARM
  - ROWS OR GROUPS OF DWELLINGS CLOSELY SPACED (FIGURE DENOTES NUMBER OF DWELLINGS)
  - BARRACKS, OR DORMATORIES FOR STUDENTS, WORKERS, MIGRANTS, ETC.
  - SEASONAL OR SUMMER COLONY DWELLING
  - SEASONAL DWELLINGS CLOSELY SPACED
  - DAM WITH ROAD
  - MINOR DRAINAGE STRUCTURE
  - CHURCH
  - CEMETERY
  - CHURCH WITH CEMETERY ADJACENT
  - WELL
  - TENANT HOUSE
- EDUCATIONAL AND CORRECTIONAL INSTITUTIONS**
- SCHOOLHOUSE
  - TOWNSHIP, GRANGE, OR COMMUNITY HALL
  - STATE PRISON FARM
- PUBLIC SERVICE FACILITIES**
- POST OFFICE
  - HIGHWAY GARAGE
  - FIRE ENGINE HOUSE
  - GARBAGE OR RUBBISH DUMP
  - SEWAGE DISPOSAL PLANT
  - AUTOMOBILE GRAVEYARD
  - SCRAP METAL
  - WATER SUPPLY STAND PIPE OR TANK
  - POWER SUBSTATION
  - BOOSTER STATION
  - COMMUNICATION TOWER
  - MUNICIPAL BUILDING
  - COURTHOUSE
- CONSERVATION AND RECREATION**
- PICNIC GROUND
  - PLAYGROUND, BALL FIELD, ETC.
  - BATHING BEACH OR SWIMMING POOL
  - SCENIC SITE
  - CAMP SITE, NO PERMANENCE (TENTS OR TRAILER PARKING)
  - TOURIST COURT, OR MOTEL
  - CAMP OR LODGE
  - PERMANENT SITE WITH BUILDINGS
  - REST AREA
  - GOLF GROUND OR COUNTRY CLUB
  - AMUSEMENT PARK OR HALL
  - FAIR GROUND, RACE COURSE, SPEEDWAY
  - FISH HATCHERY
  - BIRD SANCTUARY
  - RIFLE CLUB
  - RIDING ACADEMY
- MISCELLANEOUS**
- TRIANGULATION STATION
  - FORT, ARMY CAMP, BARRACKS, OR OTHER MILITARY POST
  - DOT TO INDICATE LOCATION OF ANY CULTURAL FEATURE SHOWN OUT OF POSITION
  - ALL VACANT CULTURE INDICATED
  - LATITUDE AND LONGITUDE 47°00'

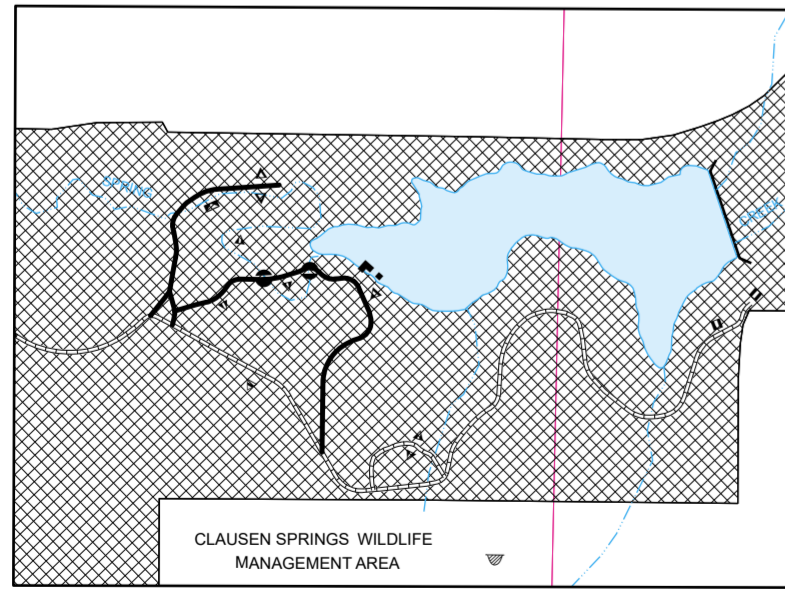

**CLAUSEN SPRINGS**  
SEC'S. 17, & 18, T. 137 N., R. 58 W.

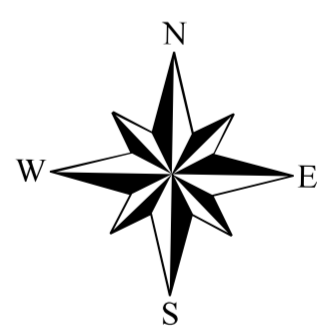
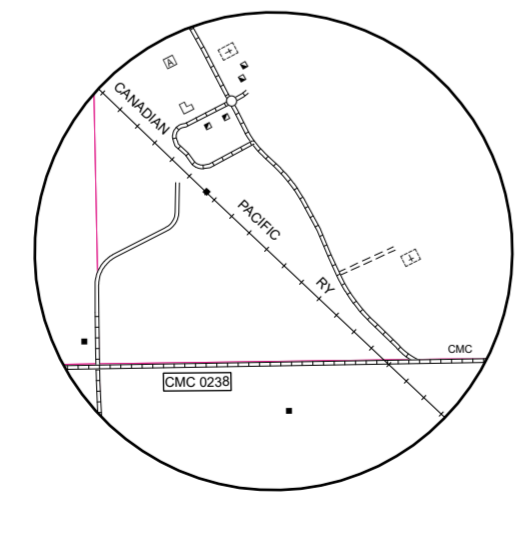

**LUCCA**  
SEC'S. 2, 3, 10, & 11, T. 137 N., R. 56 W.

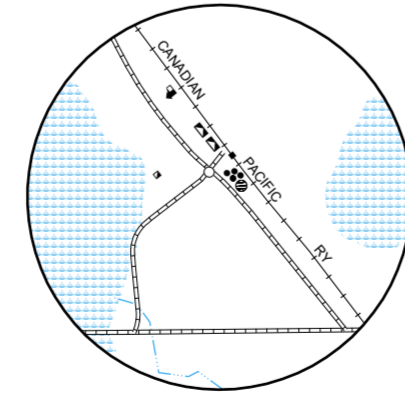

**CUBA**  
SEC'S. 27, & 34, T. 139 N., R. 57 W.

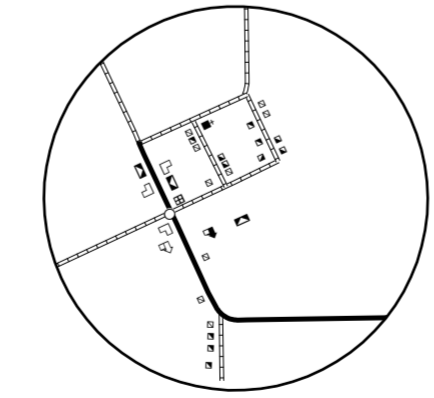

**HASTINGS**  
SEC. 14, T. 137 N., R. 59 W.

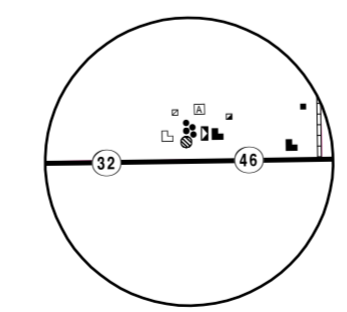

**INSET NO. 1**  
SEC. 2, T. 136 N., R. 56 W.  
SEC. 36, T. 137 N., R. 56 W.

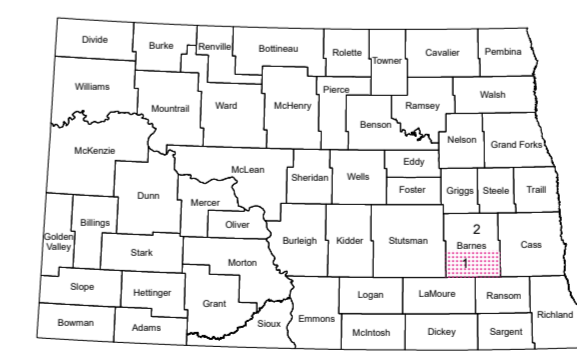

STATE OF NORTH DAKOTA  
DIAGRAM OF COUNTIES

# GENERAL HIGHWAY MAP BARNES COUNTY NORTH DAKOTA

PREPARED BY THE  
NORTH DAKOTA DEPARTMENT OF TRANSPORTATION  
PLANNING / ASSET MANAGEMENT DIVISION  
IN COOPERATION WITH THE  
U.S. DEPARTMENT OF TRANSPORTATION  
FEDERAL HIGHWAY ADMINISTRATION

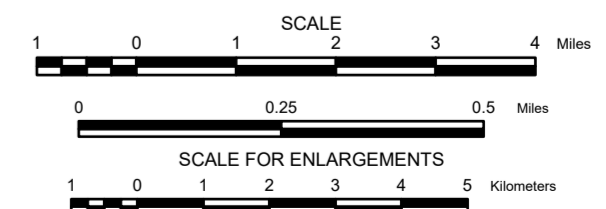

BASED ON AERIAL PHOTOGRAPHY OF 1954 AERIAL INVENTORY OF 2016  
**2021** UNIVERSAL TRANSVERSE MERCATOR ZONE 14 NORTH AMERICAN DATUM 83

**Notice of Disclaimer**  
The North Dakota Department of Transportation (NDDOT) makes this map available on an "as is" basis as a public service. Under no circumstances does NDDOT warrant or certify the information to be free of errors or deficiencies of any kind. NDDOT specifically disclaims all warranties, express or implied, including but not limited to the warranties of merchantability and fitness for a particular purpose.