

SIGN PUNCHING, STRINGER AND SUPPORT LOCATION DETAILS -
DIVIDED HIGHWAY CONTROL SIGNS

Notes:

1. Use 0.100 inch minimum thickness sign backing material.
2. Use 1½"x1½" perforated square tube stringers.
3. Punch holes round for ⅜" bolt.
4. Assemblies 447 and 448 have single one way signs.
Assemblies 451 and 452 have back to back one way signs.

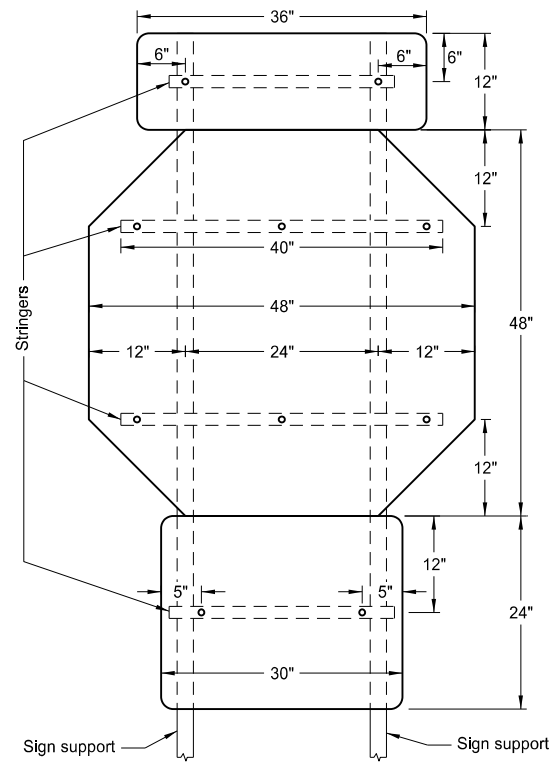

2 Posts

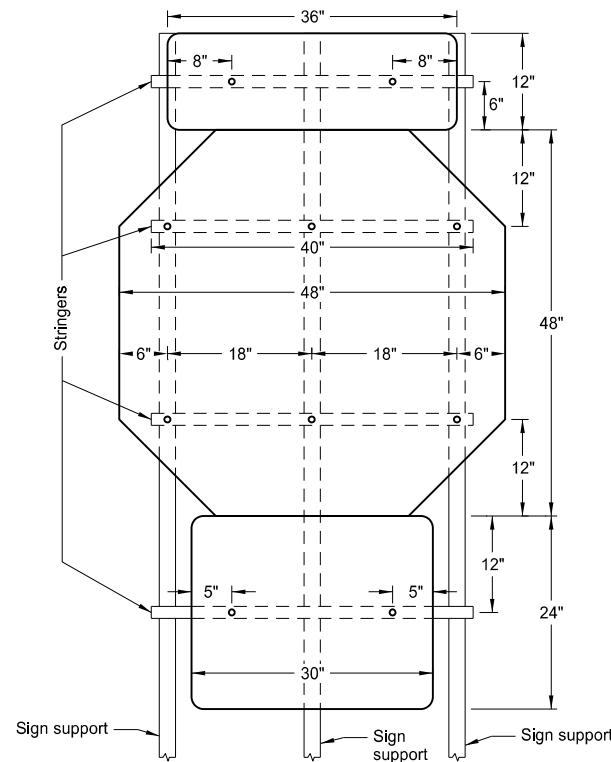

3 Posts

ASSEMBLY NO. 447 & 451

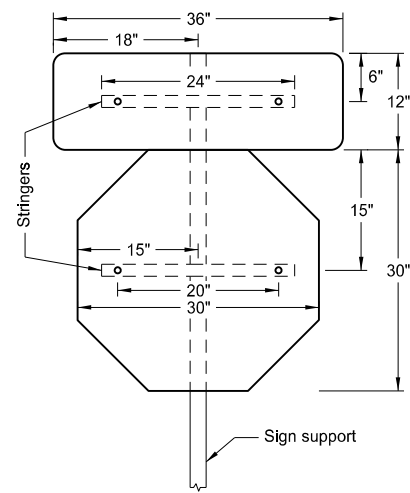

1 Post

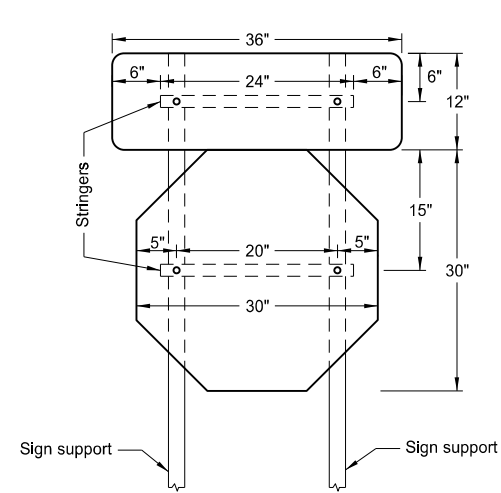

2 Posts

ASSEMBLY NO. 448 & 452

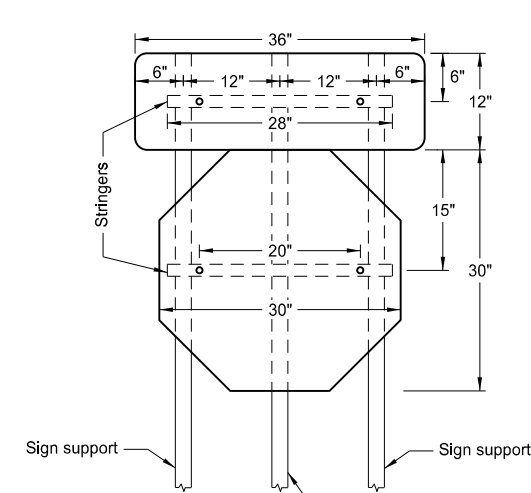

3 Posts

NORTH DAKOTA DEPARTMENT OF TRANSPORTATION	
8-22-12	
REVISIONS	
DATE	CHANGE
8-30-18	Updated notes to active voice.
9-05-19	New Design Engineer PE Stamp.

This document was originally issued and sealed by
Kirk J Hoff,
Registration Number
PE- 4683,
on 9/05/19 and the original document is stored at the
North Dakota Department
of Transportation