

SIGN PUNCHING, STRINGER AND SUPPORT LOCATION DETAILS -  
DIVIDED HIGHWAY CONTROL SIGNS

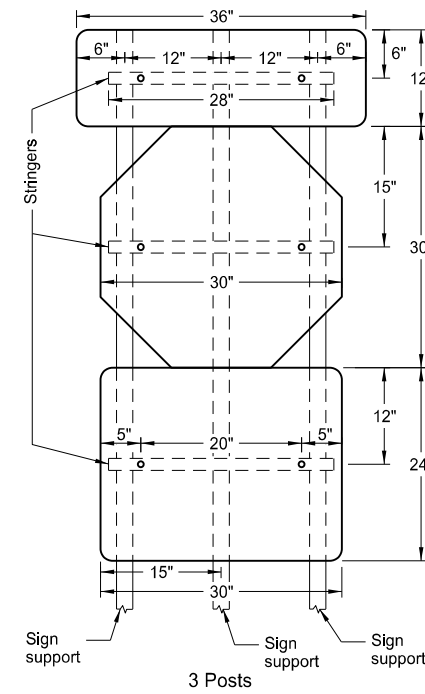

ASSEMBLY NO. 445 & 449

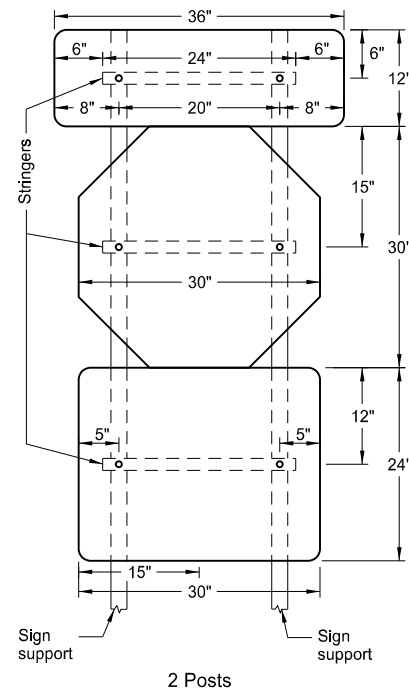
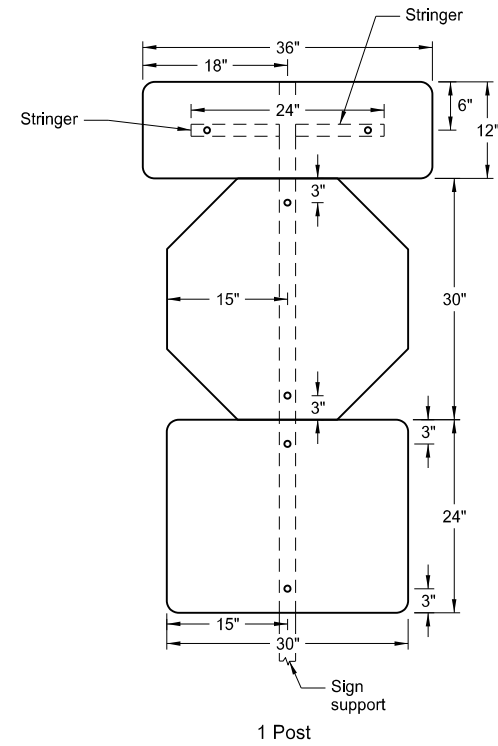
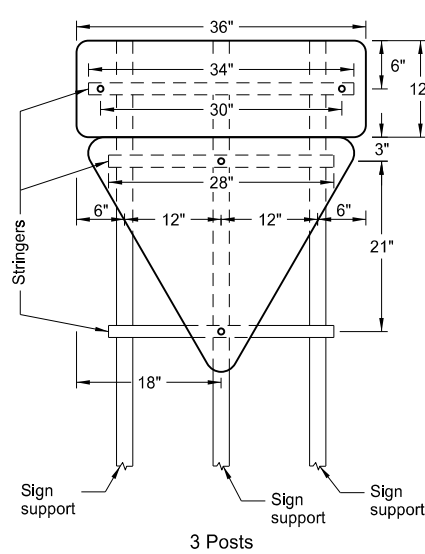
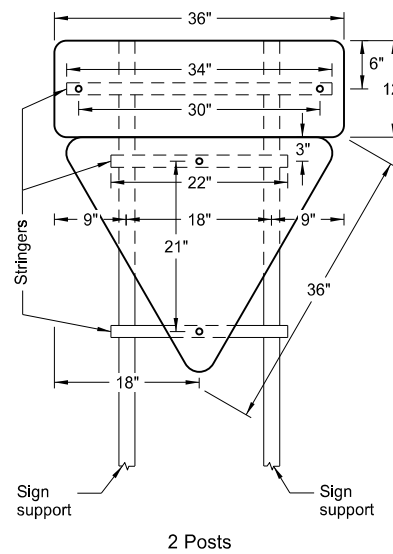
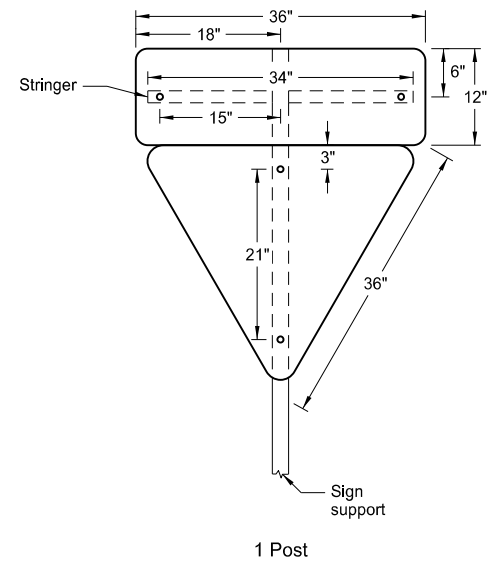

ASSEMBLY NO. 446 & 450

Notes:

1. Use 0.100 inch minimum thickness sign backing material.
2. Use 1½"x1½" perforated square tube stringers.
3. Punch holes round for ⅜" bolt.
4. Assemblies 445 and 446 have single one way signs.  
Assemblies 449 and 450 have back to back one way signs.

NORTH DAKOTA DEPARTMENT OF TRANSPORTATION	
8-22-12	
REVISIONS	
DATE	CHANGE
8-30-18	Updated to active voice & added Assembly 446 & 450 dimension.
9-05-19	New Design Engineer PE Stamp.

This document was originally issued and sealed by  
Kirk Hoff  
Registration Number  
PE- 4683,  
on 9/05/19 and the original document is stored at the North Dakota Department of Transportation