

# NDDOT Material Source Certificate of Approval

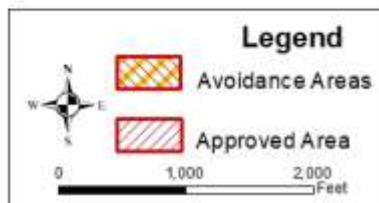

**BA-1133**

**Pit Name:**  
**Wendell**

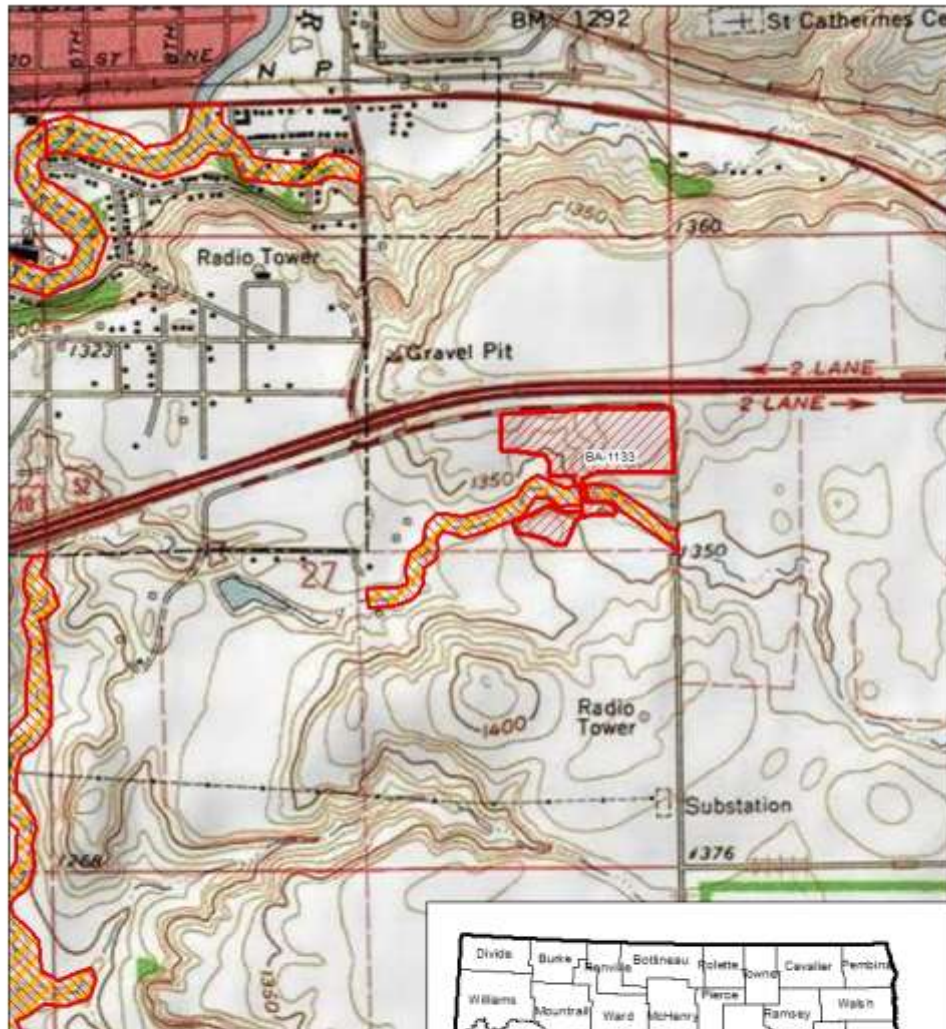

**S1/2NE1/4**

**S. 27 T. 140 N, R 58 W**

**County:**

**Barnes**

**Conditions:** For stockpiling, plant/staging area and for wasting excess material.

This location is approved for use, provided all avoidance areas shown on the map are avoided and all Conditions listed above and below are complied with.

NDDOT advises that all applicants (contractors or their representatives) may be subject to meeting certain legal responsibilities pursuant to one or more of the following authorities administered by the USFWS: Migratory Bird Treaty Act (MBTA) (16 U.S.C. 703 et seq.); Endangered Species Act (ESA) (16 U.S.C. 1531 et seq.); and Bald and Golden Eagle Protection Act (BGEPA) (16 U.S.C. 668-668d, 54 Stat. 250). It is the responsibility of the applicants and/or any individual conducting activities at any approved site to fulfill the requirements of these Acts. The contractor will be responsible obtaining all applicable permits outlined in Section 107 of the Standard Specifications for Road and Bridge Construction (SSRBC). Additionally, contractor will be responsible for any impacts to wetlands, including permitting those impacts and mitigating the loss of the wetlands. As with all projects, if cultural artifacts and/or features (e.g., stone tools, fire hearths, stone circles, burials) are encountered, provisions outlined in Section 107.06 of SSRBC shall be followed.

This approval does not imply landowner permission to acquire material at this location. An agreement with the landowner is still necessary. If you have any questions regarding material sources please email [materialsource@nd.gov](mailto:materialsource@nd.gov)