

CONSTRUCTION SIGNING MEDIAN CROSSOVER
2000 ADT OR LESS

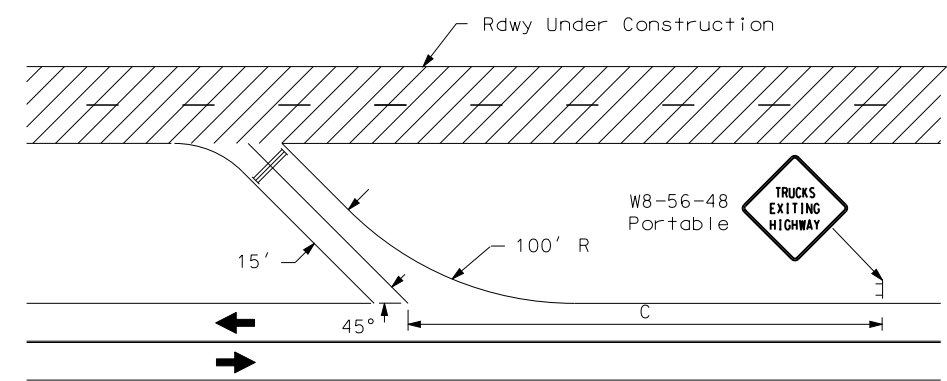
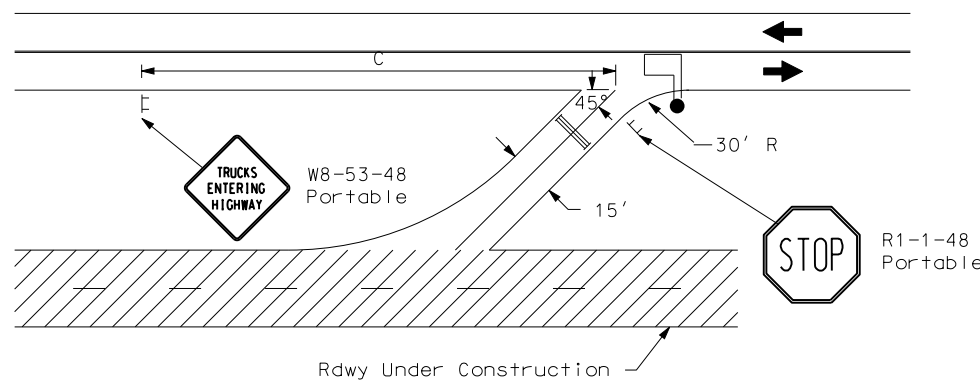
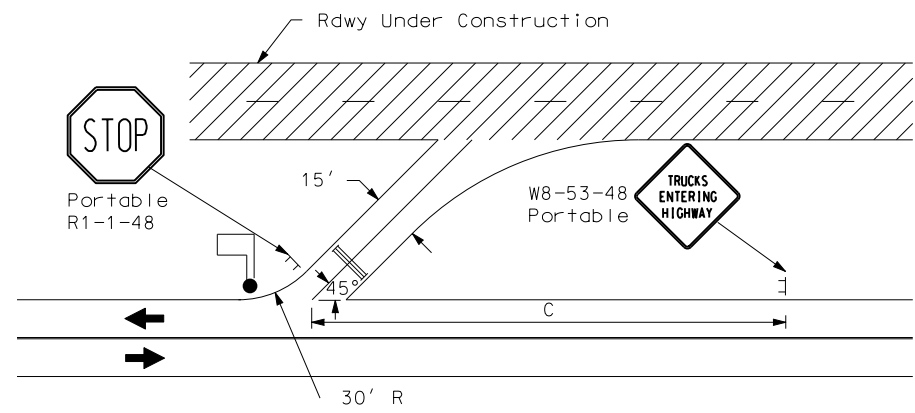
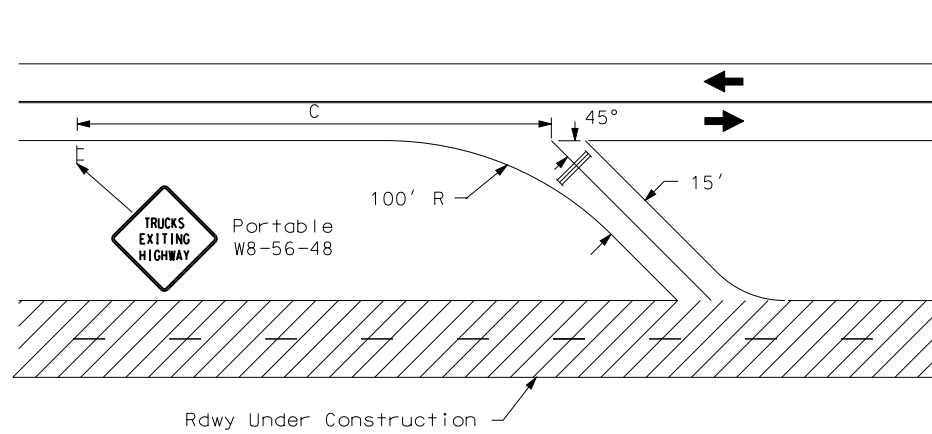

1. Flagger shall not be used to slow interstate traffic. Flagger is intended to assist truck driver in viewing oncoming traffic for the truck's safe entry into traffic. Barricades shall be installed on the median access when not in use. The barricades shall be placed at 45 degrees away from approaching traffic.
2. The contractor has the option of using portable sign supports in lieu of post mounted sign as shown on the standard drawings as specified in section 704.03 C.

Road Type	Distance Between Signs Min. (ft)		
	A	B	C
Urban - Low Speed (30 mph or less)	150	150	150
Urban - Low Speed (over 30 to 40 mph)	280	280	280
Urban - High Speed (over 40 mph to 50 mph)	360	360	360
Rural - High Speed (over 50 mph to 65 mph)	720	720	720
Urban Expressway and Freeway (55 mph to 60 mph)	850	1350	2200
Rural Expressway and Freeway (70 mph to 75 mph)	1000	1500	2640
Interstate/4-Lane Divided (Maintenance and Surveying)	750	1000	1500

KEY	
	Type I barricade
	Type II barricade
	Type III barricade
	Sign
	Delineator drum
	Cones
	Work area
	Flagger
	Sequencing arrow panel
	Type A delineator or vertical panels back to back

NORTH DAKOTA DEPARTMENT OF TRANSPORTATION	
10-01-99	
REVISIONS	
DATE	CHANGE
04-01-04	Rev warning sign spacing
12-01-04	PE Stamp added
06-29-05	Rev. Adv. Warning Table

This document was originally issued and sealed by
MARK S. GAYDOS
Registration Number
PE- 4518 ,
on 06/29/05 and the original document is stored at the
North Dakota Department
of Transportation