

DESIGN DATA				
Traffic	Average Daily			Max.Hr.
Current 2025	Pass: <750	Trucks: -	Total: <750	
Forecast	Pass:	Trucks:	Total:	
Clear Zone Distance: -	Design Speed: 55 M.P.H.			
Minimum Sight Dist. for Stopping: 495 FT				
Minimum Sight Dist. for Safe Passing: -				
Sight Dist. for No Passing Zone: 900 FT				

JOB # 24678
BENSON COUNTY
NORTH DAKOTA

FEDERAL AID PROJECT
SC-0341(001)

STATE	PROJECT NO.	PCN	SECTION NO.	SHEET NO.
ND	SC-0341(001)	24678	1	1

GOVERNING SPECIFICATIONS	Date Published and Adopted by the North Dakota Department of Transportation
Standard Specifications	7/1/2025
Supplemental Specifications	NONE

1" MILL, HMA OVERLAY, AND INCIDENTALS

CMC 0341: 6 Miles West of Tokio, thence South 5 Miles to the Benson County Line

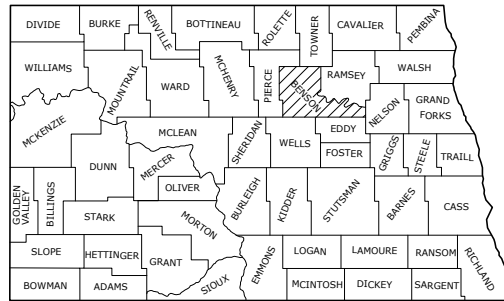

END PROJECT SC-0341(001)
 STA. 265+22.24 = THE NW CORNER OF
 SEC. 12, TWP. 151-N, RGE. 65-W

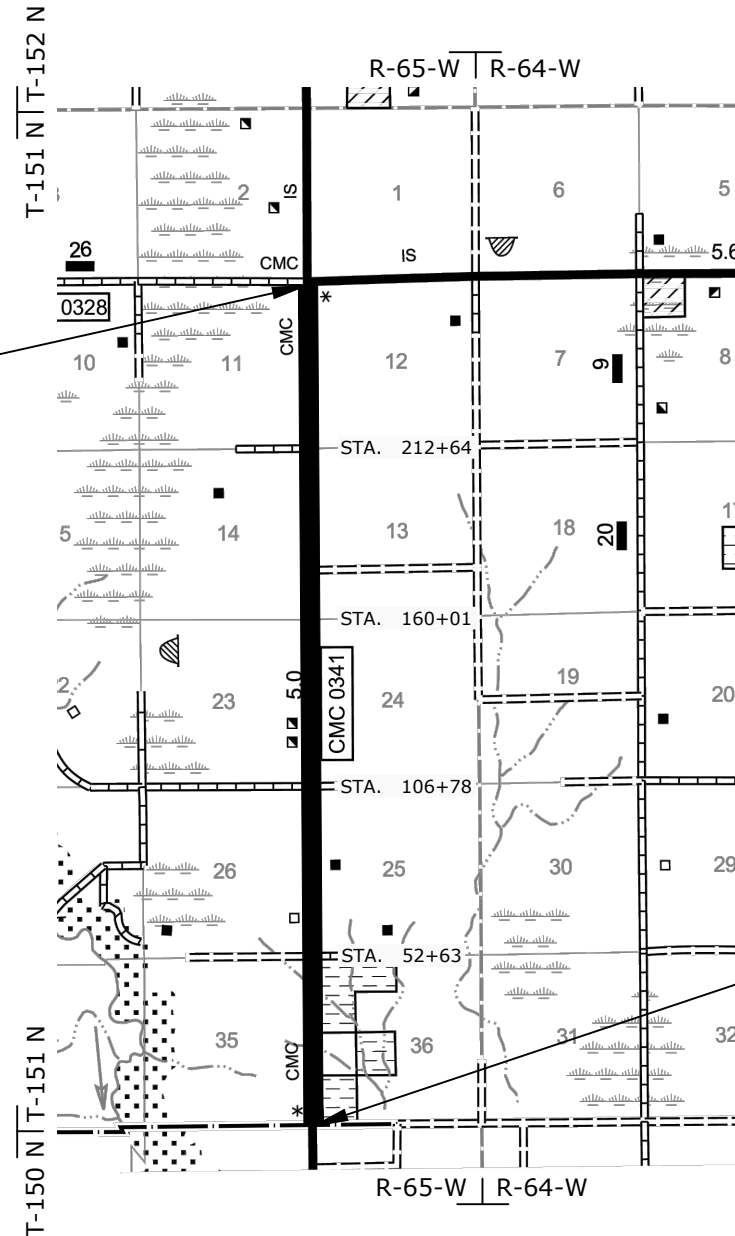

BEGIN PROJECT SC-0341(001)
 STA. 0+00 = THE SW CORNER OF
 SEC. 36, TWP. 151-N, RGE. 65-W

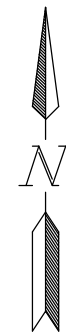

SKETCH MAP OF BENSON COUNTY

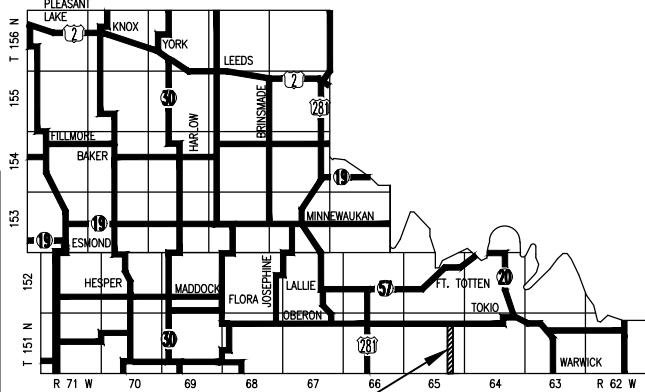

PROJECT LOCATION

DESIGNER Jesse R. Brandvold P.E.
DESIGNER Jessica D. Tagestad P.E.
DESIGNER
DESIGNER

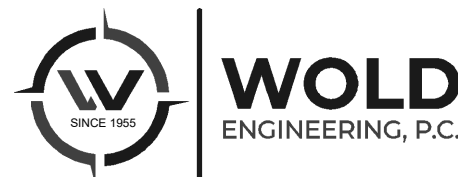

I hereby certify that the attached plans were prepared by me or under my direct supervision and that I am a duly registered professional engineer under the laws of the state of ND.

APPROVED DATE 08/27/2025

 Jesse R. Brandvold, P.E. /s/

Wold Engineering, P.C.

This document was originally issued and sealed by
 Jesse R. Brandvold,
 Registration Number
 PE-40107
 on 08/27/25 and the original document is stored at
 Wold Engineering, P.C.
 Bottineau, North Dakota

TABLE OF CONTENTS

	STATE	PROJECT NO.	SECTION NO.	SHEET NO.
	ND	SC-0341(001)	2	1

PLAN SECTIONS

LIST OF STANDARD DRAWINGS

Section	Page(s)	Description
1	1	Title Sheet
2	1	Table of Contents
6	1 - 3	Notes
8	1	Quantities
10	1	Basis of Estimate
20	1	General Details
30	1	Typical Sections
100	1 - 2	Work Zone Traffic Control
110	1 - 2	Signing
120	1	Pavement Marking

Number	Description
D-101-1, 2,3,4	NDDOT Abbreviations
D-101-10	NDDOT Utility Company and Organization Abbreviations
D-101-20, 21	Line Styles
D-101-30, 31,32,33	Symbols
D-704-7	Breakaway Systems For Construction Zone Signs - Perforated Tube
D-704-8	Breakaway Systems For Construction Zone Signs - U-Channel Post
D-704-9	Construction Sign Details - Terminal And Guide Signs
D-704-10	Construction Sign Details - Regulatory Signs
D-704-11, 11A	Construction Sign Details - Warning Signs
D-704-13	Barricade And Channelizing Device Details
D-704-14	Construction Sign Punching And Mounting Details
D-704-15	Road Closure Layouts
D-704-20	Terminal And Seal Coat Sign Layouts
D-704-22	Construction Truck And Temporary Detour Layouts
D-704-26	Miscellaneous Sign Layouts
D-704-27	Mobile Operation (Pavement Marking)
D-704-50	Portable Sign Support Assembly
D-706-1	Bituminous Laboratory
D-754-26, 27,29,37	Sign Punching, Stringer and Support Location Details Regulatory, Warning and Guide Signs
D-754-51	Sign Punching, Stringer and Support Location Details - Route Marker Signs
D-754-86	911 Sign Support Information And Sign Details
D-754-87	Sign Punching, Stringer And Support Location Details For Street Name Signs And 911 Signs
D-760-5	Saw Slotted Rumble Strips At Intersections
D-762-1	Pavement Marking Message Details
D-762-4	Pavement Marking

NOTES

STATE	PROJECT NO.	SECTION NO.	SHEET NO.
ND	SC-0341(001)	6	1

- 100-P01 WORK SCHEDULE: The project as a whole will be completed by October 17, 2026.
- 100-P02 PAVEMENT PROTECTION: The Contractor will protect the existing pavement. The Contractor, at the Contractor's expense, will repair any pavement damaged due to their operations before the project will be accepted. Repairs may include, but are not limited to sawing, removals and additional hot bituminous pavement to damaged areas.
- 105-P01 TYPICAL SECTION: The dimensions shown for the bituminous pavement course are approximate. Plan quantities will be placed throughout except where the Engineer authorizes a change.
- 107-P01 HAUL ROADS: The Contractor will contact the appropriate Tribal, State, County, Township or City officials to determine if there are any No Haul Routes or Restricted Routes prior to preparing a bid for this project. All haul routes must be approved in writing by the local agency and approved by the Engineer. The gross vehicle weight on all county and township roads will not exceed the legal load limits unless approved by the local agency.
- 107-P02 ENVIRONMENTAL PROTECTION: Any land used by the Contractor outside the Right-of-Way limits, for any purpose, must be approved by the landowner and the Project Engineer.
- 107-P03 LAWS TO BE OBSERVED: All or a portion of this project lies within the exterior boundaries of an Indian Reservation. Review law and ordinances pertaining to the work contained within the boundaries of the reservation.
- 108-500 TERO COORDINATION: Invite Tribal TERO Office to the Pre-construction Conference.
- 230-P01 SHOULDER PREPARATION: All vegetation that is within 4 feet of the asphalt shoulder will be chemically killed as per NDDOT Std. Specs. Sec. 230.04 B. The Contractor will mow the grass shoulders a minimum of ten (10) feet beyond the pavement edge and to a height not greater than three (3) inches just prior to application of the herbicide. All material and costs associated with "Shoulder Preparation" will be included in the project as a whole.
- 411-P01 MILLING PAVEMENT SURFACE: Mill bituminous material to a maximum size of 5/8 inch. Use the milled bituminous material as recycle for "RAP SUPERPAVE FAA 42". All costs for labor and equipment to mill, haul, and stockpile the material will be included in the unit price for "Milling Pavement Surface". Any excess milled material will remain property of Benson County.

- 411-P02 MILLING PAVEMENT SURFACE: The Contractor will mill areas as indicated on plan. Payment for milling will be by the square yard based on widths shown on the basis of estimate. The remaining millings not used for "RAP Superpave FAA 42" will become the property of the Contractor. All costs associated with salvaging and delivering the millings will be included in the price bid for "Milling Pavement Surface".
- 411-P03 TEMPORARY ASPHALT WEDGES: The Contractor will place temporary asphalt or milled material wedges at the milled taper locations to allow for the smooth passage of vehicles. All costs for labor, materials, and equipment to install and remove the wedges will be included in the unit price bid for "Milling Pavement Surface".
- 430-P01 RAP INCORPORATED MIX DESIGN: The mix design will be Contractor developed with the aggregate and asphalt to be used on the project. Incorporate RAP into the mix at a minimum rate of 20 percent. The mix design will be done in the manner specified in NDDOT Standard Specification Section 430, prior to the start of the paving operation. The Contractor will submit a HMA mix design to the Engineer 10 days prior to the start of the construction. This cost will be included in the unit price bid for "RAP Superpave FAA 42".
- 430-P02 RAP SUPERPAVE FAA 42: The Contractor may substitute RAP Superpave FAA 43 or greater if approved by the Engineer. No additional compensation will be allowed.
- 430-P03 COMPACTION: Compaction of hot mix asphalt will be in accordance to NDDOT Standard Specification Section 430.04 I.3 Ordinary Compaction. The compaction equipment used will include not less than two vibratory rollers.
- 430-P04 PG ASPHALT ACCEPTANCE: The Engineer will accept asphalt cement as outlined in the Combined State Binder Group agreement for North Dakota. The asphalt cement supplier will provide manifests as outlined in the Combined State Binder Group agreement for North Dakota, but no asphalt cement samples or testing will be required at the point of delivery.
- 430-P05 HOT MIX ASPHALT: "RAP Superpave FAA 42" will have the aggregate and mix design properties as shown in Table 430-03, with this exception – the number of gyrations used in the mix design will be 50, as well as $N_{initial}=6$ and $N_{max}=75$.
- 430-P06 APPROACH PAVING: The approaches will be paved prior to or concurrent with the placement of the mainline top lift. An adequate transition to match existing conditions will be required.
- 430-P07 ADJACENT LIFTS: In patch repair areas, the previous lift will be allowed to cure prior to paving the next lift.

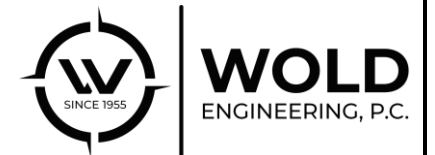

This document was originally issued and sealed by Jesse R. Brandvold, Registration Number PE-40107 on 08/27/25 and the original document is stored at Wold Engineering, P.C. Bottineau, North Dakota

STATE	PROJECT NO.	SECTION NO.	SHEET NO.
ND	SC-0341(001)	6	2

NOTES

704-P01 TRAFFIC CONTROL FOR UNEVEN PAVEMENT: The Contractor has the option of making the paving lanes even at the end of each day's paving operation or signing for the uneven pavement and providing the following devices: Install "Uneven Lanes" signs (Sign No. W8-11-48) and a supplemental plate (Sign No. W20-52-54), identifying the distance, on the right shoulder (both directions) in advance of the beginning of the uneven pavement and at major intersections. A major intersection will be defined as a CMC, state, U.S. highway, or Interstate ramp. Install "Do Not Pass" signs (Sign No. R4-1-48) on the right shoulder (both directions) between the uneven lanes sign and the beginning of the uneven pavement and at major intersections. Install tubular markers spaced at two times the posted speed limit on the centerline where uneven pavement exists.

These traffic control devices will be left in place until the lanes are even. These signs and tubular markers are included in the "Traffic Control Devices List" and will be measured and paid for at the contract unit price for each device. No extra compensation will be allowed for relocation due to work progression.

704-P02 TRAFFIC CONTROL: Traffic control for the paving will consist of a temporary road closure, flagging, and a pilot car. Traffic Control Devices will comply with the following Standard Drawings:

1. Standard D-704-15, layout A: For temporary roadway closure during paving operations.
2. Standard D-704-20, layout G: For construction signing during paving operations. Sign G20-1b-60 will not be required. Signs R2-1-48 and R2-1a-24 are to be moved as the work area moves through the construction zone and should be placed a minimum of 500 feet in advance of flagging signs. Signs will be required at the junctions shown on the Traffic Control Layout.
3. Standard D-704-22, layouts K and L: For trucks hauling material.
4. Standard D-704-26, layouts CC, EE, and GG: For paving operations.
5. Standard D-704-7,8,9,10,11,13, and 14 are applicable.

The required traffic control signs and devices are included in the "Traffic Control Devices List" and will be measured and paid at the contract unit price for each device.

The Department will pay for all necessary deployed devices, regardless of the length of the lane closure.

704-P03 TRAFFIC CONTROL DURING WORKING AND NON-WORKING HOURS: The Contractor will maintain one lane of traffic at the posted speed limit at all times during working hours. During non-working hours, the Contractor will leave the work area free of all hazards. The Contractor will open the roadway to two-way traffic during non-working hours. A minimum 24 foot roadway width will be required to maintain two lanes of traffic.

During paving and milling operations, flagging and pilot car will be used to maintain traffic during working hours. The traffic control devices for flagging will be removed at the end of each day and reinstalled when work commences.

704-P04 COVER SIGNS: Existing signs requiring covering will be covered with durable covering such as plywood or pressed board so that no damage is done to the sign face. If any damage is done, the signs will be replaced at the Contractor's expense. Alternate methods of covering may be used if approved by the Engineer. The cost of providing material and covering existing signing will not be bid separately but will be included in the traffic control items.

704-500 PORTABLE RUMBLE STRIPS (PRS): Use PRS made of rubber or engineered polymers.

Install PRS that meet the following criteria:

- Have no adhesives or fasteners required for placement;
- Have a manufacture's speed rating that meets or exceeds the posted speed limit; and
- Each strip in the array must weigh a minimum of 100 pounds.

Use individual PRS constructed in one of the following manners:

- A single piece;
- Inter locking segments; or
- Two pieces hinged at the midpoint.

An Install array of PRS consists of a minimum of 3 individual strips.

Move rumble strips with flagging operation. Do not place rumble strips on horizontal curves.

The Engineer will count and measure each array as one unit. Include the cost of providing, installing, maintaining, and relocating PRS in the unit price bid for "Portable Rumble Strips"

754-P01 STOP & YIELD SIGNS – REFLECTIVE STRIPS: Install 2-inch-wide red reflective strips on the side of the support that faces the same direction.

Use reflective material that meets the requirements of Section 894.02 E, "Type XI Retroreflective Sheeting".

Install the strips on STOP & YIELD signs at the following locations:

- Sta. 106+00 LT - "YIELD"
- Sta. 264+10 RT - "STOP"
- Sta. 264+45 LT – "STOP"

Include the cost of furnishing and installing retroreflective strips in the contract unit price for "Steel Galvanized Posts – Telescoping Perforated Tube".

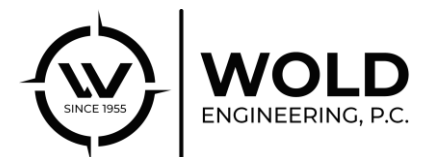

This document was originally issued and sealed by
Jesse R. Brandvold,
Registration Number
PE-40107
on 08/27/25 and the original document is stored at
Wold Engineering, P.C.
Bottineau, North Dakota

NOTES

STATE	PROJECT NO.	SECTION NO.	SHEET NO.
ND	SC-0341(001)	6	3

762-P01 SHORT-TERM PAVEMENT MARKING: The short-term application will be applied immediately following completion of the paving operation on the entire mainline. No intermediate application will be necessary while Sign No. W8-12-48, "No Center Stripe", is in place. Short-Term Pavement Marking will not be field measured unless the Engineer authorizes a change in the field, and will be paid for at plan quantity.

762-P02 PERMANENT PAVEMENT MARKINGS: Permanent pavement markings will be placed no sooner than 14 days and no later than 21 days after completion of the paving.

762-P03 PAVEMENT MARKINGS EDGE LINES: Edge lines will be continued through private drives and broken at intersections and will be placed only upon completion of the pavement overlay.

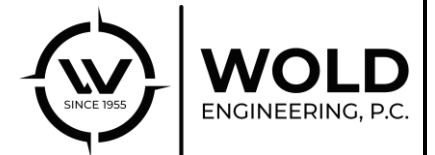

This document was originally issued and sealed by
Jesse R. Brandvold,
Registration Number
PE-40107
on 08/27/25 and the original document is stored at
Wold Engineering, P.C.
Bottineau, North Dakota

Estimated Quantities

STATE	PROJECT NO.	SECTION NO.	SHEET NO.
ND	SC-0341(001)	8	1

SPEC	CODE	ITEM DESCRIPTION	UNIT	Mainline:	Approaches:	TOTAL
103	0100	CONTRACT BOND	L SUM	1		1
302	0120	AGGREGATE BASE COURSE CL 5	TON		195	195
401	0050	TACK COAT	GAL	7735	104	7839
411	0105	MILLING PAVEMENT SURFACE	SY	79564		79564
430	0142	RAP - SUPERPAVE FAA 42	TON	12494	545	13039
430	5815	PG 58S-34 ASPHALT CEMENT	TON	775	36	811
702	0100	MOBILIZATION	L SUM	1		1
704	0100	FLAGGING	MHR	600		600
704	1000	TRAFFIC CONTROL SIGNS	UNIT	1162		1162
704	1048	PORTABLE RUMBLE STRIPS	EA	2		2
704	1067	TUBULAR MARKERS	EA	250		250
704	1185	PILOT CAR	HR	300		300
706	0550	BITUMINOUS LABORATORY	EA	1		1
706	0600	CONTRACTOR'S LABORATORY	EA	1		1
754	0110	FLAT SHEET FOR SIGNS-TYPE XI REFL SHEETING	SF	44		44
754	0112	FLAT SHEET FOR SIGNS-TYPE IV REFL SHEETING	SF	31		31
754	0206	STEEL GALV POSTS-TELESCOPING PERFORATED TUBE	LF	199		199
754	0592	RESET SIGN PANEL	EA	7		7
760	0010	RUMBLE STRIPS - INTERSECTION	SET	1		1
762	0103	PVMT MK PAINTED-MESSAGE	SF	52		52
762	0430	SHORT TERM 4IN LINE-TYPE NR	LF	27493		27493
762	1106	PVMT MK PAINTED 6IN LINE	LF	80538		80538
762	1124	PVMT MK PAINTED 24IN LINE	LF	14		14

STATE	PROJECT NO.	SECTION NO.	SHEET NO.
ND	SC-0341(001)	10	1

BASIS OF ESTIMATE - ROADWAY

STA. 0+00 TO STA. 265+22.24 (5.023 miles)					
QUANTITY PER MILE	WIDTH	TOTAL	UNIT	DESCRIPTION	
15,840	27'	79,564	SY	MILLING PAVEMENT SURFACE (1")	
750	25.5'	3,757	GAL	EMULSIFIED ASPHALT FOR TACK COAT AT 0.05 GAL/SY (BASE COURSE)	
1,209	24'	6,070	TON	RAP SUPERPAVE FAA 42 HOT BITUMINOUS PAVEMENT AT 2.0 TON/CY (1.5" BASE COURSE)	
75	24'	377	TON	PG58S-34 ASPHALT CEMENT FOR SUPERPAVE FAA 42 AT 6.2% (1.5" BASE COURSE)	
792	27'	3,978	GAL	EMULSIFIED ASPHALT FOR TACK COAT AT 0.05 GAL/SY (SURFACE COURSE)	
1,279	24'	6,424	TON	RAP SUPERPAVE FAA 42 HOT BITUMINOUS PAVEMENT AT 2.0 TON/CY, 1.5" SLOUGH (1.5" SURFACE COURSE)	
79	24'	398	TON	PG58S-34 ASPHALT CEMENT FOR SUPERPAVE FAA 42 AT 6.2%, 1.5" SLOUGH (1.5" SURFACE COURSE)	

BASIS OF ESTIMATE - APPROACHES

DESCRIPTION	UNIT	SECTION LINE	PRVATE DR	FIELD	TOTAL
NUMBER OF LOCATIONS	#	3	4	25	32
AGGREGATE BASE COURSE CL 5	TON	10	10	5	195
TACK COAT	GAL	10	6	2	104
RAP SUPERPAVE FAA 42	TON	30	20	15	545
PG 58S-34 ASPHALT CEMENT	TON	2	1.3	1	36

BASIS OF ESTIMATE - MARKING

PAVEMENT MARKING PAINTED LINE (PERMANENT)			
CENTERLINE: 6" YELLOW, 10 FT. LINES, 30 FT. SKIP 1320 LF/MILE			
BARRIER LINES: 6" YELLOW 4" BETWEEN LINES			
EDGE LINE: 6" WHITE 10,560 LF/MILE			
BARRIER:			
STA. 0+00 TO STA. 28+00 RT	=	2,800 LF	STA. 143+00 TO STA. 153+00 LT = 1,000 LF
STA. 11+00 TO STA. 38+00 LT	=	2,700 LF	STA. 167+50 TO STA. 177+50 RT = 1,000 LF
STA. 38+50 TO STA. 46+50 RT	=	800 LF	STA. 177+50 TO STA. 187+50 LT = 1,000 LF
STA. 48+50 TO STA. 56+50 LT	=	800 LF	STA. 186+00 TO STA. 193+00 RT = 700 LF
STA. 50+00 TO STA. 58+00 RT	=	800 LF	STA. 196+00 TO STA. 203+00 LT = 700 LF
STA. 60+00 TO STA. 68+00 LT	=	800 LF	STA. 198+00 TO STA. 204+00 RT = 600 LF
STA. 74+50 TO STA. 79+50 RT	=	500 LF	STA. 208+00 TO STA. 214+00 LT = 600 LF
STA. 84+50 TO STA. 89+50 LT	=	500 LF	STA. 228+00 TO STA. 236+00 RT = 800 LF
STA. 109+00 TO STA. 116+50 RT	=	700 LF	STA. 238+00 TO STA. 246+00 LT = 800 LF
STA. 119+50 TO STA. 126+50 LT	=	700 LF	STA. 248+00 TO STA. 265+00 RT = 1,700 LF
STA. 133+00 TO STA. 143+00 RT	=	1,000 LF	STA. 257+00 TO STA. 265+00 LT = 800 LF
SHORT-TERM 4IN LINE-TYPE NR:			
		BROKEN LINE = 5,693 LF	
		BARRIER LINE = 21,800 LF	
		TOTAL = 27,493 LF	
PVMT MK PAINTED 6IN LINE:			
		BROKEN LINE = 5,693 LF	
		BARRIER LINE = 21,800 LF	
		EDGE LINE = 53,045 LF	
		TOTAL = 80,538 LF	
PVMT MK PAINTED-MESSAGE:			
		STA. 256+65 RT - STOP AHEAD = 52 SF	
PVMT MK 24IN LINE:			
		STA. 264+62 RT - STOP BAR = 14 LF	

BASIS OF ESTIMATE - MILLINGS

DESCRIPTION	UNIT	PROJECT MAINLINE	
MILLING PAVEMENT SURFACE*	TON	4,420	
SUBTOTAL	TON		4,420
5% LESS FOR CRUSHING & HANDLING	TON		221
TOTAL BITUMINOUS MATERIAL AVAILABLE	TON		4,199
TOTAL RAP SUPERPAVE FAA 42	TON	13,143	
MILLED MATERIAL FOR RAP SUPERPAVE (20%)	TON		2,629
BITUMINOUS MATERIAL REMAINING	TON		1,570

BASIS OF ESTIMATE - FLAGGING & PILOT CAR

DESCRIPTION	BASIS	QUANTITY
FLAGGING	30 MHR/MILE/LIFT	600 MHR
PILOT CAR	15 HR/MILE/LIFT	300 HR



This document was originally issued and sealed by
 Jesse R. Brandvold,
 Registration Number
 PE-40107
 on 08/27/25 and the original document is stored at
 Wold Engineering, P.C.
 Bottineau, North Dakota

BASIS OF ESTIMATE

STATE.	PROJECT NO.	SECTION NO.	SHEET NO.
ND	SC-0341(001)	20	1

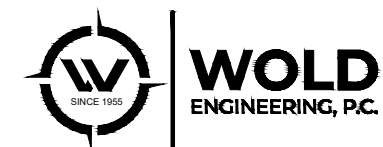
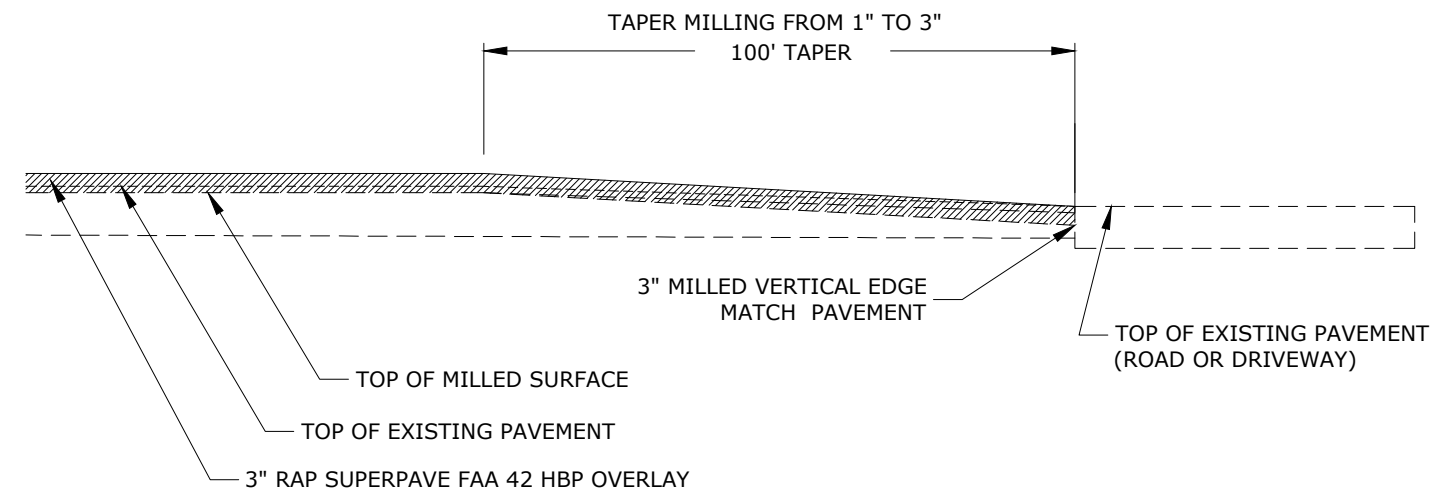
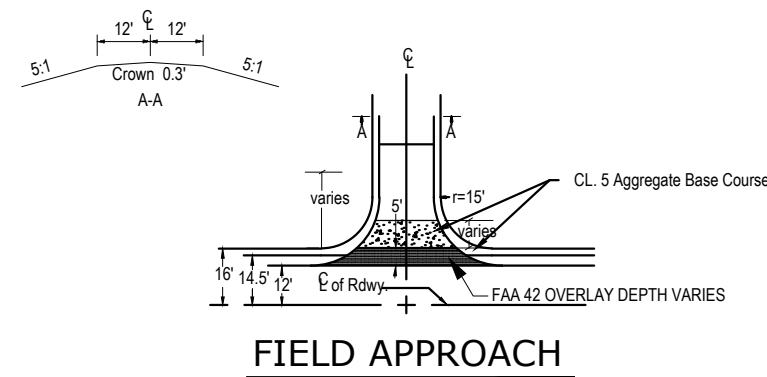
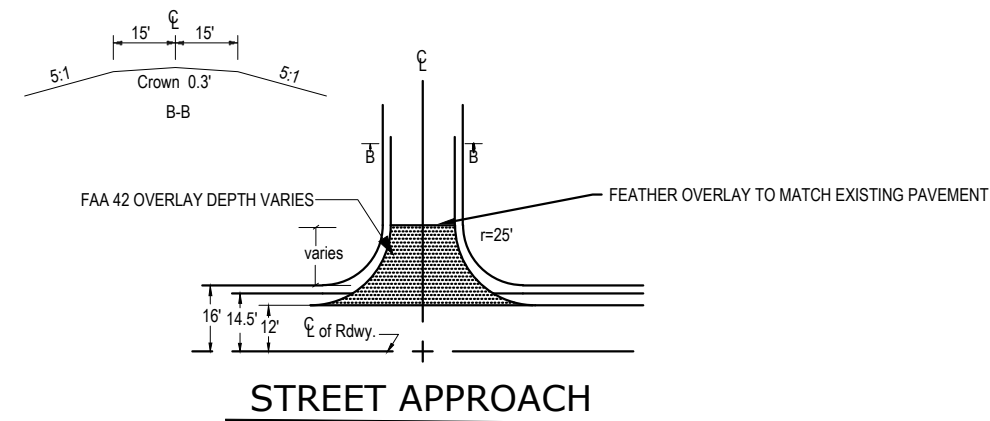
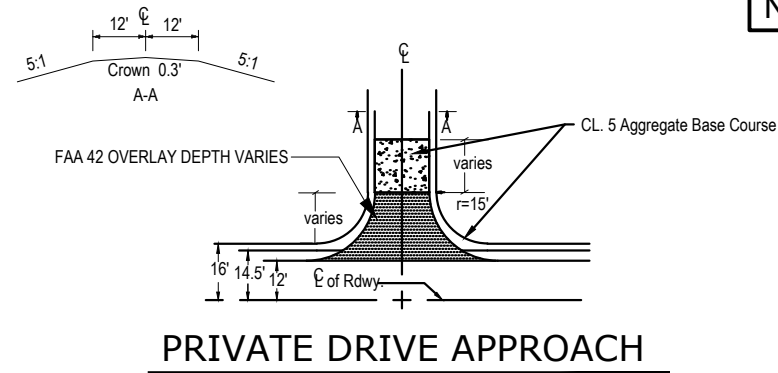
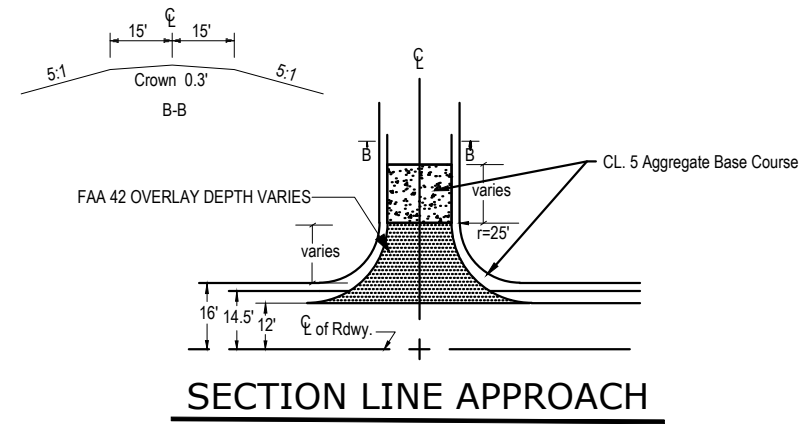

This document was originally issued and sealed by Jesse R. Brandvold, Registration Number PE-40107 on 08/27/25 and the original document is stored at Wold Engineering, P.C. Bottineau, North Dakota

APPROACH PAVING & MILLING TRANSITION DETAILS

STATE	PROJECT NO.	SECTION NO.	SHEET NO.
ND	SC-0341(001)	30	1

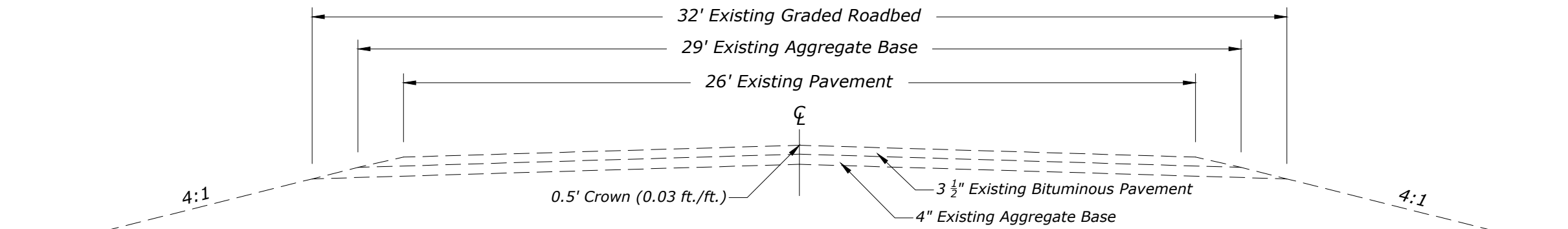

EXISTING TYPICAL SECTION
STA. 0+00 TO 285+22.24

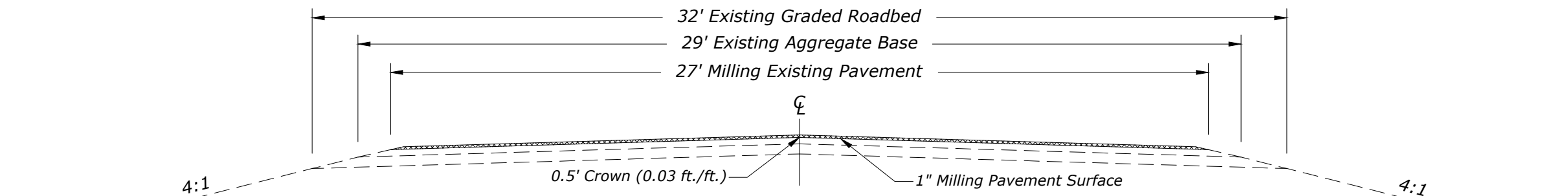

MILLING TYPICAL SECTION
STA. 0+00 TO 285+22.24

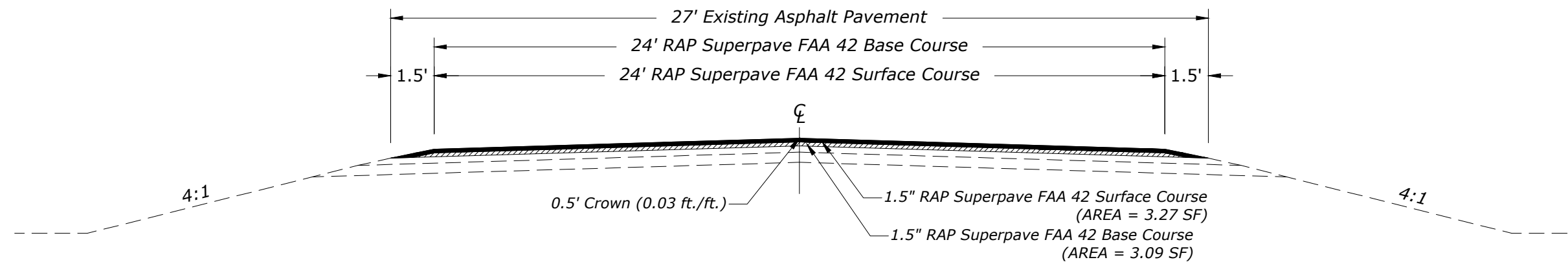

PROPOSED TYPICAL SECTION
STA. 0+00 TO 285+22.24

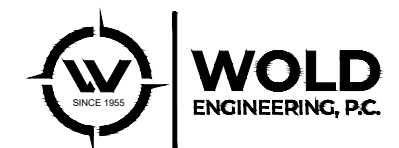

This document was originally issued and sealed by Jesse R. Brandvold, Registration Number PE-40107 on 08/27/25 and the original document is stored at Wold Engineering, P.C. Bottineau, North Dakota

TYPICAL SECTIONS

STATE.	PROJECT NO.	SECTION NO.	SHEET NO.
ND	SC-0341(001)	100	2

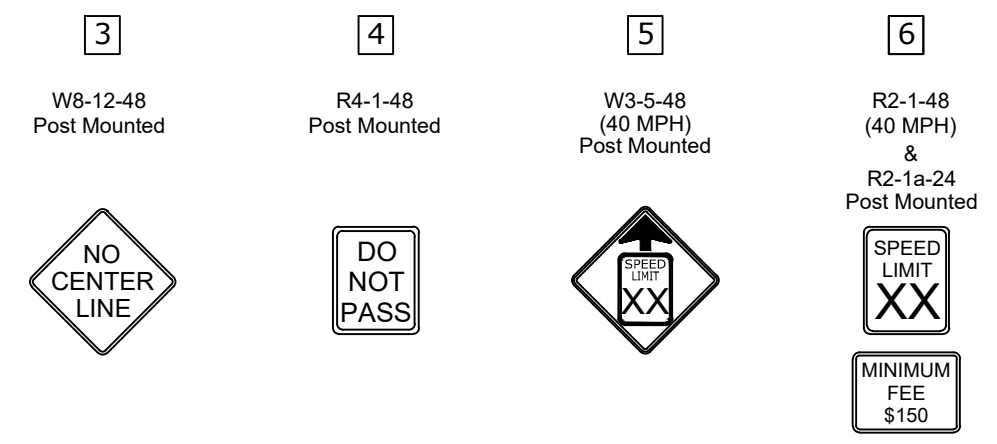
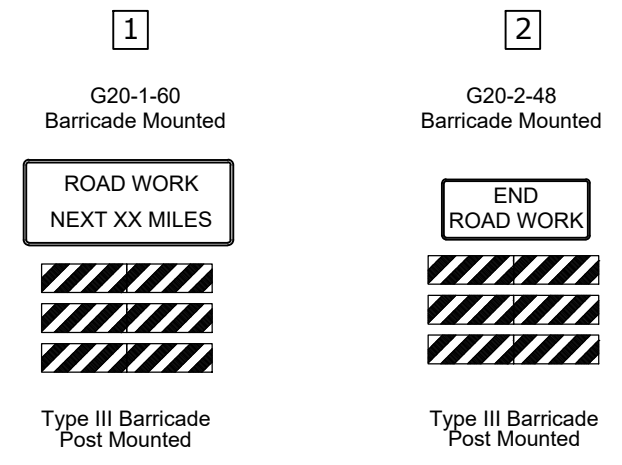
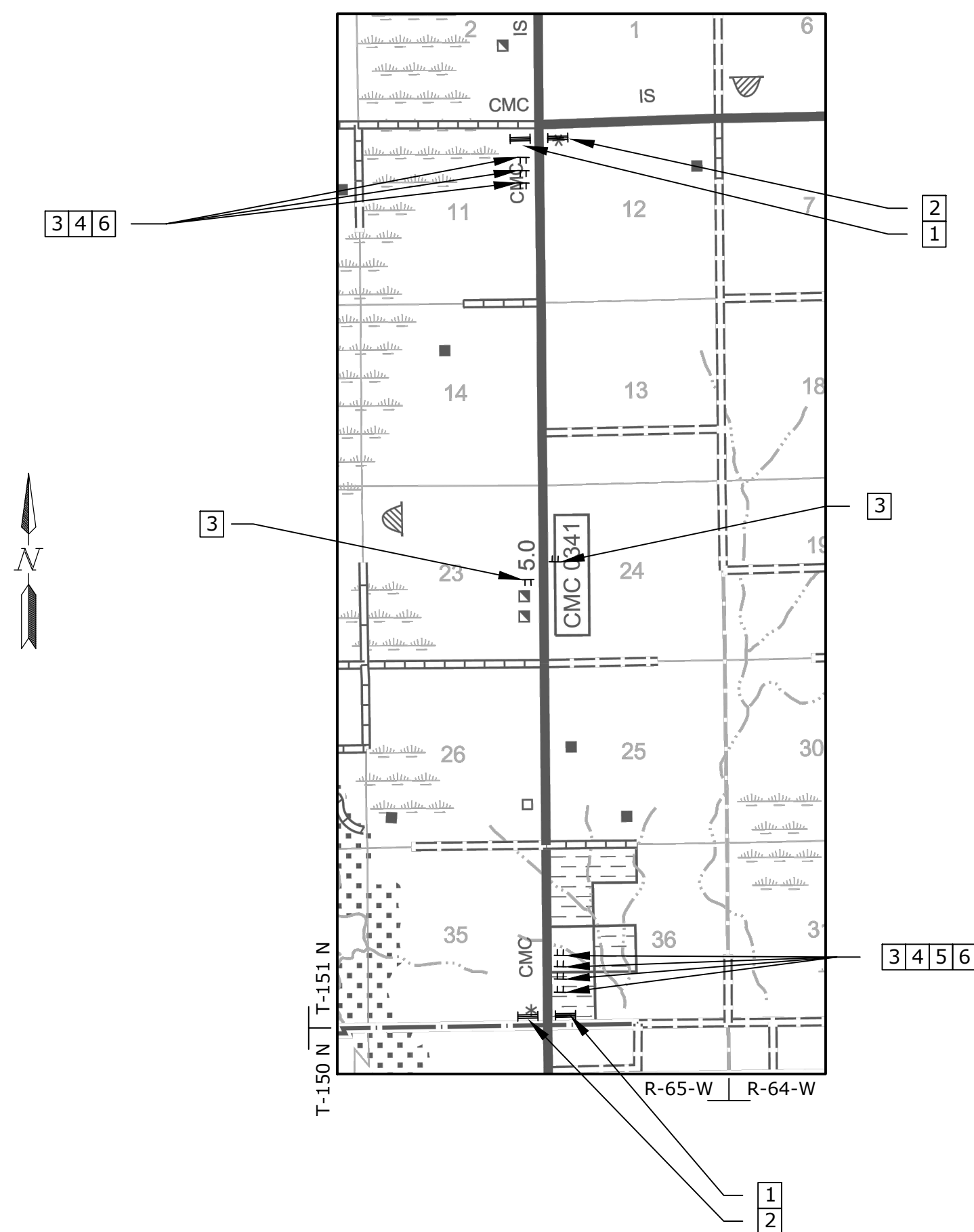

This document was originally issued and sealed by
 Jesse R. Brandvold,
 Registration Number
 PE-40107
 on 08/27/25 and the original
 document is stored at
 Wold Engineering, P.C.
 Bottineau, North Dakota

WORK ZONE TRAFFIC CONTROL

STATE	PROJECT NO.	SECTION NO.	SHEET NO.
N.D.	SC-0341(001)	110	1

Station / RP	Sign No.	Assembly No.	Flat Sheet For Signs		Sign Support Length				Vert Clearance FT	Support Size	Max Post Len LF	Sleeve Length				Sleeve Size	Anchor EA	Anchor LF	Anchor Size	Reset Sign Panel EA	Reset Sign Support EA	Break-Away EA	Comments
			IV SF	XI SF	1st LF	2nd LF	3rd LF	4th LF				1st LF	2nd LF	3rd LF	4th LF								
0+35 Lt	M1-6/BENSON CO		4.0		10.8				5.0	2 x 2 12 ga	13.0					1	4	2.25 x 2.25 12 ga	1				
3+00 Rt	R2-1 - 55	8		3.0	10.7				5.0	2 x 2 12 ga	14.6					1	4	2.25 x 2.25 12 ga					
5+89 Rt	Uphill/W1 3-1P			2.3	13.1				5.0	2.5 x 2.5 10 ga	14.7					1	4	3 x 3 7 ga	1		1		
22+19 Lt	W7-1/W13-1P	53		8.5	13.1				5.0	2.5 x 2.5 10 ga	14.7					1	4	3 x 3 7 ga			1		
52+62 Rt	No Outlet		7.5		9.3				5.0	2 x 2 12 ga	23.3					1	4	2.25 x 2.25 12 ga	1			Assembly Detail E (D-754-87)	
106+00 Lt	R1-2		7.5	3.9	11.5				5.0	2 x 2 12 ga	13.6					1	4	2.25 x 2.25 12 ga				Special Assembly 2E (D-754-87)	
211+97 Lt	77 Ave NE/34th ST NE		7.5		10.0				5.0	2 x 2 12 ga	14.1					1	4	2.25 x 2.25 12 ga				Assembly Detail E (D-754-87)	
251+67 Rt	W2-1/W13-1P	53		8.5	13.1				5.0	2.5 x 2.5 10 ga	14.7					1	4	3 x 3 7 ga			1		
256+59 Rt	W3-1	18		4.0	11.2				5.0	2 x 2 12 ga	12.9					1	4	2.25 x 2.25 12 ga					
259+20 Lt	R2-1 - 55	8		3.0	10.7				5.0	2 x 2 12 ga	14.6					1	4	2.25 x 2.25 12 ga					
262+17 Lt	M1-6		4.0		10.8				5.0	2 x 2 12 ga	13.0					1	4	2.25 x 2.25 12 ga					
264+10 Rt	R1-1	1		5.2	11.4				5.0	2.25 x 2.25 12 ga	13.7					1	4	2.5 x 2.5 12 ga					
264+45 Lt	R1-1			5.2	10.9				5.0	2.25 x 2.25 12 ga	13.2					1	4	2.5 x 2.5 12 ga	4			Special Assembly 2E (D-754-87)	
Sub Total			30.5	43.6	Total 146.6										Total 52.0				7	0	3		
Grand Total			30.5	43.6	Total 146.6										Total 52	0			7	0	3		

<p>This document was originally issued and sealed by Jesse R. Brandvold, Registration Number PE-40107 on 08/27/25 and the original document is stored at Wold Engineering, P.C. Bottineau, North Dakota</p>	<p>Sign Summary Perforated Tube</p>
---	-------------------------------------

STATE.	PROJECT NO.	SECTION NO.	SHEET NO.
ND	SC-0300(200)	110	2

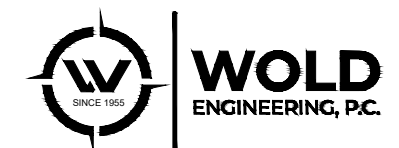
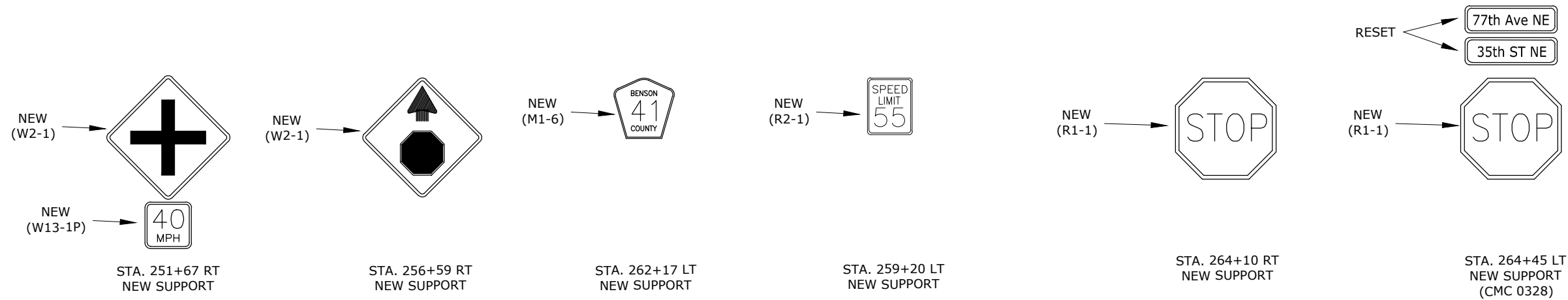
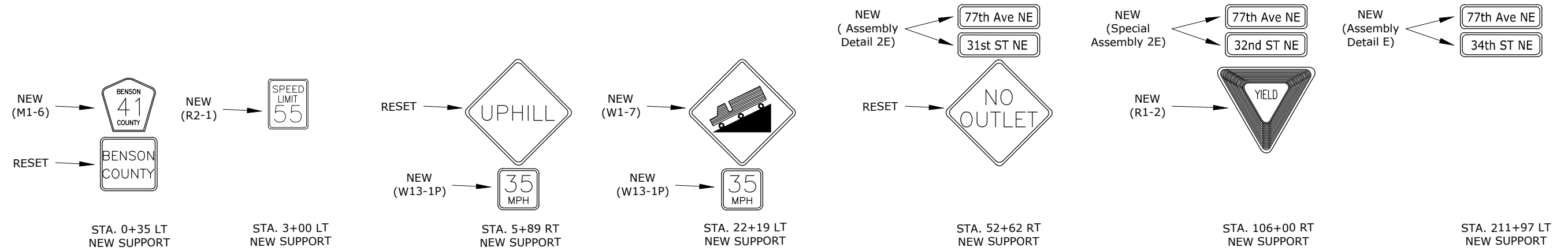

This document was originally issued and sealed by
 Jesse R. Brandvold,
 Registration Number
 PE-40107
 on 08/27/25 and the original document is stored at
 Wold Engineering, P.C.
 Bottineau, North Dakota

SIGNING

