

# 2007 FUNCTIONAL CLASSIFICATION

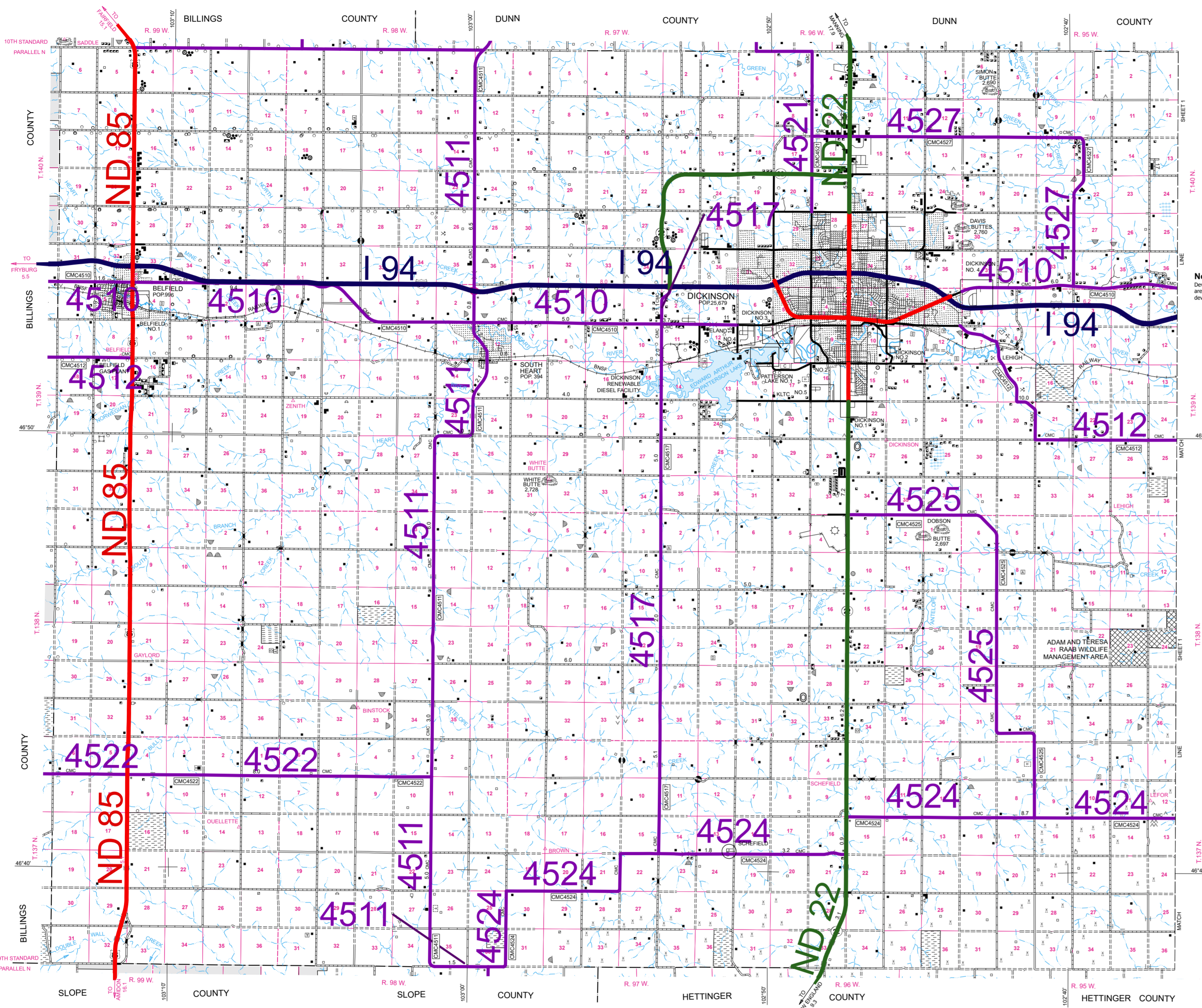

NAME AND LOCATION OF ORGANIZED CIVIL TOWNSHIPS  
THOSE UNORGANIZED ARE SO NOTED

T. 141 N.-R. 93 W. UNORGANIZED	T. 139 N.-R. 98 W. UNORGANIZED	T. 138 N.-R. 94 W. UNORGANIZED
T. 141 N.-R. 92 W. UNORGANIZED	T. 139 N.-R. 97 W. UNORGANIZED	T. 138 N.-R. 93 W. UNORGANIZED
T. 141 N.-R. 91 W. UNORGANIZED	T. 139 N.-R. 96 W. UNORGANIZED	T. 138 N.-R. 92 W. UNORGANIZED
T. 140 N.-R. 99 W. UNORGANIZED	T. 139 N.-R. 95 W. UNORGANIZED	T. 138 N.-R. 91 W. UNORGANIZED
T. 140 N.-R. 98 W. UNORGANIZED	T. 139 N.-R. 94 W. UNORGANIZED	T. 137 N.-R. 99 W. UNORGANIZED
T. 140 N.-R. 97 W. UNORGANIZED	T. 139 N.-R. 93 W. UNORGANIZED	T. 137 N.-R. 98 W. UNORGANIZED
T. 140 N.-R. 96 W. UNORGANIZED	T. 139 N.-R. 92 W. UNORGANIZED	T. 137 N.-R. 97 W. UNORGANIZED
T. 140 N.-R. 95 W. UNORGANIZED	T. 139 N.-R. 91 W. UNORGANIZED	T. 137 N.-R. 96 W. UNORGANIZED
T. 140 N.-R. 94 W. UNORGANIZED	T. 138 N.-R. 99 W. UNORGANIZED	T. 137 N.-R. 95 W. UNORGANIZED
T. 140 N.-R. 93 W. UNORGANIZED	T. 138 N.-R. 98 W. UNORGANIZED	T. 137 N.-R. 94 W. UNORGANIZED
T. 140 N.-R. 92 W. UNORGANIZED	T. 138 N.-R. 97 W. UNORGANIZED	T. 137 N.-R. 93 W. UNORGANIZED
T. 140 N.-R. 91 W. UNORGANIZED	T. 138 N.-R. 96 W. UNORGANIZED	T. 137 N.-R. 92 W. UNORGANIZED
T. 139 N.-R. 99 W. UNORGANIZED	T. 138 N.-R. 95 W. UNORGANIZED	T. 137 N.-R. 91 W. UNORGANIZED
T. 139 N.-R. 98 W. UNORGANIZED	T. 138 N.-R. 94 W. UNORGANIZED	

## FUNCTIONAL CLASSIFICATION

- INTERSTATE
- PRINCIPAL ARTERIAL
- MINOR ARTERIAL
- MAJOR COLLECTOR

### REVISION DATE AND CHANGE

- 04-03-2013 Addition of 14.0 miles on CMC4517
- 05-01-2015 Addition of 3.3 miles on CMC4521
- 05-01-2015 Addition of 11.2 miles on CMC4527
- 05-01-2015 Addition of 1.0 miles on CMC4517
- 06-04-2015 Addition of 2.0 miles on CMC4512
- 04-19-2016 Addition of 1.0 miles on CMC4521

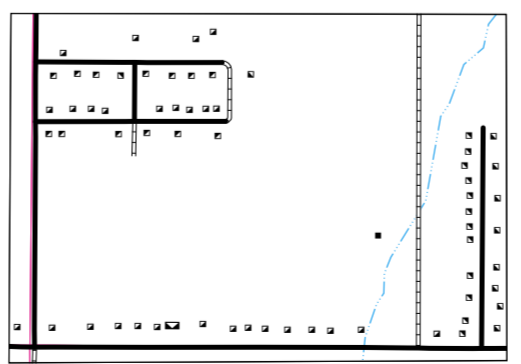

INSET NO. 5  
SEC'S 16, 17, 20, & 21, T. 139 N., R. 96 W.

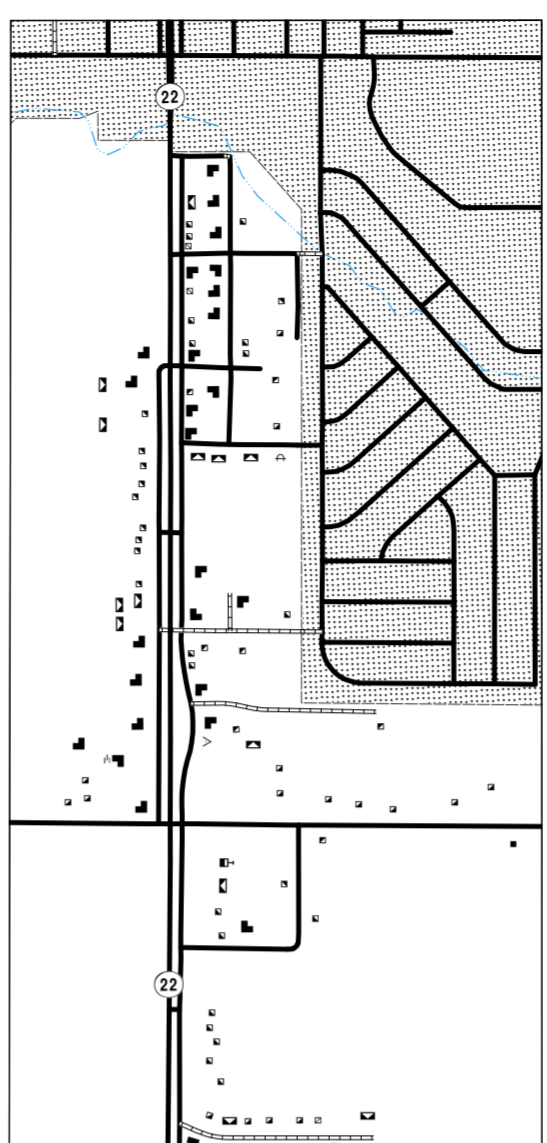

DICKINSON NO. 1  
SEC'S 9, 10, 15, 16, 21, & 22, T. 139 N., R. 96 W.

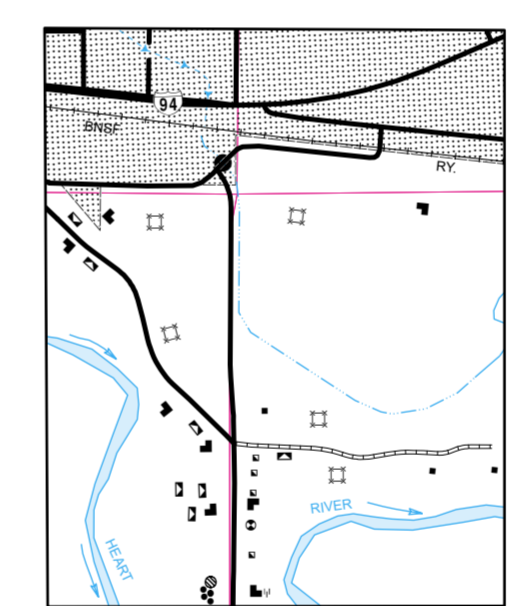

DICKINSON NO. 2  
SEC'S 2, 3, 10, & 11, T. 139 N., R. 96 W.

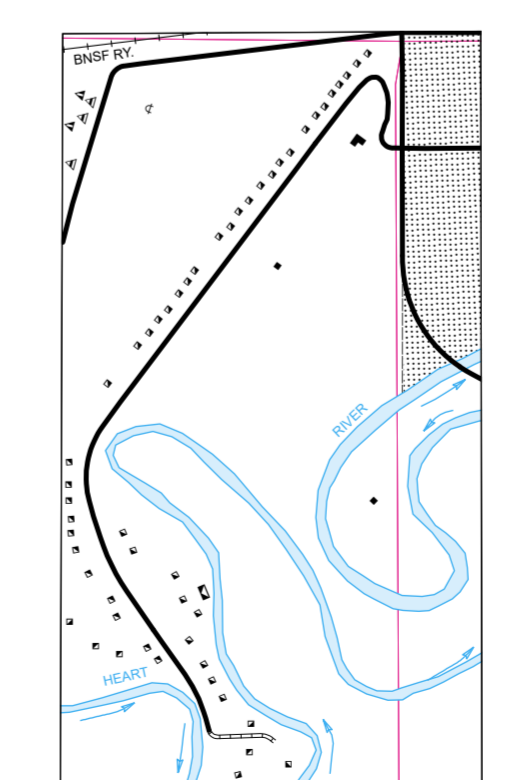

DICKINSON NO. 3  
SEC'S 5, 6, 7, & 8, T. 139 N., R. 96 W.

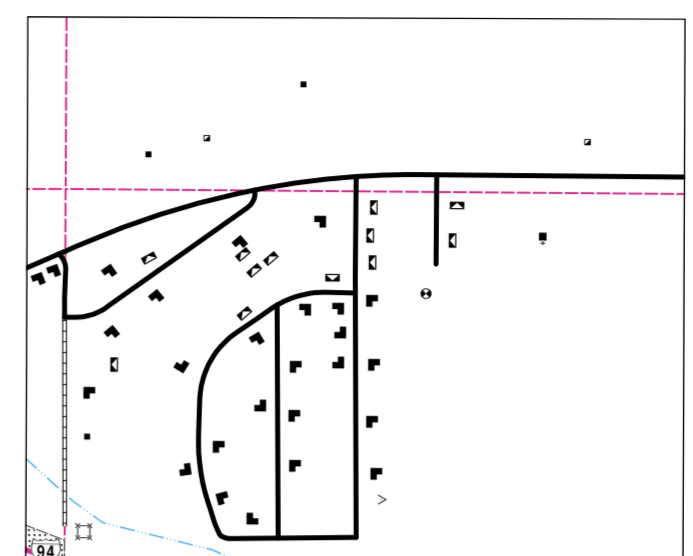

DICKINSON NO. 4  
SEC. 36, T. 149 N., R. 96 W. SEC. 31, T. 140 N., R. 95 W.  
SEC. 1, T. 139 N., R. 96 W. SEC. 6, T. 139 N., R. 95 W.

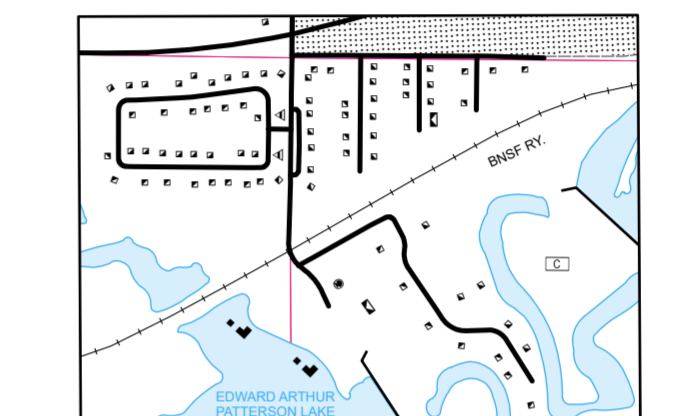

DICKINSON NO. 5  
SEC'S 1, 2, 3, 10, & 11, T. 139 N., R. 96 W.

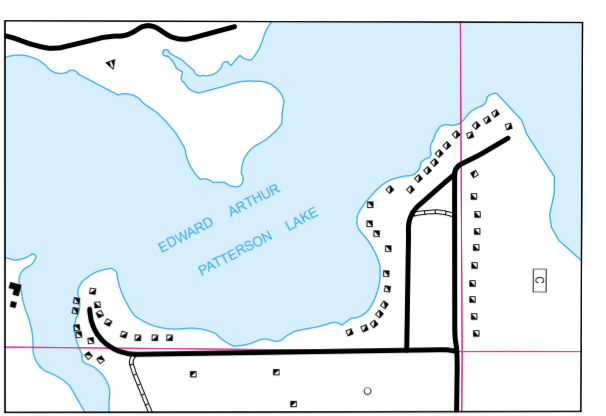

PATTERSON LAKE NO. 1  
SEC'S 7, 8, 17, & 18, T. 139 N., R. 96 W.

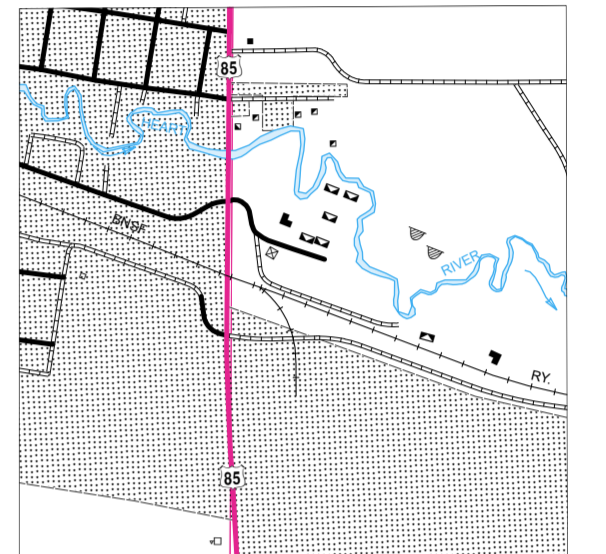

BELFIELD NO. 1  
SEC'S 4 & 5, T. 139 N., R. 99 W.

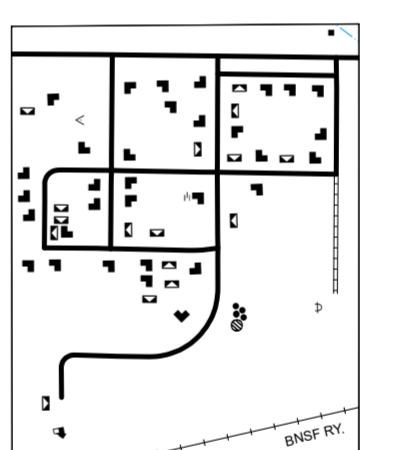

INSET NO. 4  
SEC'S 6, & 7, T. 139 N., R. 96 W.

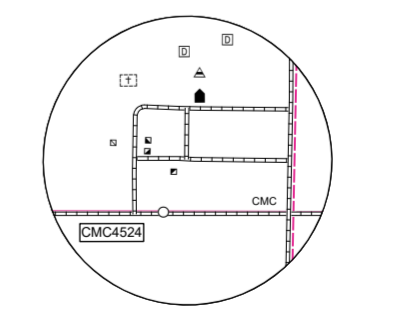

SCHIEFFELD  
SEC'S 13 & 24, T. 137 N., R. 97 W.  
SEC'S 18 & 19, T. 137 N., R. 96 W.

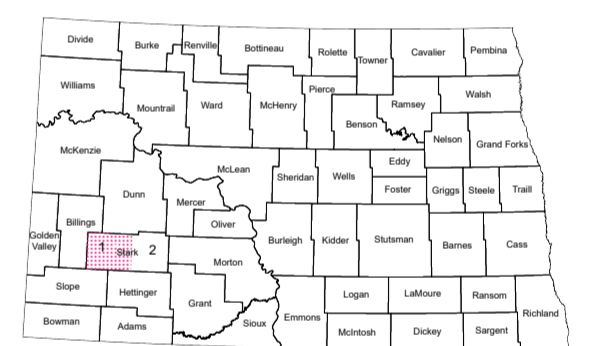

STATE OF NORTH DAKOTA  
DIAGRAM OF COUNTIES

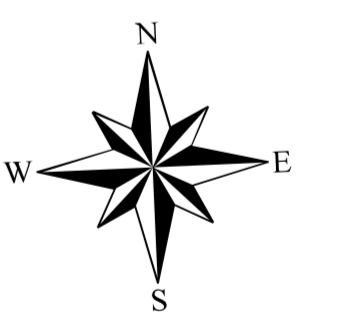

## GENERAL HIGHWAY MAP STARK COUNTY NORTH DAKOTA

PREPARED BY THE  
NORTH DAKOTA DEPARTMENT OF TRANSPORTATION  
PLANNING AND ASSET MANAGEMENT DIVISION  
IN COOPERATION WITH THE  
U.S. DEPARTMENT OF TRANSPORTATION  
FEDERAL HIGHWAY ADMINISTRATION

SCALE  
1 0.5 0 1 2 3 4 Miles

SCALE FOR ENLARGEMENTS  
0 0.25 0.5 Miles

1 0.5 0 1 2 3 4 Kilometers

2020

BASED ON AERIAL PHOTOGRAPHY OF 1993  
AERIAL INVENTORY OF 2020  
UNIVERSAL TRANSVERSE MERCATOR ZONE 14  
NORTH AMERICAN DATUM 83

**Notice of Disclaimer**  
The North Dakota Department of Transportation (NDOT) makes this map available on an "as is" basis as a public service. Under no circumstances does NDOT warrant or certify the information to be free of errors or deficiencies of any kind. NDOT specifically disclaims all warranties, express or implied, including but not limited to the warranties of merchantability and fitness for a particular purpose.