

STATE OF NORTH DAKOTA  
DIAGRAM OF COUNTIES

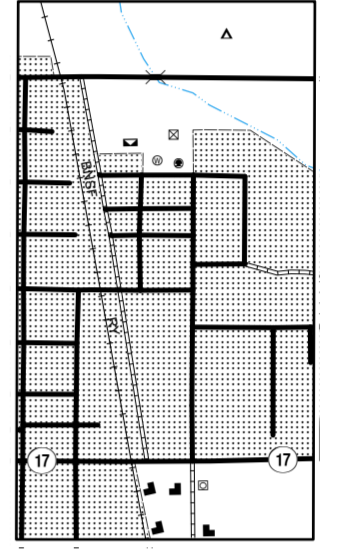

NO. 1  
SECS. 20 & 29, T. 158 N., R. 66 W.

NAME AND LOCATION OF ORGANIZED CIVIL TOWNSHIPS  
THOSE UNORGANIZED ARE SO NOTED

- T. 164 N.-R. 68 W. PICTON
- T. 163 N.-R. 68 W. PICTON
- T. 164 N.-R. 67 W. SIDNEY
- T. 163 N.-R. 67 W. SIDNEY
- T. 164 N.-R. 66 W. SMITH
- T. 163 N.-R. 66 W. SMITH
- T. 164 N.-R. 65 W. DASH
- T. 163 N.-R. 65 W. DASH
- T. 162 N.-R. 66 W. MOUNT VIEW
- T. 162 N.-R. 67 W. ARMOURDALE
- T. 162 N.-R. 66 W. ROCK LAKE
- T. 162 N.-R. 65 W. LANSING
- T. 161 N.-R. 68 W. MONROE
- T. 161 N.-R. 67 W. HOWELL
- T. 161 N.-R. 66 W. VIRGINIA
- T. 161 N.-R. 65 W. TEDDY
- T. 160 N.-R. 68 W. GRAINFIELD
- T. 160 N.-R. 67 W. SORENSON
- T. 160 N.-R. 66 W. CROCUS
- T. 160 N.-R. 65 W. TWIN HILL
- T. 159 N.-R. 68 W. NEW CITY
- T. 159 N.-R. 67 W. GERRARD
- T. 159 N.-R. 66 W. PAULSON
- T. 159 N.-R. 65 W. VICTOR
- T. 158 N.-R. 68 W. ZION
- T. 158 N.-R. 67 W. OLSON
- T. 158 N.-R. 66 W. CANDO
- T. 158 N.-R. 65 W. BETHEL
- T. 157 N.-R. 68 W. SPRINGFIELD
- T. 157 N.-R. 67 W. ATKINS
- T. 157 N.-R. 66 W. MAZA
- T. 157 N.-R. 65 W. COOLIN

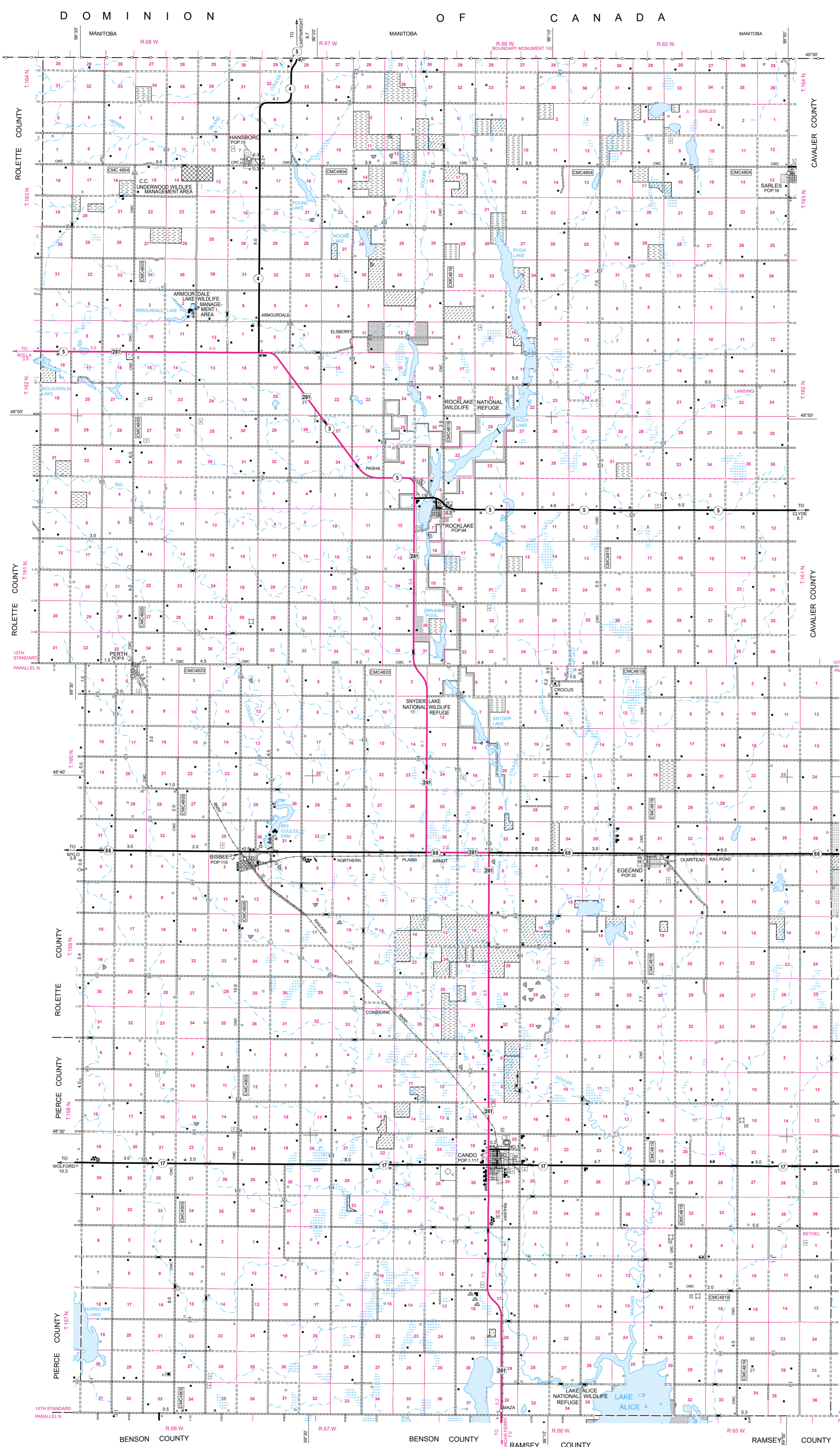
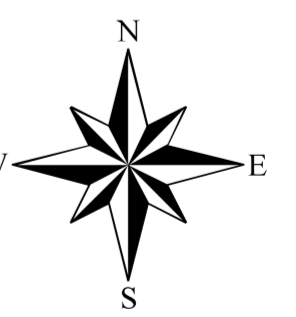

GENERAL LEGEND

- |   |   |   |  |
|---|---|---|--|
| <p><b>ROADS AND ROADWAY FEATURES</b></p> <ul style="list-style-type: none"> <li>PRIMITIVE ROAD</li> <li>UNIMPROVED ROAD</li> <li>GRADED AND DRAINED ROAD</li> <li>GRAVEL GRADED AND DRAINED ROAD</li> <li>PAVED ROAD</li> <li>STREETS IN UNINCORPORATED AREAS</li> <li>COUNTY MAJOR COLLECTOR</li> <li>ROUTE NUMBER</li> <li>POINTS BETWEEN WHICH DISTANCES ARE MEASURED</li> <li>INTERSTATE NUMBERED HIGHWAY</li> <li>U.S. NUMBERED HIGHWAY</li> <li>STATE HIGHWAY SYSTEM</li> </ul> <p><b>STRUCTURES</b></p> <ul style="list-style-type: none"> <li>HIGHWAY BRIDGE, GENERAL</li> <li>HIGHWAY GRADE SEPARATION</li> <li>DAM WITH ROAD</li> <li>MINOR DRAINAGE STRUCTURE</li> <li>CONCRETE FORD OR DIP</li> <li>FORD - ROAD ESTABLISHED</li> </ul> <p><b>RAILROADS</b></p> <ul style="list-style-type: none"> <li>RAILROAD (ANY NUMBER OF TRACKS USED BY A SINGLE OPERATING CO.)</li> <li>RAILROAD STATION</li> <li>RAILROAD GRADE CROSSING</li> <li>RAILROAD BRIDGE</li> </ul> <p><b>NAVIGATION</b></p> <ul style="list-style-type: none"> <li>DOCK, PIER, OR LANDING</li> </ul> | <p><b>BOUNDARIES</b></p> <ul style="list-style-type: none"> <li>MONUMENTED BOUNDARY MARKER</li> <li>NATIONAL BOUNDARY LINE</li> <li>STATE OR PROVINCE LINE</li> <li>COUNTY LINE</li> <li>TOWNSHIP LINE</li> <li>CORPORATE LINE</li> <li>SECTION LINE</li> <li>BOUNDARY TO MARK ENLARGEMENT INSET</li> </ul> <p><b>NATIONAL REFUGES</b></p> <ul style="list-style-type: none"> <li>WILDLIFE MANAGEMENT AREA</li> <li>WATERFOWL PRODUCTION AREA</li> <li>STATE SCHOOL LAND</li> <li>NATIONAL PARKS AND OTHER RESERVATIONS</li> </ul> <p><b>DRAINAGE</b></p> <ul style="list-style-type: none"> <li>INTERMITTENT STREAM (NARROW)</li> <li>NARROW STREAM</li> <li>WIDE STREAM</li> <li>WIDE STREAM WITH DAM</li> <li>LAKE, RESERVOIR, OR POND</li> <li>LAKE, RESERVOIR, OR POND WITH DAM</li> <li>MARSH OR SWAMP LAND</li> <li>DRAINAGE DITCH</li> </ul> <p><b>AIRPORTS</b></p> <ul style="list-style-type: none"> <li>AIRFIELD, LIMITED FACILITIES</li> <li>LANDING AREA OR STRIP</li> <li>AIRPORT, GENERAL</li> </ul> | <p><b>FARM UNITS, DWELLINGS, ETC.</b></p> <ul style="list-style-type: none"> <li>FARM UNIT (FARM UNITS SHOWN IN MUNICIPAL LIMITS INDICATE FARM BUILDINGS FOR FARM USE)</li> <li>DWELLING OTHER THAN FARM</li> <li>CHURCH</li> <li>CHURCH WITH CEMETERY ADJACENT</li> <li>WELL</li> <li>FIRST AID STATION OR HEALTH CENTER</li> <li>FRESH AIR FARM OR REST HOME</li> </ul> <p><b>PUBLIC SERVICE FACILITIES</b></p> <ul style="list-style-type: none"> <li>HIGHWAY GARAGE</li> <li>GARBAGE OR RUBBISH DUMP</li> <li>SEWAGE DISPOSAL PLANT</li> <li>AUTOMOBILE GRAVEYARD</li> <li>WATER SUPPLY STAND PIPE OR TANK</li> <li>POWER SUBSTATION</li> <li>COMMUNICATION TOWER</li> <li>MUNICIPAL BUILDING</li> <li>CANADIAN BORDER CUSTOMS STATION</li> <li>U.S. BORDER CUSTOMS STATION</li> </ul> <p><b>EDUCATIONAL AND CORRECTIONAL INSTITUTIONS</b></p> <ul style="list-style-type: none"> <li>SCHOOLHOUSE</li> <li>TOWNHALL, GRANGE, OR COMMUNITY HALL</li> </ul> <p><b>CITY AND VILLAGE CENTERS</b></p> <ul style="list-style-type: none"> <li>COUNTY SEAT</li> <li>OTHER CITIES AND VILLAGES</li> <li>INCORPORATED CITY OR VILLAGE (GENERALIZED)</li> </ul> | <p><b>INDUSTRIAL</b></p> <ul style="list-style-type: none"> <li>STORE OR SMALL BUSINESS ESTABLISHMENT</li> <li>FACTORY OR INDUSTRIAL PLANT</li> <li>GROUP OF STORAGE TANKS (OIL OR GAS)</li> <li>GAUGING OR PUMPING STATION</li> <li>WAREHOUSE - GENERAL</li> <li>GRAIN ELEVATOR</li> <li>STOCK YARD - LOADING PEN OR CORRAL</li> <li>GRAVEL PIT</li> <li>WIND TURBINE</li> </ul> <p><b>CONSERVATION AND RECREATION</b></p> <ul style="list-style-type: none"> <li>PICNIC GROUND</li> <li>PLAYGROUND, BALL FIELD, ETC.</li> <li>BATHING BEACH OR SWIMMING POOL</li> <li>CAMP SITE, NO PERMANENCE (TENTS OR TRAILER PARKING)</li> <li>GOLF GROUND OR COUNTRY CLUB</li> <li>FAIR GROUND, RACE COURSE, SPEEDWAY</li> <li>RIFLE CLUB</li> </ul> <p><b>MISCELLANEOUS</b></p> <ul style="list-style-type: none"> <li>TRIANGULATION STATION</li> <li>DOT TO INDICATE LOCATION OF ANY CULTURAL FEATURE</li> <li>SHOW OUT OF POSITION</li> <li>ALL VACANT CULTURE INDICATED BY OPEN SYMBOL</li> <li>LATITUDE AND LONGITUDE</li> </ul> |
|---|---|---|--|

# GENERAL HIGHWAY MAP TOWNER COUNTY NORTH DAKOTA

PREPARED BY THE  
NORTH DAKOTA DEPARTMENT OF TRANSPORTATION  
PLANNING AND ASSET MANAGEMENT DIVISION

IN COOPERATION WITH THE  
U.S. DEPARTMENT OF TRANSPORTATION  
FEDERAL HIGHWAY ADMINISTRATION

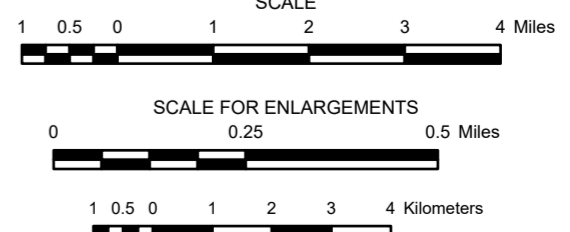

2021

**Notice of Disclaimer**  
The North Dakota Department of Transportation (NDOT) makes this map available on an "as is" basis as a public service. Under no circumstances does NDOT warrant or certify the information to be free of errors or deficiencies of any kind. NDOT specifically disclaims all warranties, express or implied, including but not limited to the warranties of merchantability and fitness for a particular purpose.