

GENERAL LEGEND

- ROADS AND ROADWAY FEATURES**
- PRIMITIVE ROAD
- UNIMPROVED ROAD
- GRADED AND DRAINED ROAD
- PAVED ROAD
- STREETS IN UNINCORPORATED AREAS
- ROUTE NUMBER
- POINTS BETWEEN WHICH DISTANCES ARE MEASURED
- U.S. NUMBERED HIGHWAY
- STATE HIGHWAY SYSTEM
- RAILROADS**
- RAILROAD (ANY NUMBER OF TRACKS USED BY A SINGLE OPERATING CO.)
- RAILROAD STATION
- RAILROAD GRADE CROSSING
- STRUCTURES**
- HIGHWAY BRIDGE, GENERAL
- HIGHWAY GRADE SEPARATION
- DAM WITH ROAD
- MINOR DRAINAGE STRUCTURE
- CONCRETE FORD OR DIP
- DRAINAGE**
- INTERMITTENT STREAM (NARROW)
- NARROW STREAM
- WIDE STREAM
- WIDE STREAM WITH DAM
- LAKE, RESERVOIR, OR POND
- WITH DAM
- MARSH OR SWAMP LAND
- DRAINAGE DITCH
- BOUNDARIES**
- COUNTY LINE
- TOWNSHIP LINE
- CORPORATE LINE
- SECTION LINE
- MATCH LINE BETWEEN ADJOINING SHEETS OF SAME COUNTY
- BOUNDARY TO MARK ENLARGEMENT INSET
- MONUMENT - SMALL, HISTORIC SITE
- WILDLIFE MANAGEMENT AREA
- WATERFOWL PRODUCTION AREA
- NATIONAL PARKS AND OTHER RESERVATIONS
- EDUCATIONAL AND CORRECTIONAL INSTITUTIONS**
- SCHOOLHOUSE
- TOWNHALL, GRANGE, OR COMMUNITY HALL
- AGRICULTURAL EXPERIMENT STATION
- AIRPORTS**
- AIRFIELD, LIMITED FACILITIES
- LANDING AREA OR STRIP
- NAVIGATION**
- DOCK, PIER, OR LANDING
- FARM UNITS, DWELLINGS, ETC.**
- FARM UNIT (FARM UNITS SHOWN IN MUNICIPAL LIMITS INDICATE FARM BUILDINGS FOR FARM USE)
- DWELLING OTHER THAN FARM
- BARRACKS, OR DORMATORIES FOR STUDENTS, WORKERS, MIGRANTS, ETC.
- SEASONAL OR SUMMER COLONY
- DWELLING
- CHURCH
- CEMETERY
- CHURCH WITH CEMETERY ADJACENT
- WELL
- PUBLIC SERVICE FACILITIES**
- POST OFFICE
- HIGHWAY GARAGE
- GARBAGE OR RUBBISH DUMP
- SEWAGE DISPOSAL PLANT
- WATER SUPPLY STAND PIPE OR TANK
- POWER SUBSTATION
- BROADCASTING STATION (RADIO OR TV)
- COMMUNICATION TOWER
- U.S. BORDER CUSTOMS STATION
- CONSERVATION AND RECREATION**
- SCENIC SITE
- CAMP SITE, NO PERMANENCE
- SKI AREA
- GOLF GROUND OR COUNTRY CLUB
- FAIR GROUND, RACE COURSE, SPEEDWAY
- INDUSTRIAL**
- STORE OR SMALL BUSINESS ESTABLISHMENT
- FACTORY OR INDUSTRIAL PLANT
- GAS TANK
- GROUP OF STORAGE TANKS (OIL OR GAS)
- GAUGING OR PUMPING STATION
- WAREHOUSE - GENERAL
- CRAN ELEVATOR
- GRAVEL PIT
- OIL OR GAS WELL
- CITY AND VILLAGE CENTERS**
- COUNTY SEAT
- OTHER CITIES AND VILLAGES
- INCORPORATED CITY OR VILLAGE (GENERALIZED)
- MISCELLANEOUS**
- TRIANGULATION STATION
- DOT TO INDICATE LOCATION OF ANY CULTURAL FEATURE SHOWN OUT OF POSITION
- ALL VACANT CULTURE INDICATED
- LATITUDE AND LONGITUDE

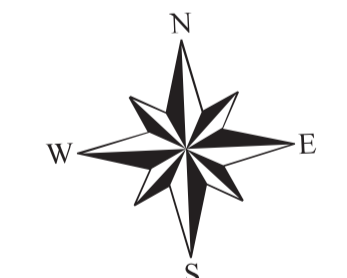

GENERAL HIGHWAY MAP
MOUNTRAIL COUNTY
NORTH DAKOTA

PREPARED BY THE
 NORTH DAKOTA DEPARTMENT OF TRANSPORTATION
 PLANNING / ASSET MANAGEMENT DIVISION

IN COOPERATION WITH THE
 U.S. DEPARTMENT OF TRANSPORTATION
 FEDERAL HIGHWAY ADMINISTRATION

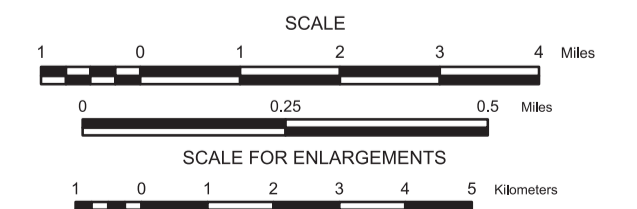

2015

BASED ON AERIAL PHOTOGRAPHY OF 1958
 AERIAL INVENTORY OF 2015

UNIVERSAL TRANSVERSE MERCATOR ZONE 14
 NORTH AMERICAN DATUM 83

SHEET 1 OF 2

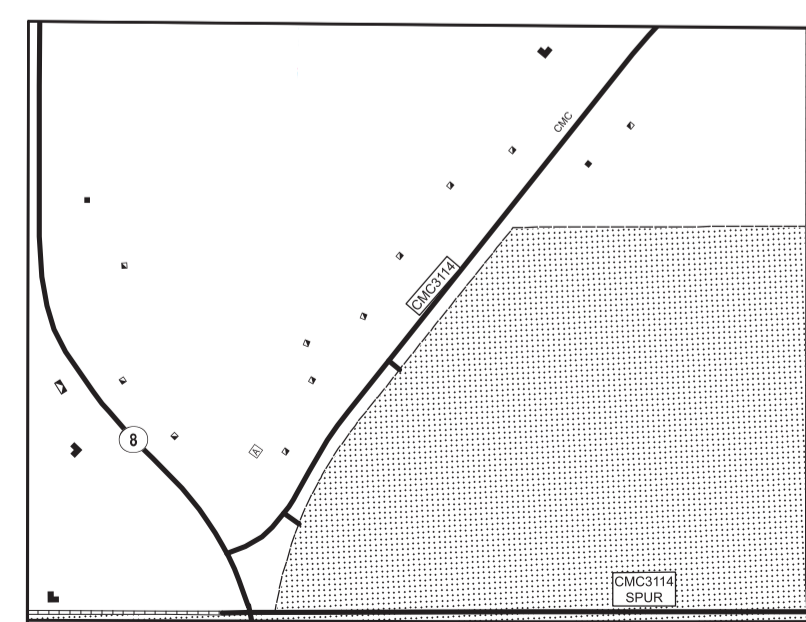

STANLEY NO. 2
 SECS. 15, 16, 17, 20, 21, & 22, T. 156 N., R. 91 W.

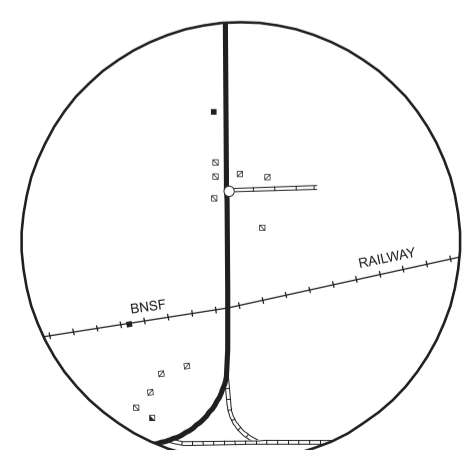

TAGUS
 SEC. 12, T. 156 N., R. 88 W.

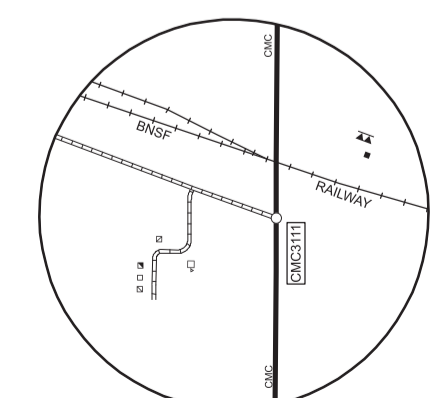

MANITOU
 SECS. 15 & 16, T. 156 N., R. 93 W.

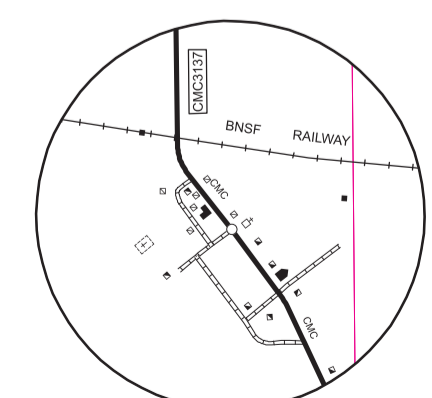

BLAISDELL
 SECS. 13 & 14, T. 156 N., R. 89 W.

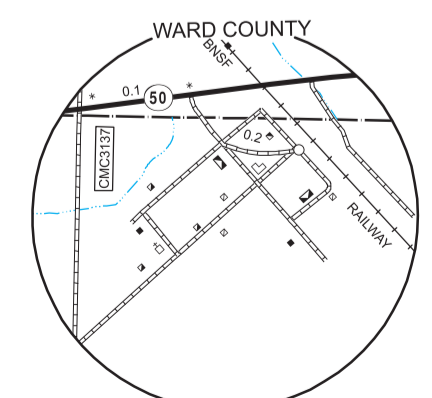

COULEE
 SECS. 2 & 3, T. 158 N., R. 88 W.

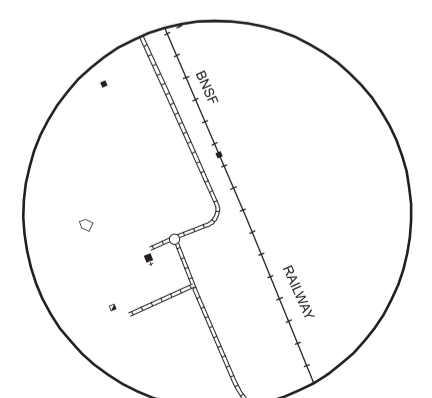

LOSTWOOD
 SEC. 27, T. 158 N., R. 91 W.

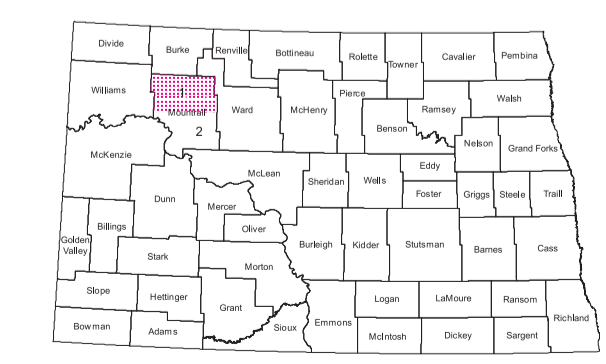

STATE OF NORTH DAKOTA
 DIAGRAM OF COUNTIES

Notice of Disclaimer
 The North Dakota Department of Transportation (NDDOT) makes this map available on an "as is" basis as a public service. Under no circumstances does NDDOT warrant or certify the information to be free of errors or deficiencies of any kind. NDDOT specifically disclaims all warranties, express or implied, including but not limited to the warranties of merchantability and fitness for a particular purpose. COPIES OF THIS MAP ARE AVAILABLE FOR PUBLIC USE AT A NOMINAL COST FROM: MAP SALES, N.D. DEPT. OF TRANSPORTATION, 608 E. BLVD. AVE., BISMARCK, ND 58505-0700