

- GENERAL LEGEND**
- ROADS AND ROADWAY FEATURES**
 - PRIMITIVE ROAD
 - UNIMPROVED ROAD
 - GRADED AND DRAINED ROAD
 - GRAVEL GRADED AND DRAINED ROAD
 - PAVED ROAD
 - STREETS IN UNINCORPORATED AREAS
 - COUNTY MAJOR COLLECTOR ROUTE NUMBER
 - POINTS BETWEEN WHICH DISTANCES ARE MEASURED STATE HIGHWAY SYSTEM
 - RAILROADS**
 - RAILROAD (ANY NUMBER OF TRACKS USED BY A SINGLE OPERATING CO.)
 - RAILROAD STATION
 - STRUCTURES**
 - HIGHWAY BRIDGE, GENERAL
 - DAM WITH ROAD
 - MINOR DRAINAGE STRUCTURE
 - CONCRETE FORD OR DIP
 - FORD - ROAD ESTABLISHED
 - DRAINAGE**
 - INTERMITTENT STREAM (NARROW)
 - NARROW STREAM
 - WIDE STREAM
 - WIDE STREAM WITH DAM
 - LAKE, RESERVOIR, OR POND WITH DAM
 - LAKE, RESERVOIR, OR POND
 - MARSH OR SWAMP LAND
 - NAVIGATION**
 - DOCK, PIER, OR LANDING
 - PUBLIC SERVICE FACILITIES**
 - HIGHWAY GARAGE
 - GARBAGE OR RUBBISH DUMP
 - SEWAGE DISPOSAL PLANT
 - AUTOMOBILE GRAVEYARD
 - POWER SUBSTATION
 - COMMUNICATION TOWER
 - BOUNDARIES**
 - STATE OR PROVINCE LINE
 - COUNTY LINE
 - TOWNSHIP LINE
 - CORPORATE LINE
 - SECTION LINE
 - BOUNDARY TO MARK ENLARGEMENT INSET
 - NATIONAL REFUGES
 - MONUMENT - SMALL, HISTORIC SITE
 - WILDLIFE MANAGEMENT AREA
 - WATERFOWL PRODUCTION AREA
 - STATE SCHOOL LAND
 - STATE PARKS
 - CITY AND VILLAGE CENTERS**
 - COUNTY SEAT
 - OTHER CITIES AND VILLAGES
 - INCORPORATED CITY OR VILLAGE (GENERALIZED)
 - FARM UNITS, DWELLINGS, ETC.**
 - FARM UNIT (FARM UNITS SHOWN IN MUNICIPAL LIMITS INDICATE FARM BUILDINGS FOR FARM USE)
 - DWELLING OTHER THAN FARM
 - ROWS OR GROUPS OF DWELLINGS CLOSELY SPACED (FIGURE DENOTES NUMBER OF DWELLINGS)
 - BARRACKS, OR DORMATORIES FOR STUDENTS, WORKERS, MIGRANTS, ETC.
 - SEASONAL OR SUMMER COLONY
 - DWELLING
 - SEASONAL DWELLINGS CLOSELY SPACED
 - HOTEL OR INN
 - CHURCH
 - CEMETERY
 - CHURCH WITH CEMETERY ADJACENT
 - TOLL HOUSE, STATE PORT OF ENTRY, OR WEIGHT STATION
 - EDUCATIONAL AND CORRECTIONAL INSTITUTIONS**
 - SCHOOLHOUSE
 - TOWNHALL, GRANGE, OR COMMUNITY HALL
 - CONSERVATION AND RECREATION**
 - PICNIC GROUND
 - PLAYGROUND, BALL FIELD, ETC.
 - BATHING BEACH OR SWIMMING POOL
 - SMALL PARK (SP-STATE, CP-COUNTY, MP-MUNICIPAL, WP-WAYSIDE PARK)
 - GOLF GROUND OR COUNTRY CLUB
 - FAIR GROUND, RACE COURSE, SPEEDWAY
 - INDUSTRIAL**
 - STORE OR SMALL BUSINESS ESTABLISHMENT
 - GROUP OF STORAGE TANKS (OIL OR GAS)
 - GALVING OR PUMPING STATION
 - WAREHOUSE - GENERAL
 - GRAIN ELEVATOR
 - STOCK YARD - LOADING PEN OR CORRAL
 - GRAVEL PIT
 - AIRPORTS**
 - LANDING AREA OR STRIP
 - AIRWAY LIGHT BEACON, GENERAL
 - MISCELLANEOUS**
 - TRIANGULATION STATION
 - DOT TO INDICATE LOCATION OF ANY CULTURAL FEATURE SHOWN OUT OF POSITION
 - ALL VACANT CULTURE INDICATED BY OPEN SYMBOL
 - LATITUDE AND LONGITUDE

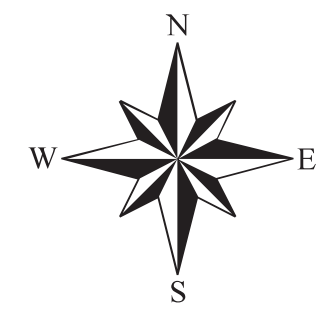

GENERAL HIGHWAY MAP MC INTOSH COUNTY NORTH DAKOTA

PREPARED BY THE
NORTH DAKOTA DEPARTMENT OF TRANSPORTATION
PLANNING / ASSET MANAGEMENT DIVISION
IN COOPERATION WITH THE
U.S. DEPARTMENT OF TRANSPORTATION
FEDERAL HIGHWAY ADMINISTRATION

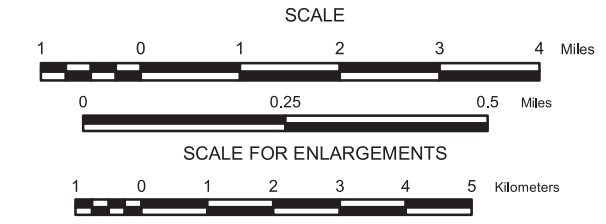

2014

BASED ON AERIAL PHOTOGRAPHY OF 1952
GROUND INVENTORY OF 2014
AERIAL INVENTORY OF 2014
UNIVERSAL TRANSVERSE MERCATOR ZONE 14
NORTH AMERICAN DATUM 83

- NAME AND LOCATION OF ORGANIZED CIVIL TOWNSHIPS THOSE UNORGANIZED ARE SO NOTED**
- | | |
|----------------------------------|----------------------------------|
| T. 132 N. - R. 73 W. UNORGANIZED | T. 130 N. - R. 73 W. UNORGANIZED |
| T. 132 N. - R. 72 W. UNORGANIZED | T. 130 N. - R. 72 W. UNORGANIZED |
| T. 132 N. - R. 71 W. UNORGANIZED | T. 130 N. - R. 71 W. UNORGANIZED |
| T. 132 N. - R. 70 W. UNORGANIZED | T. 130 N. - R. 70 W. UNORGANIZED |
| T. 132 N. - R. 69 W. UNORGANIZED | T. 130 N. - R. 69 W. UNORGANIZED |
| T. 132 N. - R. 68 W. UNORGANIZED | T. 130 N. - R. 68 W. UNORGANIZED |
| T. 132 N. - R. 67 W. ROLOFF | T. 130 N. - R. 67 W. UNORGANIZED |
| T. 131 N. - R. 73 W. UNORGANIZED | T. 129 N. - R. 73 W. UNORGANIZED |
| T. 131 N. - R. 72 W. UNORGANIZED | T. 129 N. - R. 72 W. UNORGANIZED |
| T. 131 N. - R. 71 W. UNORGANIZED | T. 129 N. - R. 71 W. UNORGANIZED |
| T. 131 N. - R. 70 W. UNORGANIZED | T. 129 N. - R. 70 W. UNORGANIZED |
| T. 131 N. - R. 69 W. UNORGANIZED | T. 129 N. - R. 69 W. UNORGANIZED |
| T. 131 N. - R. 68 W. UNORGANIZED | T. 129 N. - R. 68 W. UNORGANIZED |
| T. 131 N. - R. 67 W. UNORGANIZED | T. 129 N. - R. 67 W. UNORGANIZED |

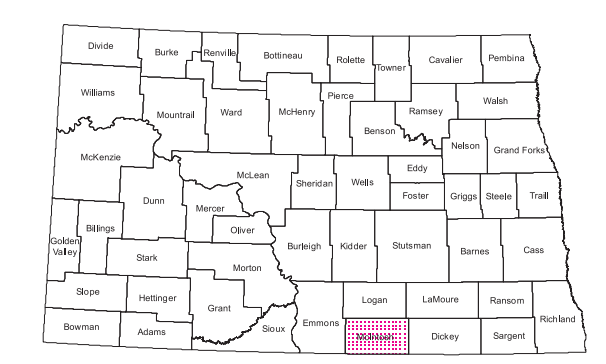
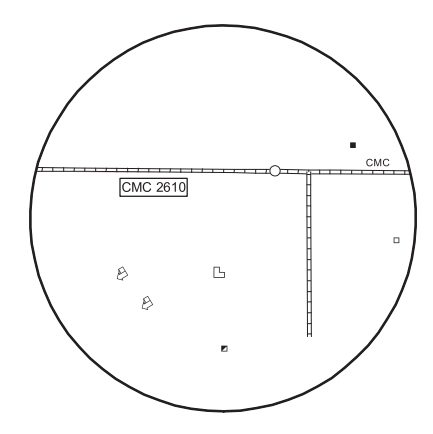
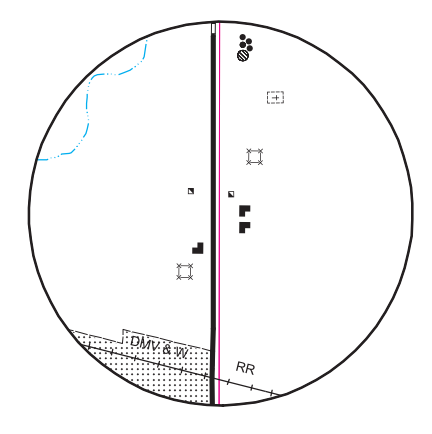
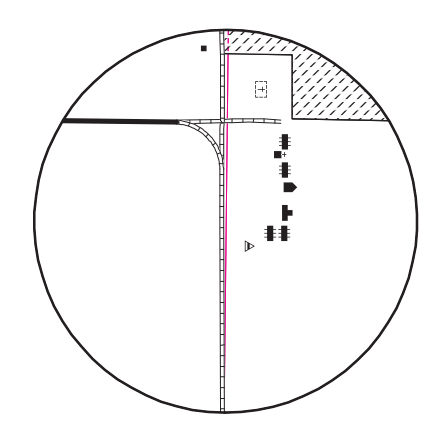

Notice of Disclaimer
The North Dakota Department of Transportation (NDDOT) makes this map available on an "as is" basis as a public service. Under no circumstances does NDDOT warrant or certify the information to be free of errors or deficiencies of any kind. NDDOT specifically disclaims all warranties, express or implied, including but not limited to the warranties of merchantability and fitness for a particular purpose.