

NAME AND LOCATION OF ORGANIZED CIVIL TOWNSHIPS THOSE UNORGANIZED ARE SO NOTED

- T. 137 N.-R. 90 W. UNORGANIZED
- T. 137 N.-R. 89 W. UNORGANIZED
- T. 137 N.-R. 88 W. UNORGANIZED
- T. 136 N.-R. 90 W. UNORGANIZED
- T. 136 N.-R. 89 W. UNORGANIZED
- T. 136 N.-R. 88 W. UNORGANIZED
- T. 136 N.-R. 87 W. UNORGANIZED
- T. 136 N.-R. 86 W. UNORGANIZED
- T. 136 N.-R. 85 W. UNORGANIZED
- T. 135 N.-R. 90 W. UNORGANIZED
- T. 135 N.-R. 89 W. LEIPZIG
- T. 135 N.-R. 88 W. BUCKSKIN
- T. 135 N.-R. 87 W. UNORGANIZED
- T. 135 N.-R. 86 W. UNORGANIZED
- T. 135 N.-R. 85 W. OTTER CREEK
- T. 134 N.-R. 90 W. UNORGANIZED
- T. 134 N.-R. 89 W. MINNIE
- T. 134 N.-R. 88 W. ELM
- T. 134 N.-R. 87 W. UNORGANIZED
- T. 134 N.-R. 86 W. UNORGANIZED
- T. 134 N.-R. 85 W. LARK
- T. 133 N.-R. 90 W. UNORGANIZED
- T. 133 N.-R. 89 W. UNORGANIZED
- T. 133 N.-R. 88 W. ROCK
- T. 133 N.-R. 87 W. UNORGANIZED
- T. 133 N.-R. 86 W. UNORGANIZED
- T. 133 N.-R. 85 W. RALEIGH
- T. 133 N.-R. 84 W. UNORGANIZED
- T. 133 N.-R. 83 W. FREDA
- T. 132 N.-R. 90 W. UNORGANIZED
- T. 132 N.-R. 89 W. UNORGANIZED
- T. 132 N.-R. 88 W. FISHER
- T. 132 N.-R. 87 W. UNORGANIZED
- T. 132 N.-R. 86 W. UNORGANIZED
- T. 132 N.-R. 85 W. UNORGANIZED
- T. 132 N.-R. 84 W. UNORGANIZED
- T. 132 N.-R. 83 W. UNORGANIZED
- T. 131 N.-R. 90 W. UNORGANIZED
- T. 131 N.-R. 89 W. PRETTY ROCK
- T. 131 N.-R. 88 W. UNORGANIZED
- T. 131 N.-R. 87 W. SCHULTZ
- T. 131 N.-R. 86 W. UNORGANIZED
- T. 131 N.-R. 85 W. UNORGANIZED
- T. 130 N.-R. 88 W. UNORGANIZED
- T. 130 N.-R. 87 W. WINONA
- T. 130 N.-R. 86 W. UNORGANIZED
- T. 130 N.-R. 85 W. UNORGANIZED
- T. 129 N.-R. 89 W. UNORGANIZED
- T. 129 N.-R. 88 W. UNORGANIZED
- T. 129 N.-R. 87 W. UNORGANIZED
- T. 129 N.-R. 86 W. UNORGANIZED

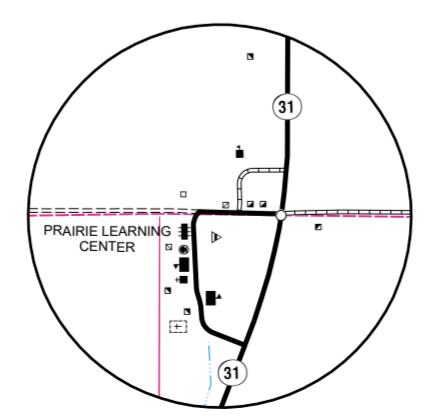

ST. GERTRUDE

SECS. 4 & 5 T. 132 N., R. 85 W.
SEC. 35, T. 133 N., R. 85 W.

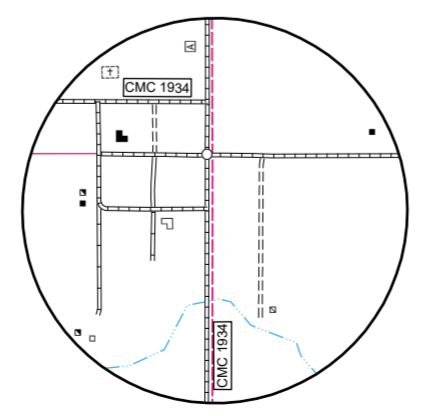

SHIELDS

SECS. 19 & 30 T. 132 N., R. 83 W.
SECS. 24 & 25, T. 132 N., R. 84 W.

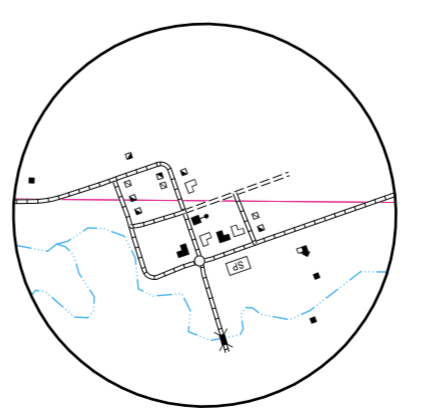

RALEIGH

SECS. 1 & 12 T. 133 N., R. 85 W.

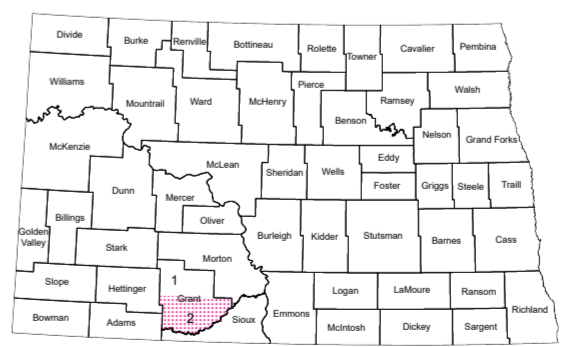

STATE OF NORTH DAKOTA
DIAGRAM OF COUNTIES

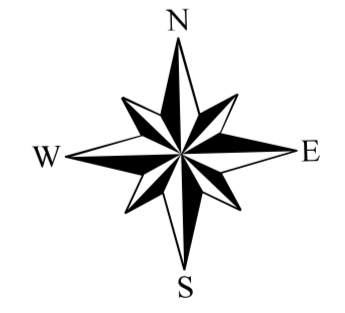

GRANT COUNTY



2020

BASED ON AERIAL PHOTOGRAPHY OF 1954
GROUND INVENTORY OF 2011
AERIAL INVENTORY OF 2020

UNIVERSAL TRANSVERSE MERCATOR ZONE 14
NORTH AMERICAN DATUM 83

Notice of Disclaimer
The North Dakota Department of Transportation (NDDOT) makes this map available on an "as is" basis as a public service. Under no circumstances does NDDOT warrant or certify the information to be free of errors or deficiencies of any kind. NDDOT specifically disclaims all warranties, express or implied, including but not limited to the warranties of merchantability and fitness for a particular purpose.