

INSET NO. 1
SECS. 27 & 28, T. 145 N., R. 94 W.

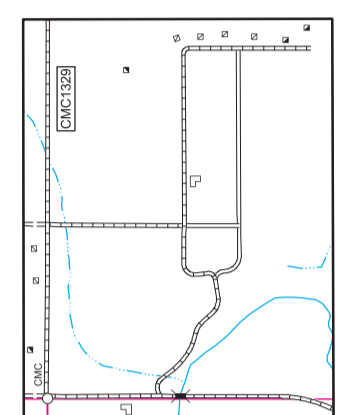

WERNER
SEC. 19, T. 145 N., R. 92 W.

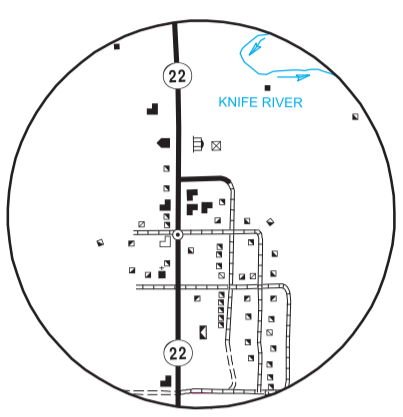

MANNING
SEC. 6, T. 143 N., R. 95 W.

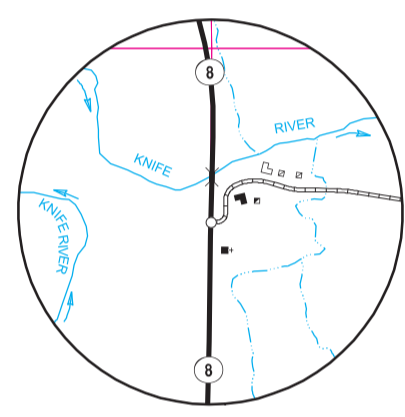

MARSHALL
SECS. 3, 4, 9, & 10, T. 142 N., R. 92 W.

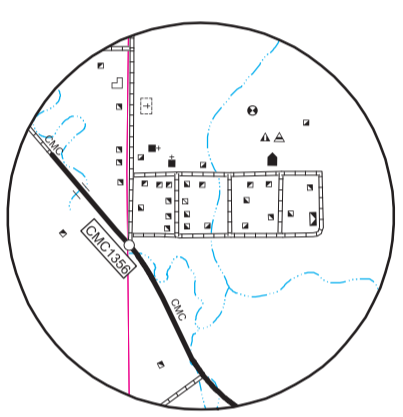

NEW HRADEC
SECS. 29, & 30, T. 141 N., R. 96 W.

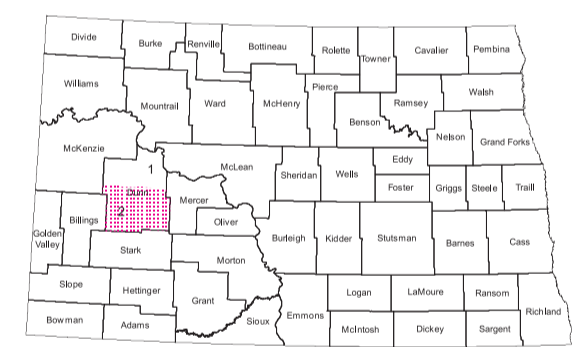

STATE OF NORTH DAKOTA
DIAGRAM OF COUNTIES

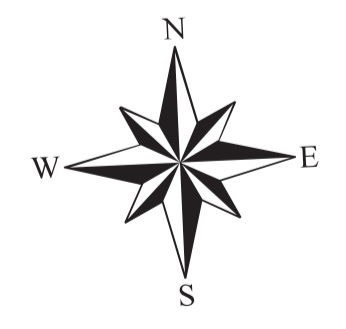

DUNN COUNTY

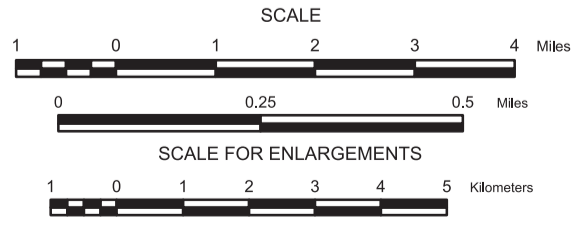

2013

Notice of Disclaimer
The North Dakota Department of Transportation (NDDOT) makes this map available on an "as is" basis as a public service. Under no circumstances does NDDOT warrant or certify the information to be free of errors or deficiencies of any kind. NDDOT specifically disclaims all warranties, express or implied, including but not limited to the warranties of merchantability and fitness for a particular purpose.

BASED ON AERIAL PHOTOGRAPHY OF 1958
GROUND INVENTORY OF 2013
AERIAL INVENTORY OF 2013
UNIVERSAL TRANSVERSE MERCATOR ZONE 14
NORTH AMERICAN DATUM 83